

FITTING INSTRUCTIONS

DN560/DN561 - Sliding Window Mortice Lock

- Supplied in kit:
 1. DN560/DN561 Lock Unit x 1
 2. Striker x 1
 3. Striker Packer 5mm x 2
 4. Dress Plate x 1
 5. 8G x 1/2" screws x 4

- Tools required:
 - PH2 Drill Bit & Drill
 - Ball Head Allen Key to suit M6 profile (Type 5)

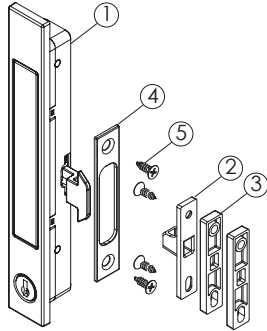

Product Assembly

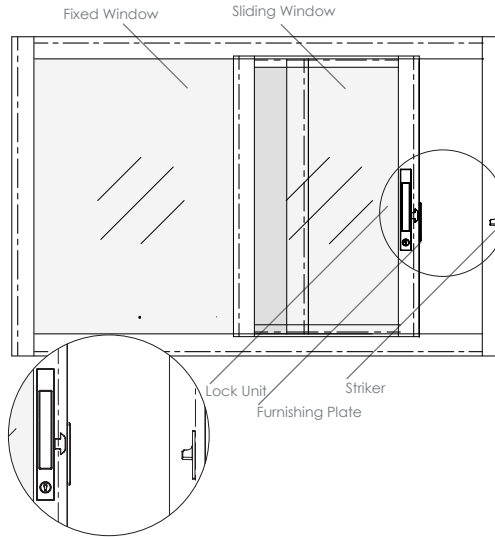

Machining Detail

Sliding Stile

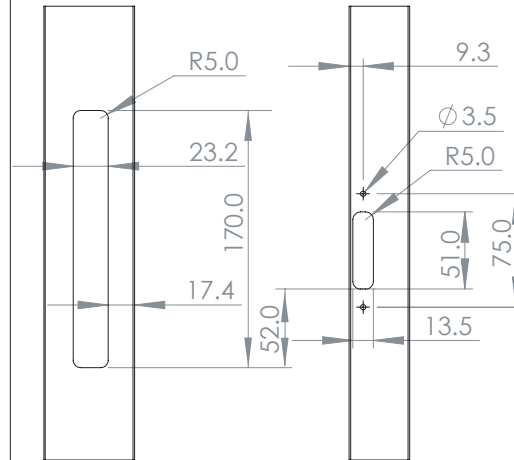

Meeting Stile

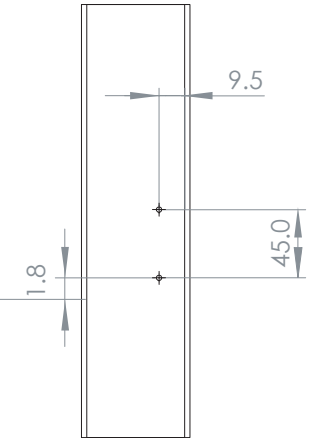

1

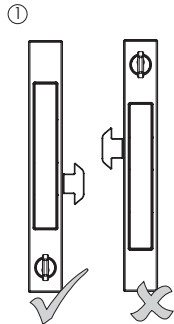

1) Ensure the lock unit is in the unlocked position. Ensure that the cylinder is on the bottom.

2) Pivot the lockbody and insert the edge with the tongue first.

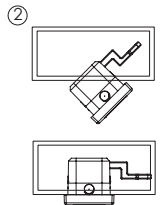

2

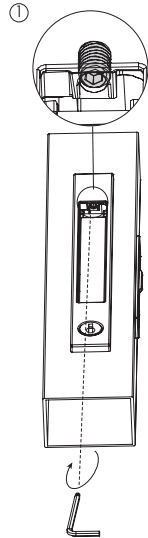

1) Depress the actuator. This will provide access to the fixing grub screw.

2) Using the ball head allen key (not supplied), secure the lockbody to the extrusion by turning the grub screw clockwise.

3

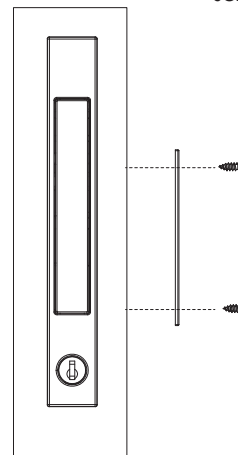

1) Fix the dress plate to the extrusion with 2 x 8G screws (supplied).

4

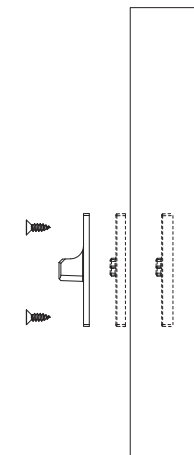

1) Align striker packer/s, if required, with the striker.

2) Fix the striker to the meeting stile with 2 x 8G screws (supplied).

Note: Longer screws may be required.

38 Redfern St
 Wetherill Park NSW 2164
 Australia



Ph: 1300 132 389
 Fax: 1300 652 292
 sales@doric.com.au
 www.doric.com.au

TROUBLE SHOOTING

DN560/DN561 - Sliding Window Mortice Lock

DN560
- Keyed

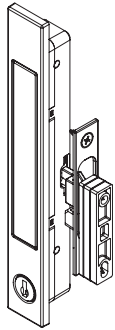

DN561
- Latch

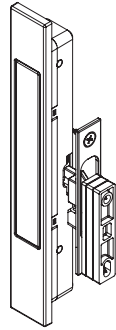

Changing Cylinder

- 1) Turn cylinder (anti clockwise) to the locked position.
- 2) Lift the key until it clicks ONE time.
- 3) Using a thin probe depress the retaining wafer.
- 4) Whilst holding the retaining wafer in push the key back into the bottom position.
- 5) Remove the cylinder

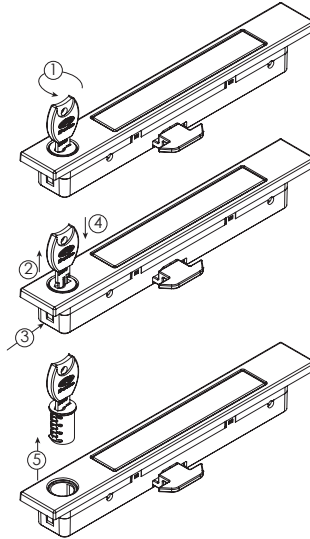

Locking Lockbody

- 1) Turn cylinder key anti clockwise
- 2) Remove the key

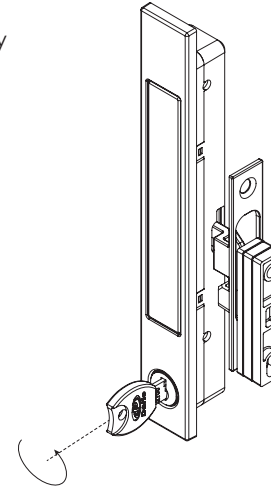

Changing Handing

- 1) Lockbody must be out of the extrusion to change handing.
- 2) Using a ball head allen key (not supplied), turn the grub screw securing the tongue anti clockwise until the screw disengages with the lock bar.
- 3) Insert the tongue and screw in the opposing side and tighten.

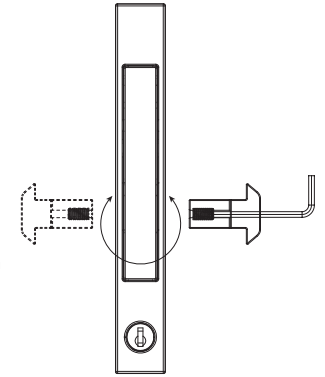

Adjustment Range

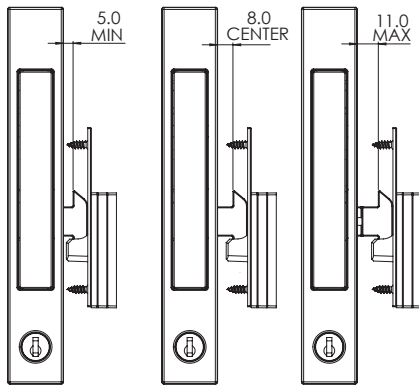

Tongue:
6.0 mm adjustment

Striker:
10.0 mm adjustment
(2 x 5.0 mm Striker Packer)

Adjusting Tongue Position

- 1) Using a ball head allen key (not supplied), turn the grub screw to the desired position.

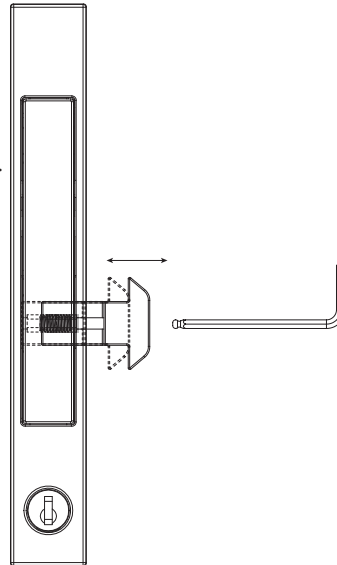

Lock Unit Navigation

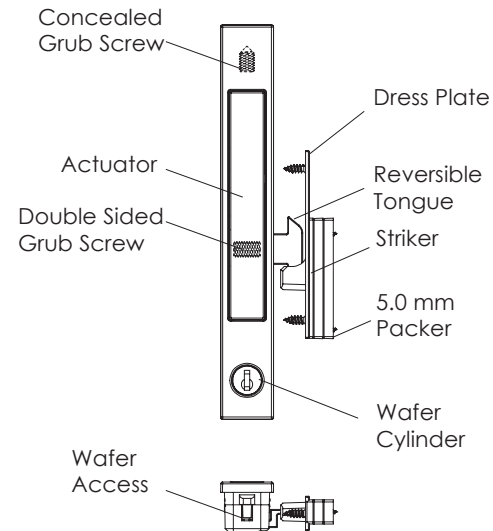

Notes

38 Redfern St
Wetherill Park NSW 2164
Australia



Ph: 1300 132 389
Fax: 1300 652 292
sales@doric.com.au
www.doric.com.au