

DS1250 Packer Installation Instructions

With top packer wheel in its highest position adjust down incrementally (0.5mm each step) to allow for wall thickness.

i.e. 2.0mm wall thickness "4" increments from top position.
3.0mm wall thickness "6" increments from top position.

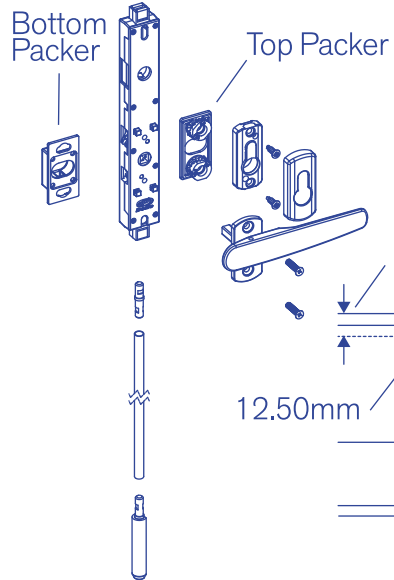
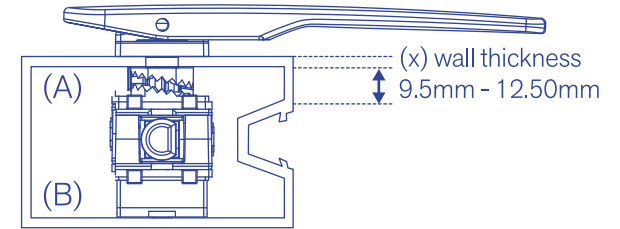

variance in door extrusion wall thickness

12.50mm

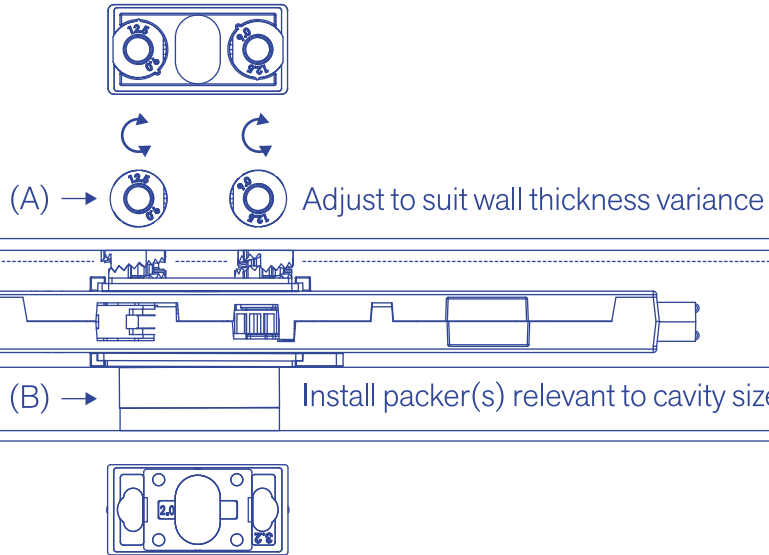

Bottom Packers

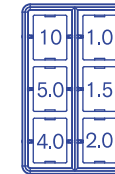

The Top Packer (A) is required to suit the various door extrusion wall thickness. These rotary wheels incorporate incremental adjustment of 0.5mm. Correct adjustment of the wheels result in the cylinder housing being held securely and the screws achieving the correct purchase depth into the lockbody.

The Bottom Packers (B) assist the installation of the mounting screws when securing the screws and lockbody into position. Note: The Bottom Packers can be added together to achieve the correct fit. Example: if 6.5mm required/use both packers 5.0 + 1.5.

