

Brendale sliding security and screen, 3 point lock DS2210



1. Both sides of the door stile must be cut to dimensions given.

Fitting top and bottom locks to rods

2. Connect top and bottom slave locks to the operating rods. Fit rod clips as shown.
3. Feed the top and bottom operating rods fitted with top and bottom slave locks through their respective cutouts. Shorter rod through the top cutout and longer rod through the bottom cut out. Do not fully insert slave locks into cutouts.

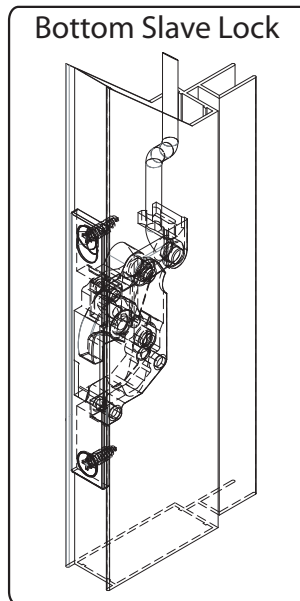
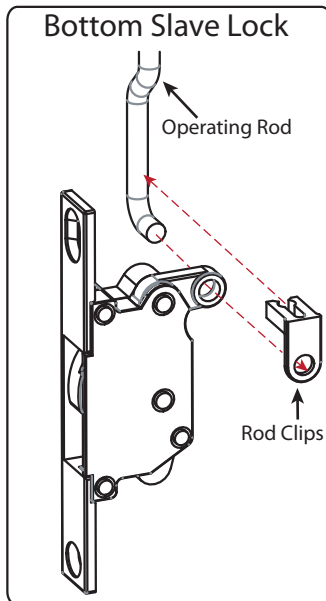
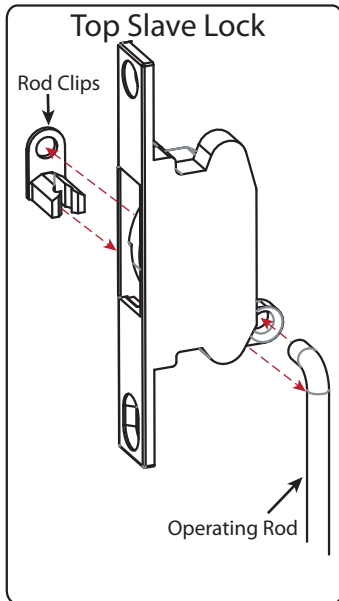

Fitting Centre lock and operating rod

4. Partly insert the centre lock into the centre cutout ensure the lock is in the unlocked position by using a small screw driver to depress the internal locking mechanism in the cylinder hole until rod operators are fully retracted.
5. With the centre lock in an unlocked position (ie rod operators fully retracted),

connect the top rod to the centre lock. Fit rod clips as shown. Connect the bottom rod to the centre lock, fit rod clips as shown.

6. Fully insert centre lock into cut out. Secure centre lock with 2 x 8Gx13mm countersink self tapping screws supplied.

7. Fully insert the slave locks and secure with 2 x 8Gx13mm countersink self tapping screws.

8. Using a small screw driver move the internal locking mechanism in to the locked position. Place the cylinder into the cylinder hole, ensure the cylinder cam is rotating out towards the door jamb check the locked and unlocked positions of main lock and slave locks.

9. Fit the strike plate into the centre lock and the top and bottom slave locks. Close the door until the strike plate reaches the receiving channel. Mark the position of the strike plate with the 2x 8Gx 23mm screws. Place the screws in the centre of the slots to allow for adjustment.

10. Test that the strike plate engages the lock correctly and adjust if necessary.

