

# Machining Details to suit Surface Mounted Patio Door Lock Fitting

## Patio Door Locks with spigotted base and Ds4000 Adjustable Strike

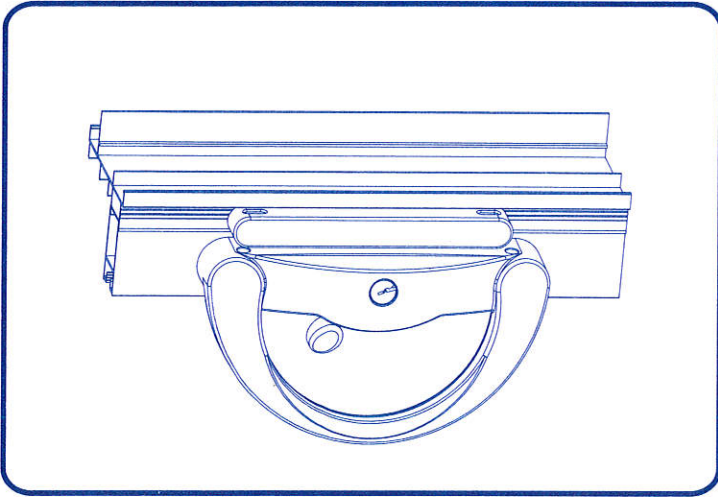
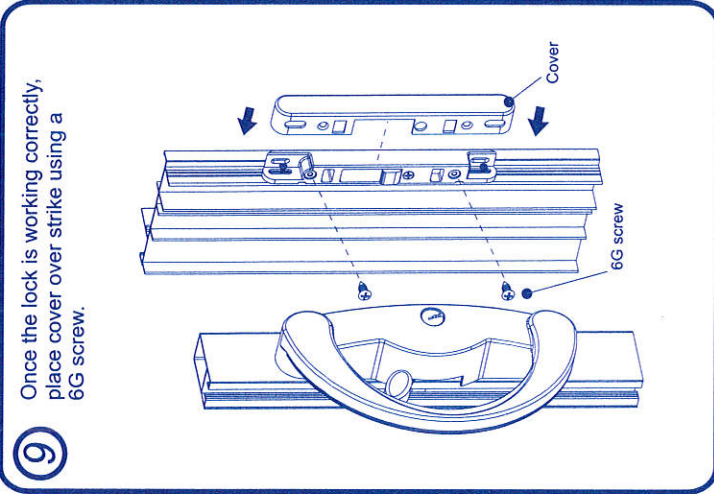
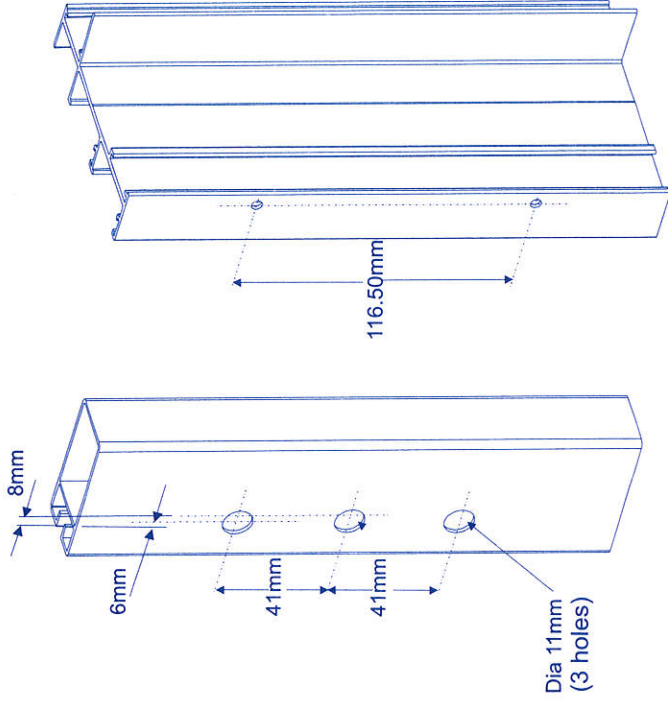

## Surface Mounted Patio Door Lock Fitting

NOTE: Warranty is void if these instructions are not adhered to.

### Instructions

1 Assemble external cylinder in exterior pull. This lock uses wafer or pin cylinders.

Wafer cylinder

Pin Cylinder  
Insert cylinder into shroud then push cylinder stop into place.

\*Cylinder stop  
Shroud  
Cylinder tail

**\*IMPORTANT: Cylinder stop MUST be used.**

2

External handle  
External Cylinder  
Lock stile

Place the external handle & cylinder on the door stile so that the cylinder tail protrudes through centre hole.

5mm min - 8mm max cylinder tail projection.  
Cylinder tail  
Extrusion

2A



www.doric.com.au

HEAD OFFICE  
38 Redfern St  
Wetherill Park 2164  
NSW Australia

Australia  
1300 132 389

New Zealand  
+64 (9) 415 5535

Asia Pacific  
+60 (3) 7845 5017



3

Place lock on inside of stile, aligning the centre holes for exterior cylinder tail to locate into interior cam. Fasten with 2 x M5 screws.  
NOTE: Tongue faces the door jamb.

4

Ensure, using external cylinder, that lever operates smoothly.  
NOTE: If the lock is tight or grinding, unassemble lock from extrusion & trim cylinder tail slightly.

5

To use a DS4000 strike with the surface mounted lock, the jamb will need to be drilled to the size shown below. There are two types of fixings for this strike:

- Standard fixing
- Insert fixing

Details of these fixings are shown in 'A' & 'B'.

A1

5a

**Standard Fixing**

Using the machining details, machine holes for strike on jamb. For standard fixing, the holes must be Dia. 3.5mm. Screw in place with 2 x 8G screws, but do not tighten. Close door & lock tongues into strike (A1). This will locate the strike in the correct Position on jamb. Tighten screws.

5b

**Insert Fixing**

Drill fixing holes to Dia. 6.0mm. Cross fasten with 2 x M4 fixing screws using 2 x Lock nuts. Locate strike in correct position on jamb in relation to the lock tongue. Tighten screws.

6

Place internal cylinder inside interior of handle

7

Fasten cover on internal lock with 2 x M5 CSK screws.

8

Once strike is on the door jamb and lock is fully assembled, test to see if tongue engage the strike. If tongue does not engage, adjust the vertical and horizontal adjustments. Keep the strike and lock parallel.

Unlocked position

Locked position

\* Interior Covers Available

NB: Once every month, clean internal and external covers with soap and water being sure to remove any corrosive chemicals