

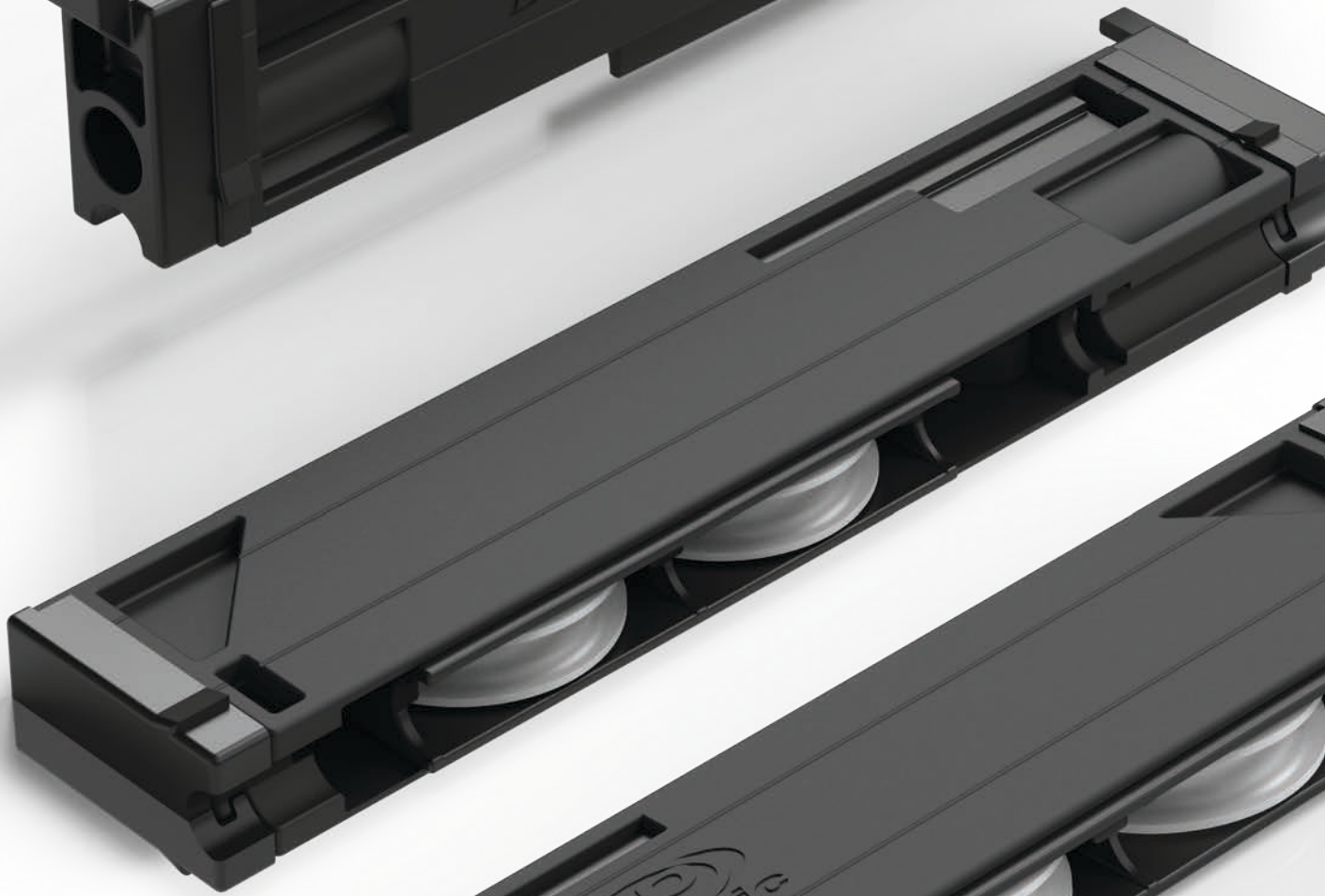

ROLLERS | DOOR & WINDOW HARDWARE



ROLLERS DOOR & WINDOW HARDWARE



ROLLER & WHEEL GUIDE	4
ROLLER & CARRIAGES	
ROLLERS Sliding Windows	6
ROLLERS Sliding Doors	12
ROLLERS Heavy Duty	21
ROLLERS Security, Barrier & Screen Door	30
ROLLERS Wardrobe	34
WHEELS & TYRE	35
INDEX	46

WHAT IS A ROLLER?

A roller is generally identified as a wheel which performs a rolling activity. Rollers come in various shapes and sizes and may be used as a stand-alone component or as part of an assembled unit, often referred to as a carriage or a hanger.



WHAT IS A CARRIAGE?

A carriage is an assembly containing a wheel, or multiple wheels, used at the bottom of a sliding window or door. Carriages are usually designed such that they fit into specific extrusions or cut-outs in timber and roll on a bottom track.



WHAT IS A HANGER?

A hanger is an assembly containing a wheel, or multiple wheels, used at the top of a sliding window or door. Hangers usually fit onto the face, edge or top of doors which hang from a track.



Both carriages and hangers often (but not always) contain a height adjustment mechanism.

Associated parts for rollers, carriages and hangers can include the following:

1 - HOUSING

A housing is generally the carriage without the wheel.

2 - BRACKET

A bracket is generally the hanger without the wheel.

3 - AXLES

A centre shaft or spindle on which the wheel revolves.

4 - SCREWS

The fastener for wheels to hangers as well as for adjustment mechanisms and fixing hardware in place.

5 - PACKERS

An add-on component used for creating, filling or maintaining a space between two items - such as a carriage inside an extrusion.

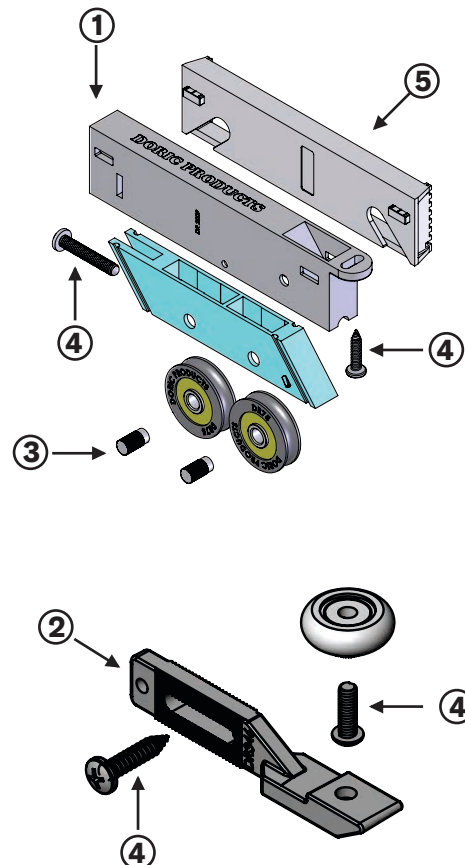

Wheels and rollers can come in a variety of shapes and sizes.

WHEEL PROFILE EXAMPLES

Wheels, Rollers and Sheaves will generally contain one of these profiles

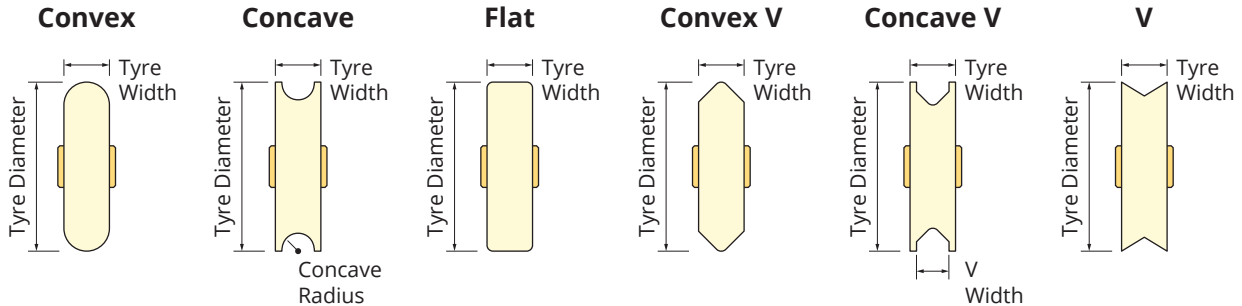

WHEEL WITH AXLE & NUT

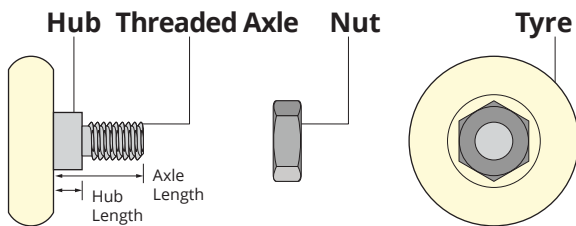

Some units may also contain a washer(s)

Wheels with axle and nut are generally used on hangers and fix through a hole in a bracket. The nut screws over a threaded axle protruding from the wheel hub.

WHEEL WITH BORE

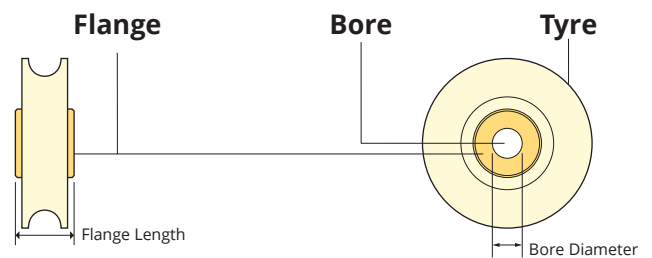

Wheels with bore (or hole) are generally used in carriages and fitted to housings via a rivet, a pin, a pressed axle or even a removable axle.

WHEEL WITH AXLE SCREW

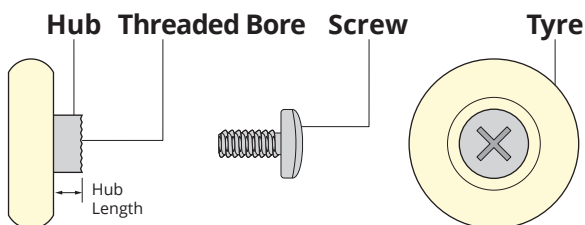

Some units may also contain a washer(s)

Wheels with axle screw are generally used on hangers and fix through a hole in a bracket. The screw tightens into a threaded bore within the wheel hub.

WHEEL WITH FIXED AXLE

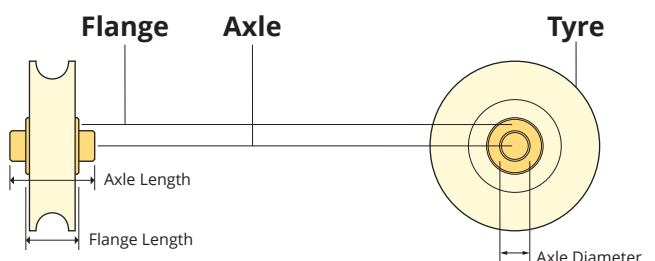

Wheels with fixed axles are generally used in carriages and fitted to housings via a clip-in axle slot.



ROLLERS & CARRIAGES DOOR & WINDOW HARDWARE



ROLLERS | SLIDING WINDOW

DR142 | MARINE GRADE ALUMINIUM ADJUSTABLE WINDOW ROLLER

CARRIAGE	Marine Grade Aluminium
ADJUSTMENT	6mm ($X = 25\text{mm} - 31\text{mm}$)

ROLLER	WHEEL	WEIGHT RATING	ORDER CODE
Standard	DR3	15kg max load	9004570

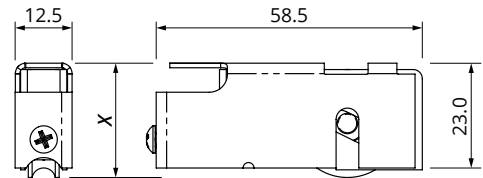

DR215 | SLIDING WINDOW CARRIAGE

CARRIAGE	Engineered Plastic
-----------------	--------------------

ROLLER	WHEEL	WEIGHT RATING	ORDER CODE
Standard	DR11	10kg max load	9002031
Optional	DR13	10kg max load	9004346
Optional	DR52	10kg max load	9008720
Carriage Only			9002030

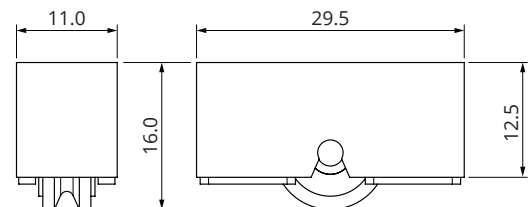

DR216 | SLIDING WINDOW GUIDE

CARRIAGE	Engineered Plastic
-----------------	--------------------

ROLLER	WHEEL	WEIGHT RATING	ORDER CODE
Standard	DR11	10kg max load	9002035
Optional	DR52	10kg max load	9008166
Optional	DR56	10kg max load	9008210

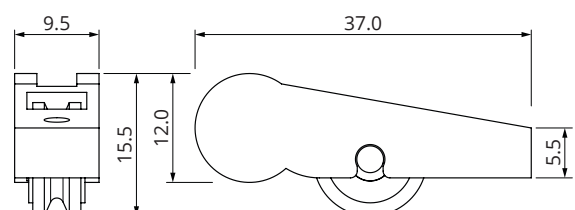

ROLLERS | SLIDING WINDOW

DR218 | SLIDING WINDOW GUIDE

CARRIAGE	Engineered Plastic
ORDER CODE	9002042

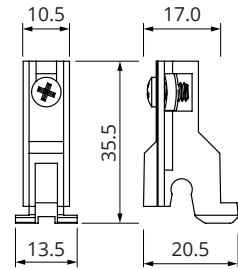

DR222 | ADJUSTABLE SLIDING WINDOW CARRIAGE

CARRIAGE	Engineered Plastic
-----------------	--------------------

ROLLER	WHEEL	WEIGHT RATING	ORDER CODE
Standard	DR11	10kg max load	9002072
Carriage Only			9002071

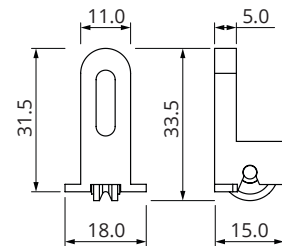

DR226 | A & B SLIDING WINDOW CARRIAGE

CARRIAGE	Engineered Plastic
-----------------	--------------------

ROLLER	WHEEL	WEIGHT RATING	ORDER CODE
Standard	DR13	Pair	9003369
Optional	DR13 - A	10kg max load	A-9002087
Optional	DR13 - B	10kg max load	B-9004282
Carriage A			A-9002086
Carriage B			B-9004281

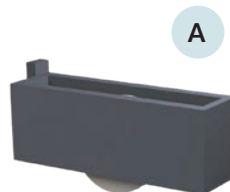

A

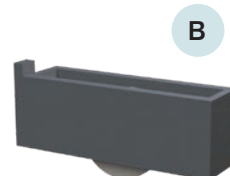
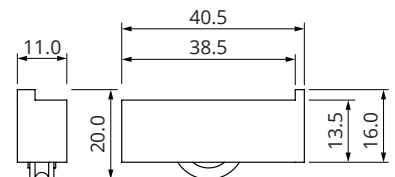

B

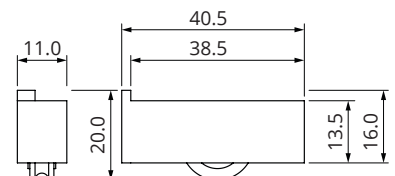

ROLLERS | SLIDING WINDOW

DR231 | SLIDING WINDOW CARRIAGE

CARRIAGE	Aluminium Extrusion
----------	---------------------

ROLLER	WHEEL	WEIGHT RATING	ORDER CODE
Standard	DR3	15kg max load	9002101
Carriage Only			9006101

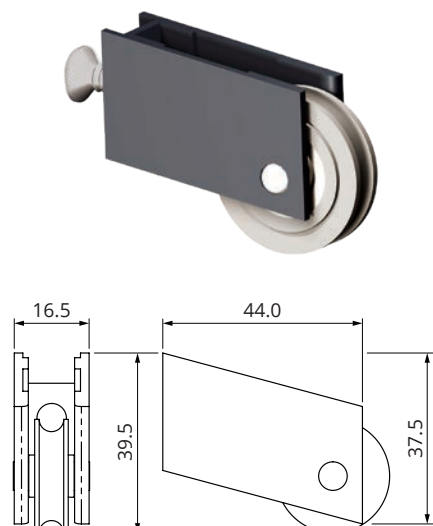

DR232 | ADJUSTABLE SLIDING WINDOW CARRIAGE

CARRIAGE	Engineered Plastic
ADJUSTMENT	2.5mm (X= 16.5mm - 19mm)

ROLLER	WHEEL	WEIGHT RATING	ORDER CODE
Standard	DR13	10kg max load	9002103
Optional	DR9	10kg max load	9002104
Optional	DR52	12kg max load	9003712
Carriage Only			9002102

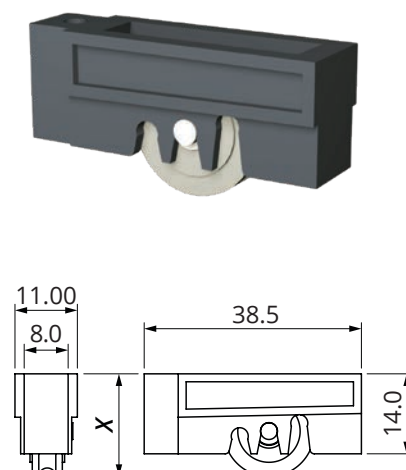

DR239 | SLIDING WINDOW CARRIAGE

CARRIAGE	Engineered Plastic
----------	--------------------

ROLLER	WHEEL	WEIGHT RATING	ORDER CODE
Standard	DR32	12kg max load	9002120
Carriage Only (See DR218)			

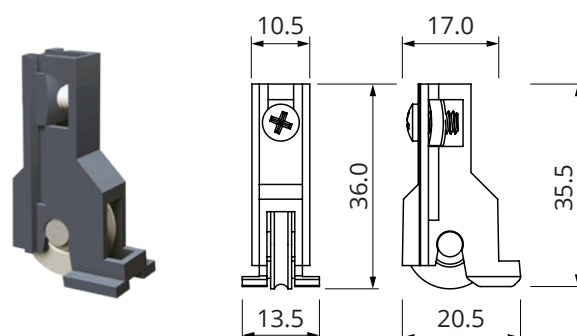

ROLLERS | SLIDING WINDOW

DR249 | ADJUSTABLE SLIDING WINDOW CARRIAGE

CARRIAGE	Engineered Plastic
ADJUSTMENT	1.5mm ($X = 22\text{mm} - 23.5\text{mm}$)

ROLLER	WHEEL	WEIGHT RATING	ORDER CODE
Standard	DR13	10kg max load	9009080
Optional	DR9	10kg max load	9009081
Optional	DR58	10kg max load	9015808
Carriage Only			9008729

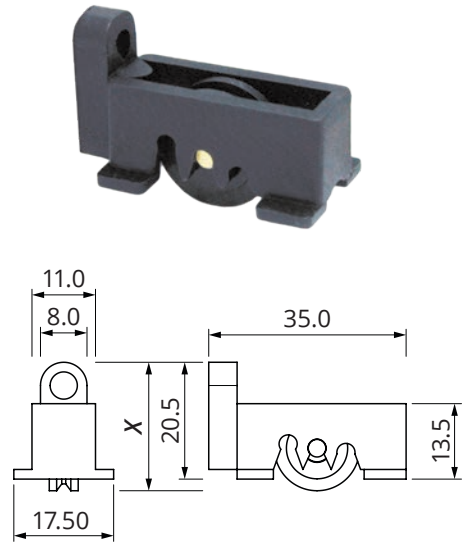

DR343 | SLIDING WINDOW CARRIAGE

CARRIAGE	Engineered Plastic
-----------------	--------------------

ROLLER	WHEEL	WEIGHT RATING	ORDER CODE
Standard	DR27	10kg max load	9002152

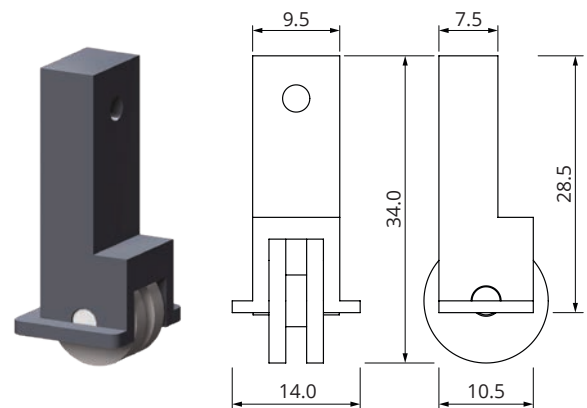

DR347 | SLIDING WINDOW CARRIAGE

CARRIAGE	Engineered Plastic
-----------------	--------------------

ROLLER	WHEEL	WEIGHT RATING	ORDER CODE
Standard	DR18	10kg max load	9002173
Carriage Only			9002172

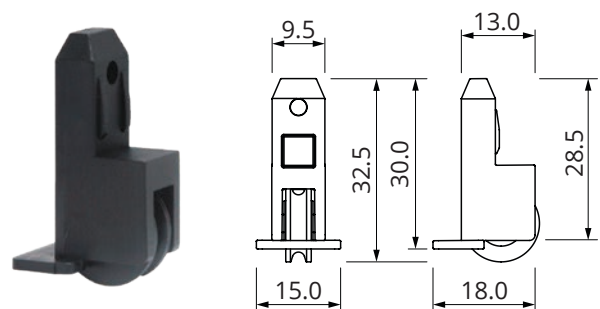

ROLLERS | SLIDING WINDOW

DR354 | SLIDING WINDOW CARRIAGE

CARRIAGE	Engineered Plastic
ADJUSTMENT	1mm ($X = 15.5\text{mm} - 16.5\text{mm}$)

ROLLER	WHEEL	WEIGHT RATING	ORDER CODE
Standard	DR13	10kg max load	9002204
Optional	DR9	10kg max load	9002205
Optional	DR11	10kg max load	9008814
Optional	DR52	10kg max load	9010532
Carriage Only			9002203

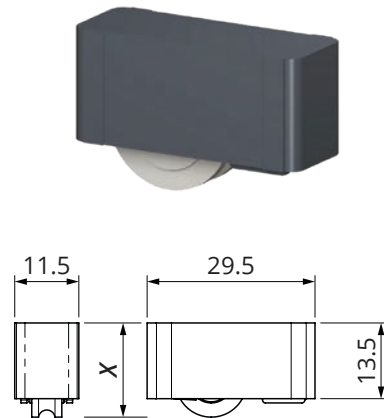

DR371 | SLIDING WINDOW CARRIAGE

CARRIAGE		Engineered Plastic	
ROLLER	WHEEL	WEIGHT RATING	ORDER CODE
Standard	DR11	10kg max load	9002250
Carriage Only			9002249

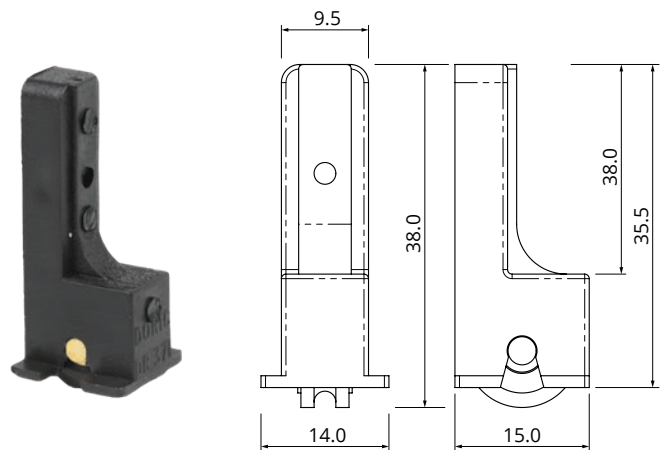

DR374 | SLIDING WINDOW TOP GUIDE

CARRIAGE	Engineered Plastic
ORDER CODE	9002524

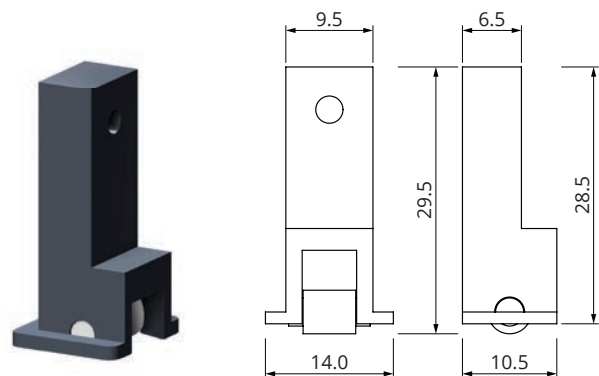

ROLLERS | SLIDING WINDOW

DR405 | ADJUSTABLE SELF ALIGNING SLIDING WINDOW ROLLER

CARRIAGE	Engineered Plastic
ADJUSTMENT	5.5mm ($X = 24.5\text{mm} - 30\text{mm}$)

ROLLER	WHEEL	WEIGHT RATING	ORDER CODE
Standard	DR63	15kg max load	9047530

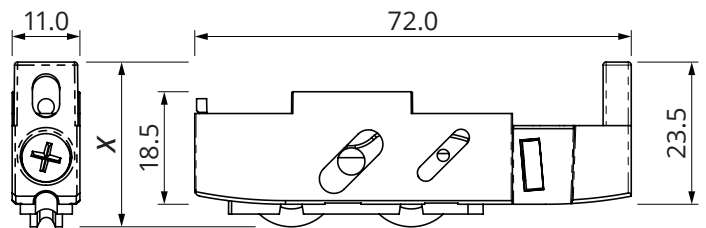

ROLLERS | OUTDOOR

DR137 | HEAVY DUTY CARRIAGE WITH GUIDE

CARRIAGE	Cast Brass
----------	------------

ROLLER	WHEEL	WEIGHT RATING	ORDER CODE
Standard	DR7	50kg max load	9001882

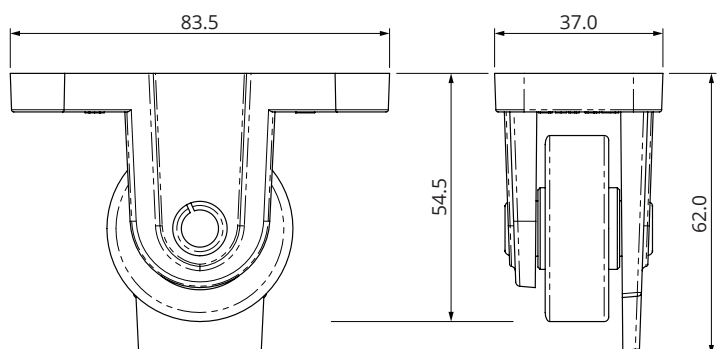

ROLLERS | SLIDING DOOR

DF202 | ROLLER (MTO)

CARRIAGE	Aluminium
NOTES	Not stocked, Made To Order

ROLLER	WHEEL	WEIGHT RATING	ORDER CODE
Standard	DR1	20kg max load	Contact Us

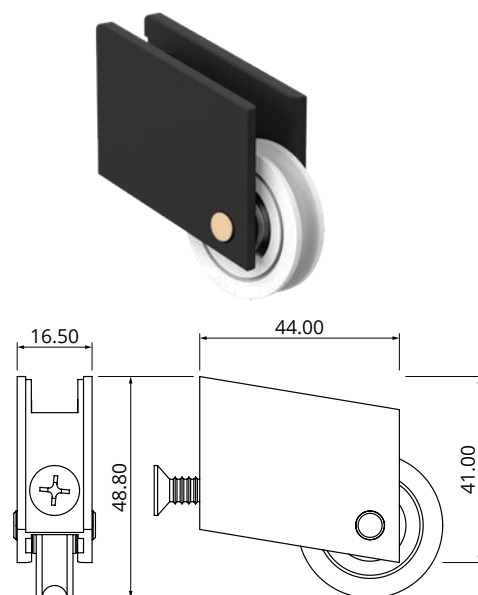

DR141 | ADJUSTABLE DOOR CARRIAGE

CARRIAGE	Aluminium
FLARES *	17.5mm
ADJUSTMENT	10mm ($X = 35\text{mm} - 45\text{mm}$)

ROLLER	WHEEL	WEIGHT RATING	ORDER CODE
Standard	DR26	20kg max load	9001892

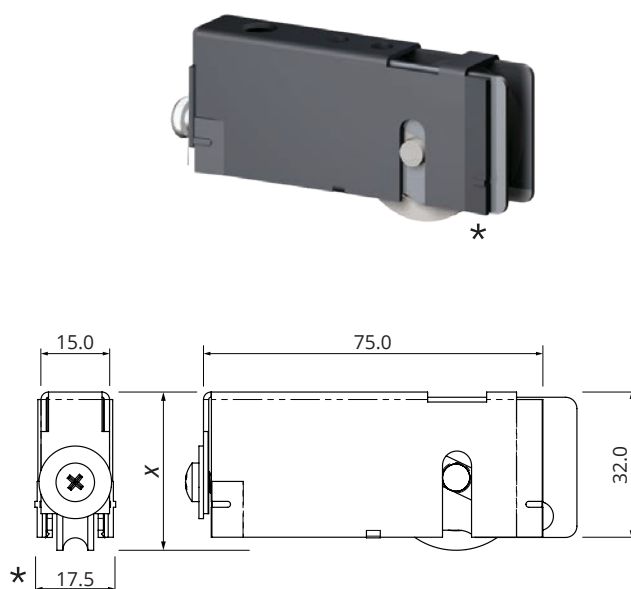

DR201 | ADJUSTABLE DOOR CARRIAGE

CARRIAGE	Engineered Plastic
ADJUSTMENT	3mm ($X = 40\text{mm} - 43\text{mm}$)

ROLLER	WHEEL	WEIGHT RATING	ORDER CODE
Standard	DR2	20kg max load	9001897
Optional	DR4	20kg max load	9001898
Optional	DR36	20kg max load	9003817
Carriage Only			9001896

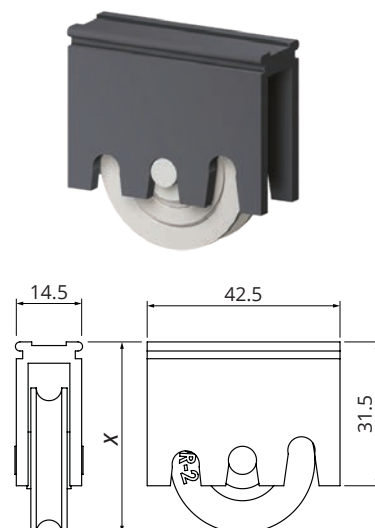

ROLLERS | SLIDING DOOR

DR202 | ADJUSTABLE DOOR CARRIAGE

CARRIAGE	Engineered Plastic
-----------------	--------------------

ROLLER	WHEEL	WEIGHT RATING	ORDER CODE
Standard	DR1	20kg max load	9000579
Carriage Only			9004841

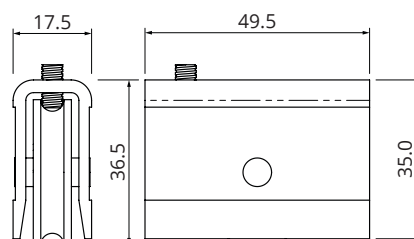

DR206 | ADJUSTABLE DOOR CARRIAGE

CARRIAGE	Plated Steel
FLARES	* 21mm wide
FIXING	1/4" BSW Threaded fixing hole <i>Screw not supplied</i>

ROLLER	WHEEL	WEIGHT RATING	ORDER CODE
Standard	DR1/R6	20kg max load	9001993
Optional	DR5	40kg max load	9001994

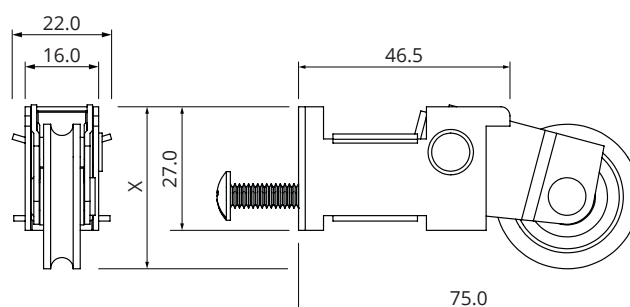
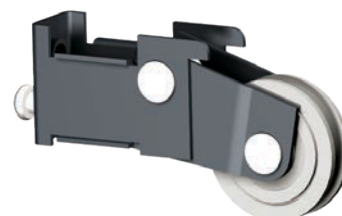

DR208 | DOOR CARRIAGE

CARRIAGE	Engineered Plastic
-----------------	--------------------

ROLLER	WHEEL	WEIGHT RATING	ORDER CODE
Standard	DR25	15kg max load	9002008

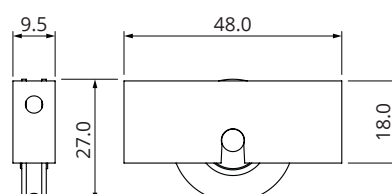
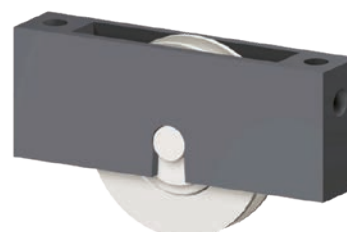

ROLLERS | SLIDING DOOR

DR209 | ADJUSTABLE DOOR CARRIAGE

CARRIAGE	Plated Steel
ADJUSTMENT	12.5mm ($X = 32mm - 44.5mm$)

ROLLER	WHEEL	WEIGHT RATING	ORDER CODE
Standard	DR2	20kg max load	9002011
Standard	DR4	40kg max load	9002012
Optional	DR60	25kg max load	9009883

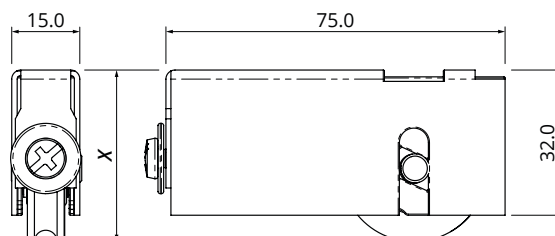

DR210 | MARINE GRADE ALUMINIUM ADJUSTABLE DOOR CARRIAGE

CARRIAGE	Heavy Duty Aluminium (Marine Grade)
ADJUSTMENT	9mm ($X = 34mm - 43mm$)

ROLLER	WHEEL	WEIGHT RATING	ORDER CODE
Standard	DR2	20kg max load	9002014
Optional	DR4	40kg max load	9002015

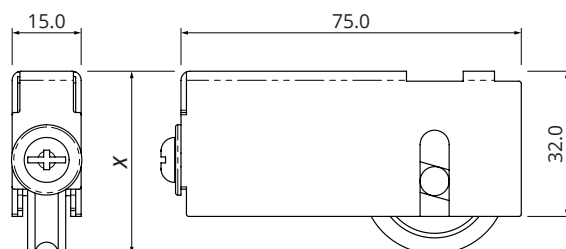

DR211 | ADJUSTABLE DOOR CARRIAGE

CARRIAGE	Plated Steel
FLARE	17.5mm wide
ADJUSTMENT	11.5mm ($X = 32mm - 43.5mm$)

ROLLER	WHEEL	WEIGHT RATING	ORDER CODE
Standard	DR2	20kg max load	9002017
Optional	DR4	40kg max load	9002018

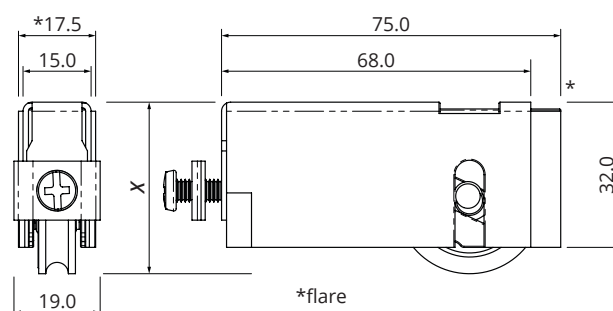

ROLLERS | SLIDING DOOR

DR221 | DOOR CARRIAGE

CARRIAGE	Aluminium Extrusion
----------	---------------------

ROLLER	WHEEL	WEIGHT RATING	ORDER CODE
Standard	DR1	20kg max load	9002068
Optional	DR5	40kg max load	9002069

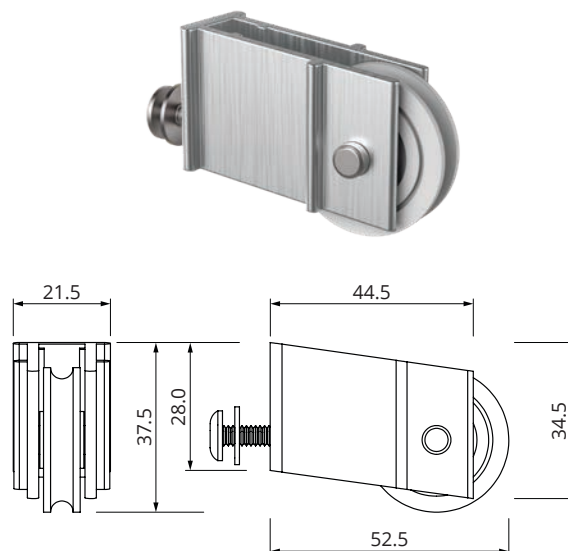

DR230 | HEAVY DUTY DUAL ADJUSTABLE DOOR CARRIAGE

CARRIAGE	Stainless Steel Carriage, Engineered Plastic Inner
----------	--

ROLLER	WHEEL	WEIGHT RATING	ORDER CODE
Standard	DR2	40kg max load	9002100
Optional	DR4	80kg max load	9002099

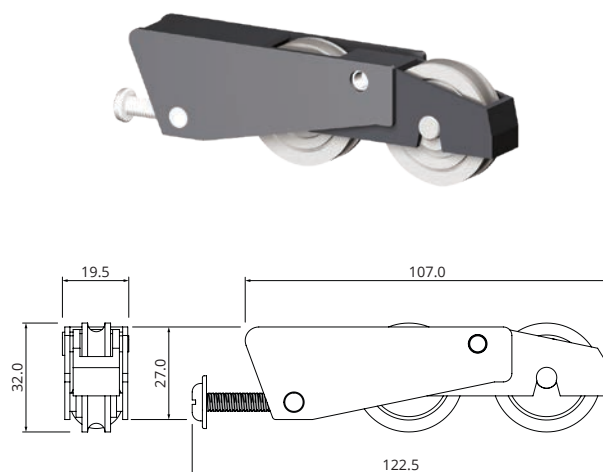

DR240 | ADJUSTABLE DOOR CARRIAGE

CARRIAGE	Engineered Plastic
ADJUSTMENT	6.5mm (X= 24.5mm - 31mm)

ROLLER	WHEEL	WEIGHT RATING	ORDER CODE
Standard	DR34	20kg max load	9002121
Carriage Only			9007176

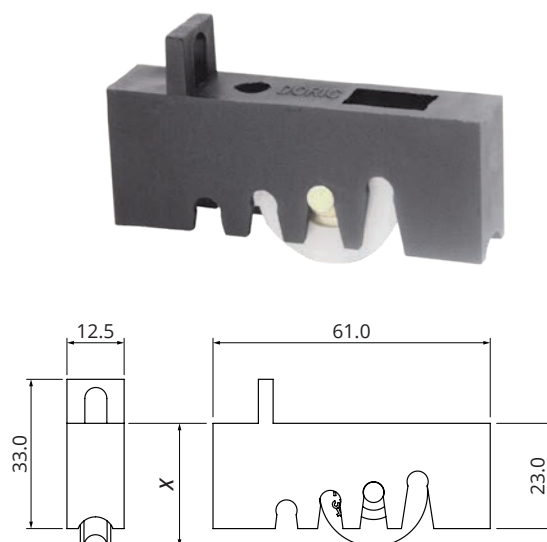

ROLLERS | SLIDING DOOR

DR244 | ADJUSTABLE DOOR CARRIAGE

CARRIAGE	Engineered Plastic
ADJUSTMENT	6mm ($X = 69.5\text{mm} - 73.5\text{mm}$)

ROLLER	WHEEL	WEIGHT RATING	ORDER CODE
Standard	DR2/spring loaded	20kg max load	9006488
Optional	DR2/non-spring loaded	20kg max load	9003641

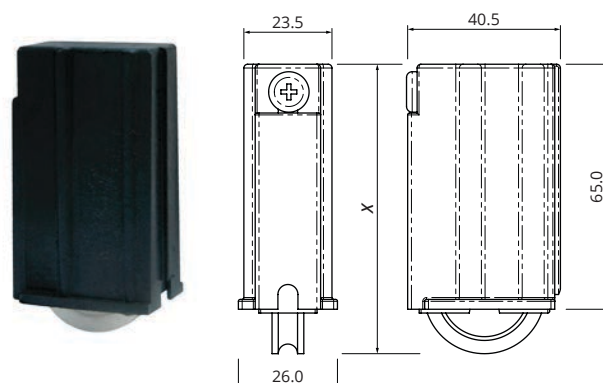

DR245 | ADJUSTABLE DOOR CARRIAGE

CARRIAGE	Engineered Plastic
RIBS WIDTH	19mm*
ADJUSTMENT	5mm ($X = 35.5\text{mm} - 40.5\text{mm}$)

ROLLER	WHEEL	WEIGHT RATING	ORDER CODE
Standard	DR2/R6	20kg max load	9005093
Optional	DR4 /R6	40kg max load	9024713

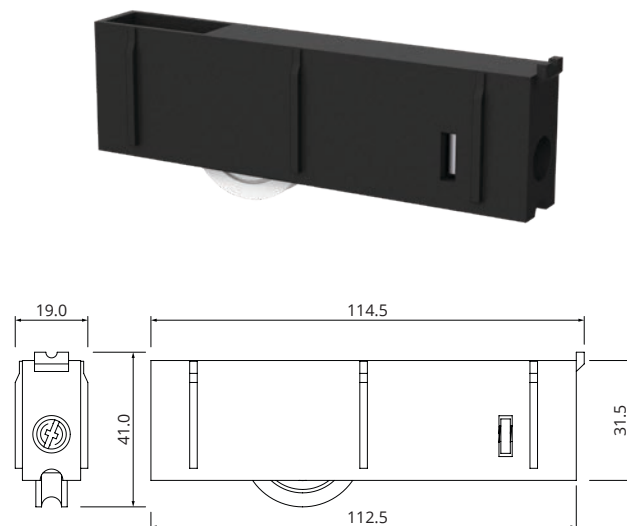

DR247 | ADJUSTABLE DOOR CARRIAGE WITH DR57

CARRIAGE	Engineered Plastic
FLARES	* 22.4mm wide

ROLLER	WHEEL	WEIGHT RATING	ORDER CODE
Standard	DR57	20kg max load	9008320

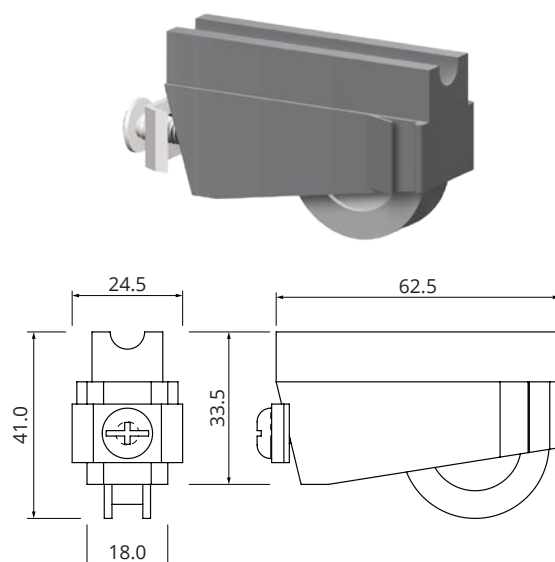

ROLLERS | SLIDING DOOR

DR338 | ADJUSTABLE DOOR CARRIAGE

CARRIAGE	Engineered Plastic
----------	--------------------

ROLLER	WHEEL	WEIGHT RATING	ORDER CODE
Standard	DR4	40kg max load	9002141
Optional	DR2	20kg max load	9002140
Optional	DR2/R6	20kg max load	9005022
Carriage Only			9002139

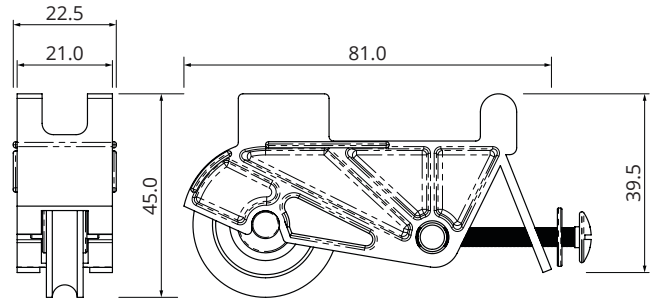
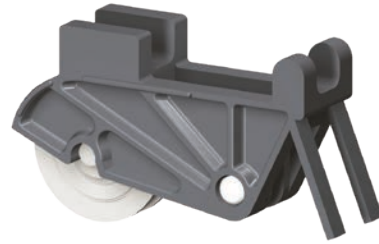

DR352 | STAINLESS STEEL ADJUSTABLE DOOR CARRIAGE

CARRIAGE	Stainless Steel
FLARES	* 17mm wide
ADJUSTMENT	11mm ($X = 32\text{mm} - 43\text{mm}$)

ROLLER	WHEEL	WEIGHT RATING	ORDER CODE
Standard	DR2	20kg max load	9002201
Optional	DR4	40kg max load	9002200

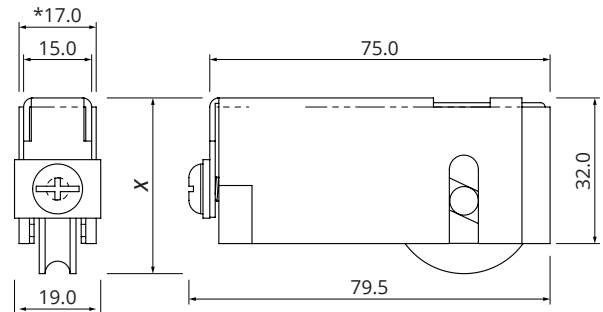

DR356 | ROLLER CARRIAGE

CARRIAGE	Plated Steel
----------	--------------

ROLLER	WHEEL	WEIGHT RATING	ORDER CODE
Standard	DR30	25kg max load	9002209

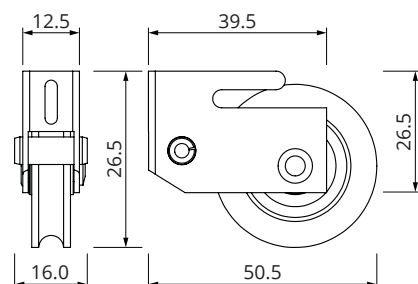

ROLLERS | SLIDING DOOR

DR357 | BRACKET

CARRIAGE	Engineered Plastic
APPLICATION	Suits DR356
ORDER CODE	9002212

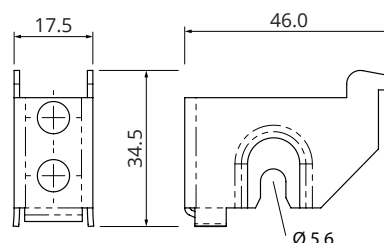

DR358 | ADJUSTABLE DOOR ROLLER (RIGHT HAND)

CARRIAGE	Engineered Plastic
ADJUSTMENT	11mm ($X = 31\text{mm} - 42\text{mm}$)



ROLLER	WHEEL	WEIGHT RATING	ORDER CODE
Standard	DR31	25kg max load	9041133

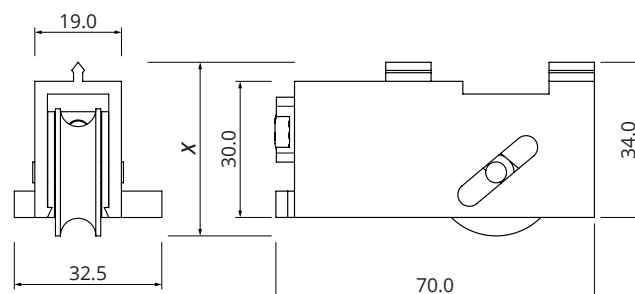

DR359 | ADJUSTABLE DOOR ROLLER (LEFT HAND)

CARRIAGE	Engineered Plastic
ADJUSTMENT	11mm ($X = 31\text{mm} - 42\text{mm}$)



ROLLER	WHEEL	WEIGHT RATING	ORDER CODE
Standard	DR31	25kg max load	9041134

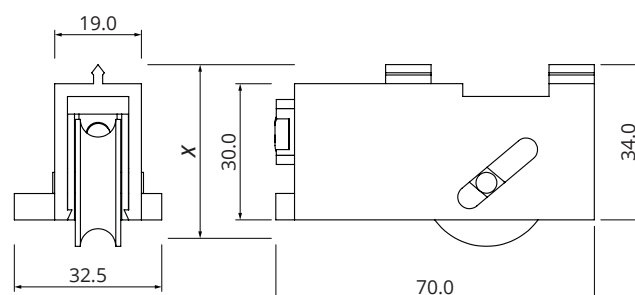

ROLLERS | SLIDING DOOR

DR361 | ADJUSTABLE DOOR CARRIAGE

CARRIAGE	Engineered Plastic
----------	--------------------

ROLLER	WHEEL	WEIGHT RATING	ORDER CODE
Standard	DR2	20kg max load	9002222
Optional	DR4	40kg max load	9002223
Carriage Only			9002221

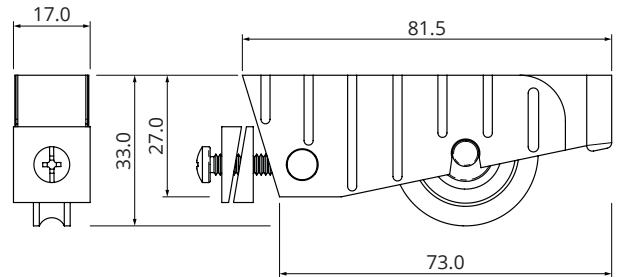
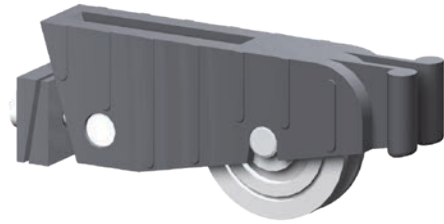

DR369 | ALUMINIUM ADJUSTABLE DOOR CARRIAGE

CARRIAGE	Stainless steel
FLARES	* 19mm wide
ADJUSTMENT	11mm ($X = 32\text{mm} - 43\text{mm}$)

ROLLER	WHEEL	WEIGHT RATING	ORDER CODE
Standard	DR2	20kg max load	9002242

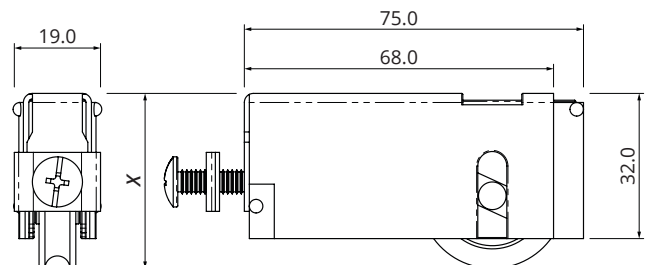

DR377 | ADJUSTABLE DOUBLE ROLLER CARRIAGE

CARRIAGE	Engineered plastic outer, Stainless steel adjustable carriage
ADJUSTMENT	8.5mm ($X = 40.5\text{mm} - 49\text{mm}$)

ROLLER	WHEEL	WEIGHT RATING	ORDER CODE
Standard	DR2/D5	40kg max load	9004477
Optional	DR71	100kg max load	9035665

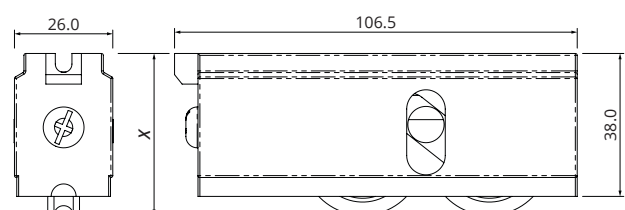

DR2210 | MULTI-PURPOSE HEAVY-DUTY ADAPTABLE ROLLER

Being **INNOVATIVE** has brought us success for over fifty years, so of course we're going to continue rolling with what works for us.

Introducing the **DR2210**, our latest Australian designed and engineered piece of innovative sliding door hardware.

Suits a **wide range** of residential and commercial sliding door systems, including some that have not been invented yet.

Talk to us or your Doric Rep for more information.



Fully adjustable carriage gives 10mm height adjustment



Outer and internal assembly manufactured to withstand corrosive environments



Recommended for larger sliding doors up to 200kg



Self-adjusting load distribution bogey for smooth and durable rolling



Purpose built end caps to suit specific extrusions

**AUSTRALIA'S BEST
& BIGGEST RANGE
OF WINDOW AND
DOOR HARDWARE**

For sales & information:
sales@doric.com.au
1300 132 389
www.doric.com.au



ROLLER | GUIDE

DORIC DOOR ROLLER		DOOR WEIGHT MAX RANGE		TESTED
DR4000 Quad Roller		DR71	280kg	30,000 Cycles
DR2210 Multi-Purpose Heavy Duty Adaptable Roller		DR78	200kg	30,000 Cycles
DR2000 Heavy Duty Double Adjustable Door Roller		DR2 DR71	40kg 200kg	30,000 Cycles
DR2001 Heavy Duty Double Adjustable Door Roller		DR2 DR71	40kg 200kg	30,000 Cycles
DR2003 Heavy Duty Double Adjustable Door Roller		DR71	200kg	30,000 Cycles
DR2009 Heavy Duty Double Timber Door Roller		DR71	200kg	30,000 Cycles
DR1000 Adjustable Door Roller		DR2	40kg	30,000 Cycles
DR1001 Adjustable Door Roller		DR2	40kg	30,000 Cycles
DR1009 Adjustable Timber Door Roller		DR71	100kg	30,000 Cycles

DR1000 | ROLLER SERIES

The DR1000 Series rollers are high performance products suited for residential or commercial sliding window & door applications.

Manufactured with an engineered polymer outer carriage housing and passivated zinc inner carriage, this adjustable roller offers superior corrosion resistance and durability.

The DR1000 roller provides great performance and is moulded with a high performance engineered polymer that gives superior load rating and cycle testing.



PRODUCT DETAILS

OUTER CARRIAGE	Engineered polymer
INNER CARRIAGE	Cast zinc passivated
TYRE	DR2 polymer with bearing, or DR71 high performance polymer with "ZZ" bearing
FINISH AVAILABLE	Black
MAX LOAD CAPACITY	20kg
TESTING	Tested to 30,000 cycles

FEATURES

- Fully adjustable carriage gives 10mm height adjustment
- Outer carriage and internal assembly manufactured to withstand corrosive environments
- Roller 'ZZ' bearing with ground precision bearing for corrosion free operation
- Polymer roller with bearing
- Passivated metal inner carriage
- Stainless steel adjusting screw and nut width away from the pivot centre

ADVANTAGES

- Suits aluminium, timber and UPVC sliding doors

DR1000 | ADJUSTABLE DOOR ROLLER

CARRIAGE	Outer: Engineered polymer Inner: Cast zinc passivated
APPLICATION	Suitable for aluminium sliding doors
ADJUSTMENT	10mm

ROLLER	WHEEL	WEIGHT RATING	ORDER CODE
Standard	DR2	20kg max load	9036686

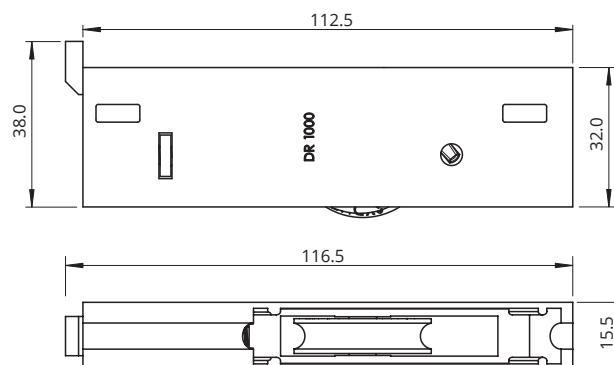
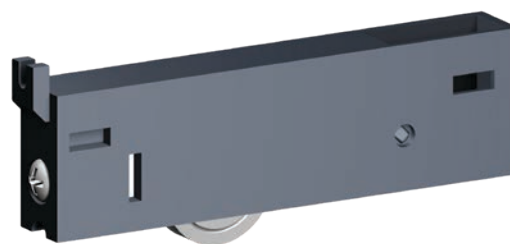

DR1001 | ADJUSTABLE DOOR ROLLER

CARRIAGE	Outer: Engineered polymer Inner: Cast zinc passivated
APPLICATION	Suitable for aluminium sliding doors
ADJUSTMENT	10mm

ROLLER	WHEEL	WEIGHT RATING	ORDER CODE
Standard	DR2	20kg max load	9033971

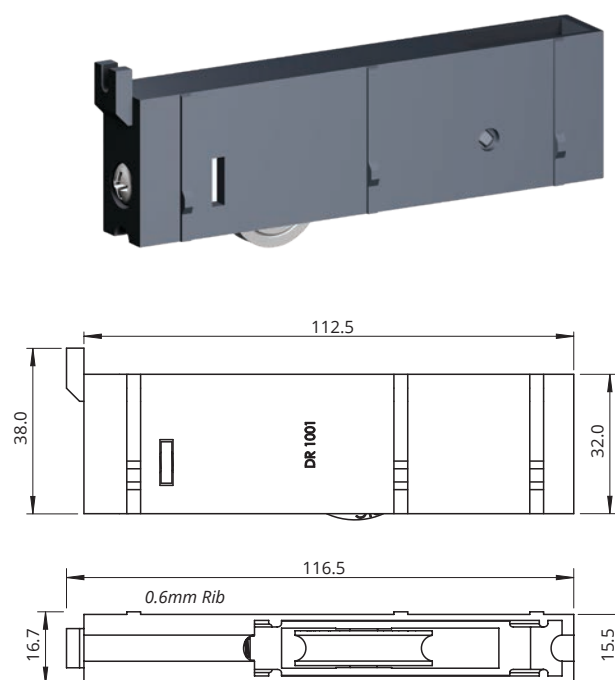

DR1009 | ADJUSTABLE TIMBER DOOR ROLLER

CARRIAGE	Outer: Engineered polymer Inner: Cast zinc passivated
APPLICATION	Suitable for timber sliding doors
ADJUSTMENT	10mm

ROLLER	WHEEL	WEIGHT RATING	ORDER CODE
Standard	DR71	50kg max load	9040456

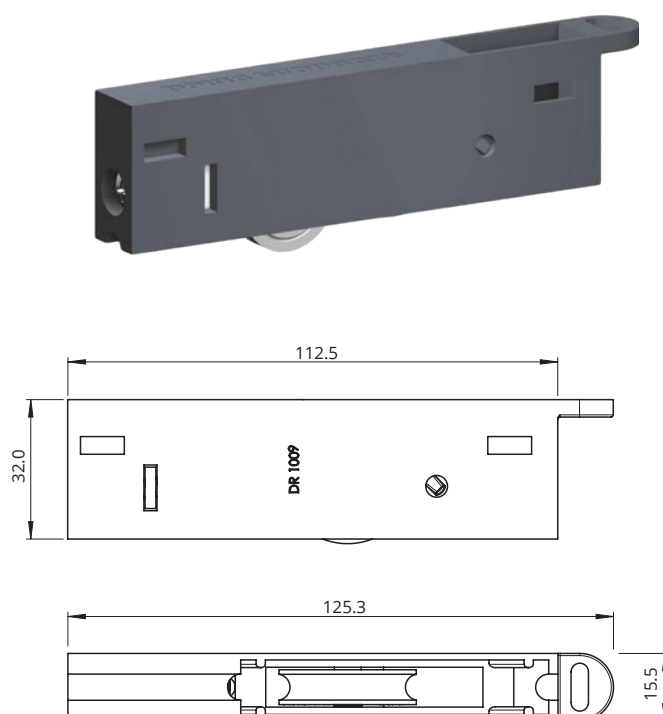

DR2000 | ROLLER SERIES

The DR2000 Series are high performance rollers suited for residential aluminium & timber door applications.

Manufactured with an engineered polymer outer carriage housing and passivated zinc inner carriage, this adjustable roller offers superior corrosion resistance and durability.

The DR2000 roller provides "ZZ" bearing performance rating and is moulded with a high performance engineered polymer that gives superior load rating and cycle testing.



PRODUCT DETAILS

OUTER CARRIAGE	Engineered polymer
INNER CARRIAGE	Cast zinc passivated
TYRE	DR2 polymer with bearing, or DR71 high performance polymer with "ZZ" bearing
FINISH AVAILABLE	Black
MAX LOAD CAPACITY	40kg / 100kg <i>carriage dependant</i>
TESTING	Tested to 30,000 cycles

FEATURES

- High performance roller with Doric's Ryvelin tyre
- Roller ZZ bearing with ground precision bearing and dust seal for corrosion free operation
- Passivated metal inner carriage
- Recommended for larger sliding doors up to 200kg
- Stainless steel adjusting screw and nut

ADVANTAGES

- Outer carriage and internal assembly manufactured to withstand corrosive environments
- Fully adjustable carriage gives 10mm height adjustment

DR2000 | HEAVY DUTY DOUBLE ADJUSTABLE DOOR ROLLER

CARRIAGE	Outer: Engineered polymer Inner: Cast zinc passivated
APPLICATION	Suitable for aluminium sliding doors
ADJUSTMENT	10mm

ROLLER	WHEEL	WEIGHT RATING	ORDER CODE
Standard	DR71	100kg max load	9041707
Optional	DR2	40kg max load	9036637

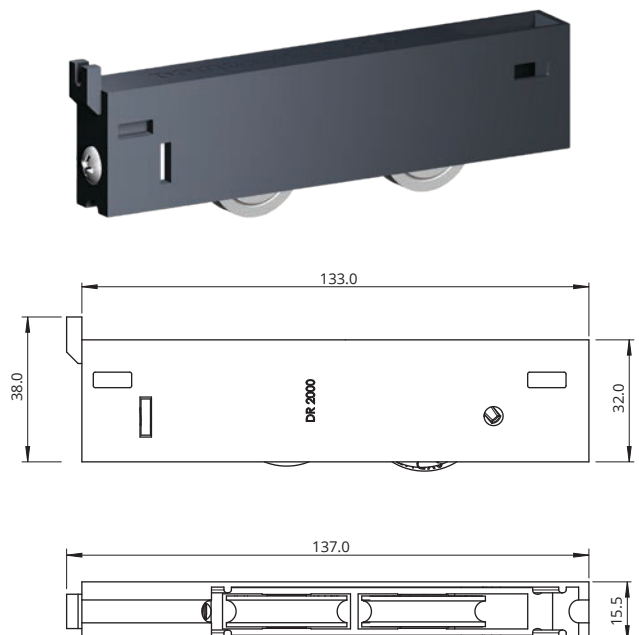

DR2001 | HEAVY DUTY DOUBLE ADJUSTABLE DOOR ROLLER

CARRIAGE		Outer: Engineered polymer Inner: Cast zinc passivated	
APPLICATION		Suitable for aluminium sliding doors	
ADJUSTMENT		10mm	
ROLLER	WHEEL	WEIGHT RATING	ORDER CODE
Standard	DR71	100kg max load	9033996
Optional	DR2	40kg max load	9033994

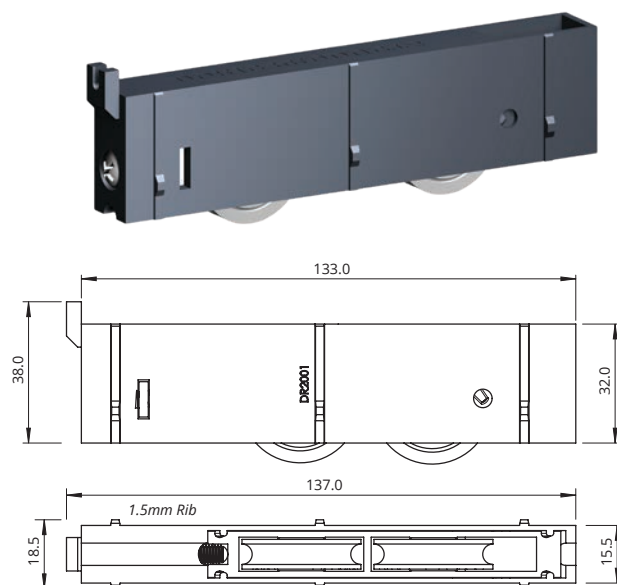

DR2003 | HEAVY DUTY DOUBLE ADJUSTABLE DOOR ROLLER

CARRIAGE		Outer: Engineered polymer Inner: Cast zinc passivated	
APPLICATION		Suitable for aluminium sliding doors	
ADJUSTMENT		10mm	
ROLLER	WHEEL	WEIGHT RATING	ORDER CODE
Standard	DR71	100kg max load	9034035

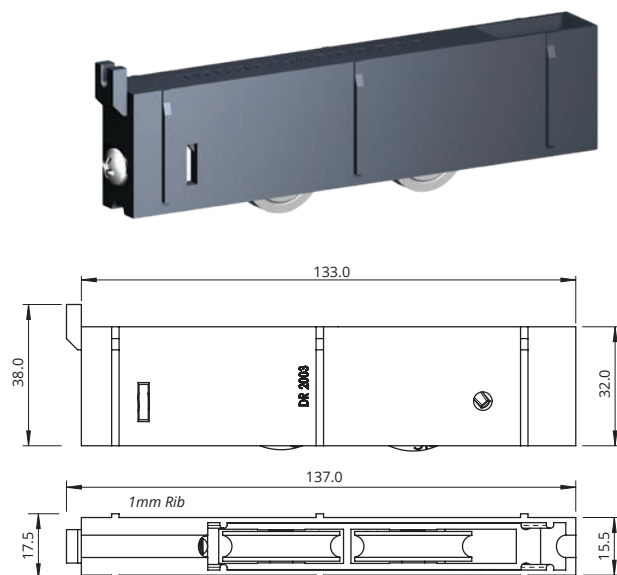

DR2009 | HEAVY DUTY DOUBLE TIMBER DOOR ROLLER

CARRIAGE		Outer: Engineered polymer Inner: Cast zinc passivated	
APPLICATION		Suitable for timber sliding doors	
ADJUSTMENT		10mm	
ROLLER	WHEEL	WEIGHT RATING	ORDER CODE
Standard	DR71	100kg max load	9040457

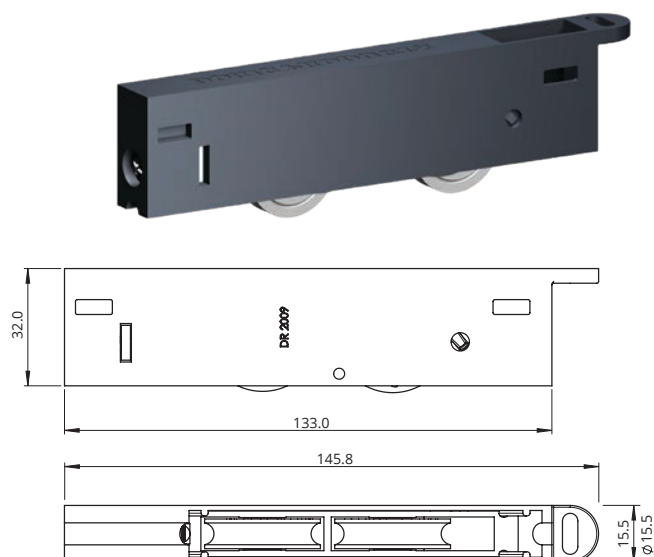

DR2210 | MULTI-PURPOSE HEAVY DUTY ADAPTABLE ROLLER

The DR2210 roller is a multi-purpose heavy duty patio door roller designed in Australia by Doric's engineering team to suit residential and commercial aluminium and uPVC sliding doors in high performance capacity.

Manufactured with an engineered polymer outer carriage housing and cast passivated black aluminium inner carriage, this adjustable roller offers superior corrosion resistance and durability.

The DR2210 roller provides “ZZ” bearing performance rating and is moulded with a high performance engineered polymer that gives excellent load rating and cycle testing.

Additionally, the aluminium inner carriage has been designed to provide greater cover and protection to the wheels, helping avoid chipping and other damage occurring prior to installation.



ADVANTAGES

- Suits aluminium and uPVC sliding doors
- Fully adjustable carriage gives 10mm height adjustment with Stainless steel adjusting screw and nut
- Outer carriage and internal assembly manufactured to withstand corrosive environments
- High performance roller with corrosion resistant ground precision “ZZ” bearing and dust seal
- Cast passivated black aluminium inner carriage designed to protect wheels and minimise damage prior to installation
- Recommended for larger sliding doors up to 200kg
- Unique multi-fit end caps that are quick to connect

PRODUCT DETAILS

OUTER CARRIAGE	Engineered polymer
INNER CARRIAGE	Cast passivated black aluminium
TYRE	DR78 high performance polymer with “ZZ” bearing and dust seal.
FINISH	Mill Finish Black
MAX LOAD CAPACITY	100kg per carriage
AVAILABLE END CAPS	DR14 DR17

TESTING

- Tested to 30,000 cycles
- Salt Spray tested for corrosion resistance

DR2210/14 | HEAVY DUTY MULTI-PURPOSE ROLLER

OUTER CARRIAGE	Engineered polymer
INNER CARRIAGE	Cast passivated black aluminium
TYRE	DR78
FINISH	Mill Finish Black
ADJUSTMENT	10mm

ROLLER	END CAP	WHEEL	WEIGHT RATING	ORDER CODE
Standard	14	DR78	100kg max load	9108828

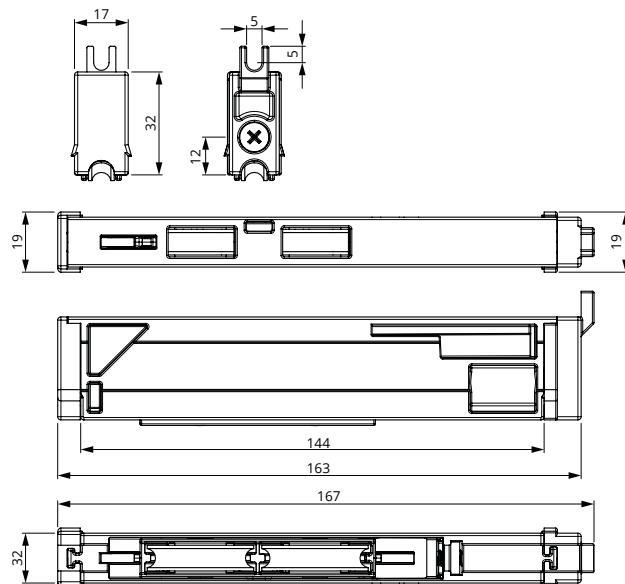

DR2210/17 | HEAVY DUTY MULTI-PURPOSE ROLLER

OUTER CARRIAGE	Engineered polymer
INNER CARRIAGE	Cast passivated black aluminium
TYRE	DR78
FINISH	Mill Finish Black
ADJUSTMENT	10mm

ROLLER	END CAP	WHEEL	WEIGHT RATING	ORDER CODE
Standard	17	DR78	100kg max load	9110028

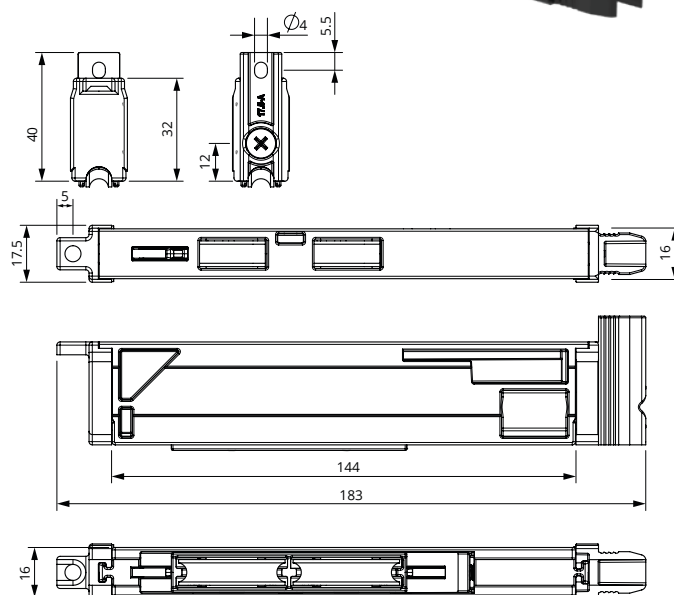

DR4000 | QUAD ROLLER

The DR4000 Quad Roller is a high performance roller carriage assembly consisting of 4 x "ZZ" precision bearing rollers with Ryvelin tyres for smooth operation and durability.

The combination of an engineered polymer outer carriage, stainless steel middle carriage and cast zinc inner carriage is designed to support door weights up to 280kg.



ADVANTAGES

- Fully adjustable carriage gives 8.5mm height adjustment
- High performance rollers with ZZ bearing seal
- Ryvelin tyres for smooth operation and durability
- Stainless steel pivot pins and bearing axles
- Cycled test to 30,000 cycles
- Maximum Carriage Load Rating 140kg (280kg Door)

PRODUCT DETAILS

OUTER CARRIAGE	Engineered polymer
INNER CARRIAGE	Cast zinc passivated
TYRE	DR 71 high performance polymer with "ZZ" bearing and dust seal.
FINISH AVAILABLE	Black
ADJUSTMENT	8.5mm
MAX LOAD CAPACITY	140kg per carriage

TESTING

- Tested to 30,000 cycles

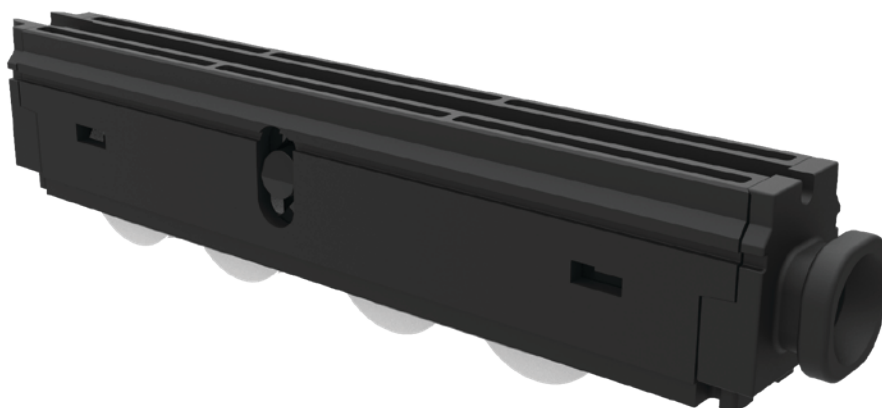



DIMENSIONS

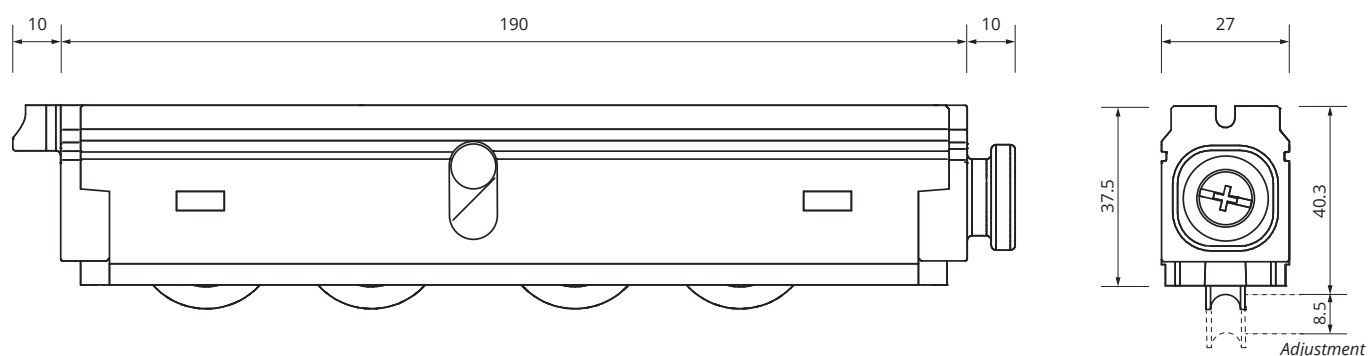

HOW TO ORDER

ROLLER	WHEEL	WEIGHT RATING	ORDER CODE
Standard	DR71	140kg max load	9046223

DR234 | SECURITY DOOR ROLLER

The DR234 Series Roller is a high performance security roller. It features side lugs for optimum fitting, spring loaded inner carriage and adjustability by up to 7.5mm.

The DR234 uses a precision bearing and a tyre made from high impact polymer housing to be both efficient and highly durable.

ADVANTAGES

- Ideal for coastal application
- Spring loaded
- 7.5mm of adjustment
- Highly durable

FEATURES

- Increased support around the adjusting screw
- Hi Impact Polymer Housing
- Wheel hold back function with DR234/N for easier installation

DR234/SL64 | SECURITY DOOR ROLLER - SPRING LOADED

MATERIAL	Engineered polymer
ADJUSTMENT	7.5mm

ROLLER	WHEEL	WEIGHT RATING	ORDER CODE
Standard	DR64	22.5kg max load	9012698

TESTING

- Tested to 45kg a pair at 100 000 cycles
- 720 hour salt spray tested

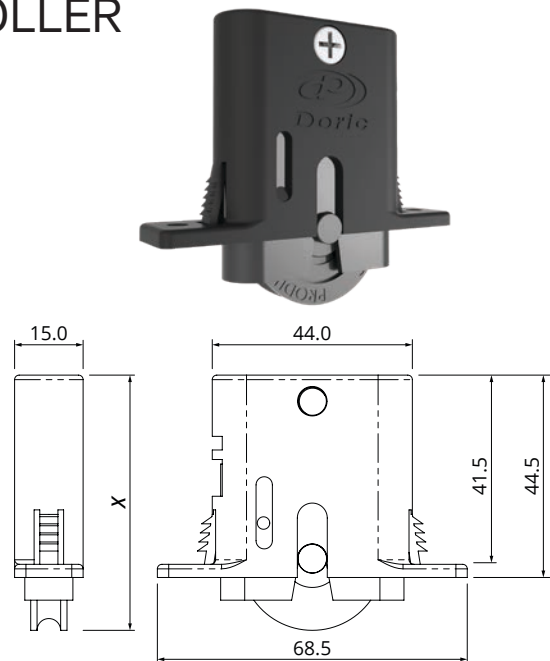

DR234/N | SECURITY DOOR ROLLER - SPRING LOADED (HOLD BACK)

MATERIAL	Engineered polymer
ADJUSTMENT	7.5mm

ROLLER	WHEEL	WEIGHT RATING	ORDER CODE
Standard	DR64	22.5kg max load	9047909

TESTING

- Tested to 45kg a pair at 100 000 cycles
- 720 hour salt spray tested

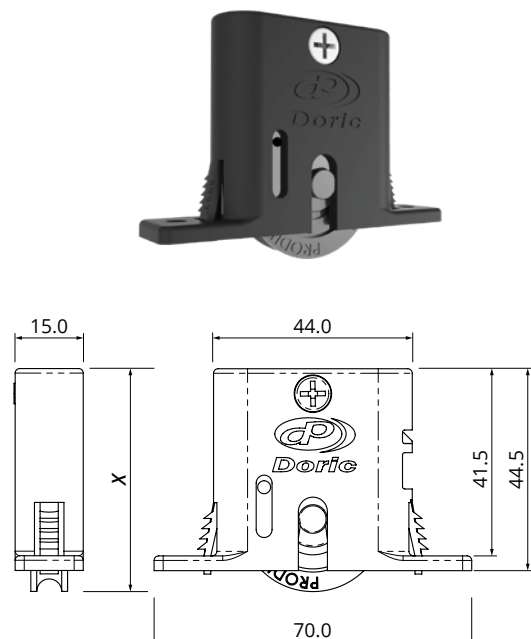

ROLLERS | SCREEN DOOR

DR224 | FLYSCREEN DOOR CARRIAGE

MATERIAL	Engineered plastic
----------	--------------------

ROLLER	WHEEL	WEIGHT RATING	ORDER CODE
Standard	DR25	15kg max load	9002081
Carriage Only			9002079

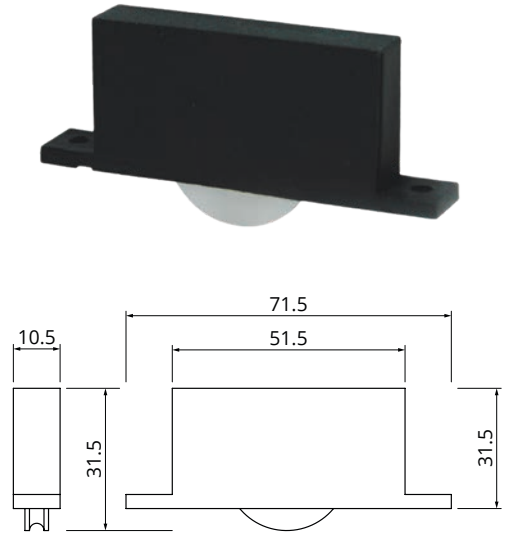

DR227 | ADJUSTABLE SECURITY DOOR CARRIAGE - NON-SPRING LOADED

MATERIAL	Engineered plastic
ADJUSTMENT	9mm ($X = 51mm - 60mm$)

ROLLER	WHEEL	WEIGHT RATING	ORDER CODE
Standard	DR2	20kg max load	9002092

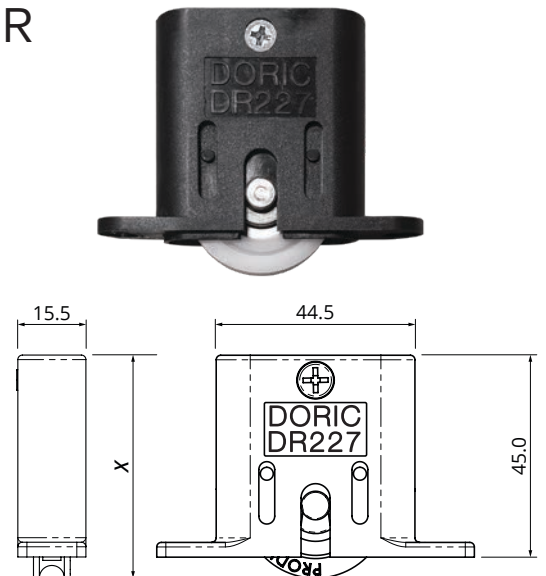

DR235 | ADJUSTABLE FLYSCREEN DOOR CARRIAGE

MATERIAL	Engineered plastic
ADJUSTMENT	6mm ($X = 31.5mm - 37.5mm$)

ROLLER	WHEEL	WEIGHT RATING	ORDER CODE
Standard	DR6	15kg max load	9002112
Carriage Only			9003376

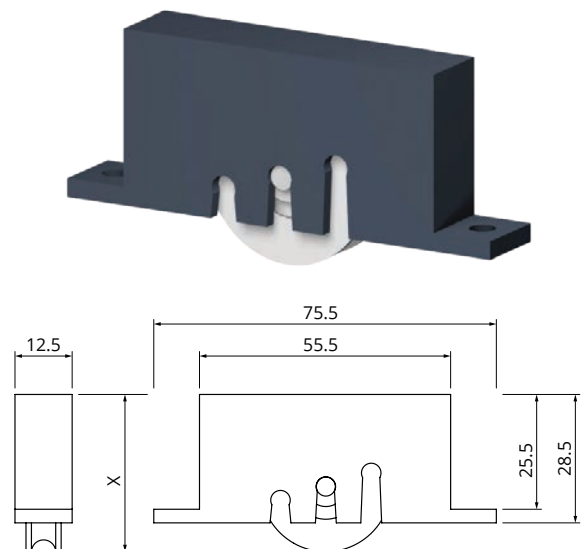

ROLLERS | SCREEN DOOR

DR339 | ADJUSTABLE FLYSCREEN DOOR CORNER STAKE

MATERIAL	Engineered plastic
ADJUSTMENT	8mm (X)

ROLLER	WHEEL	WEIGHT RATING	ORDER CODE
Standard	DR34	15kg max load	9002143

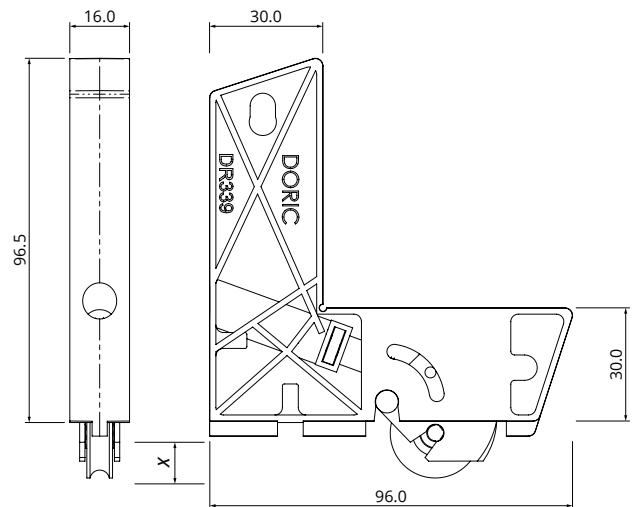

DR340 | ADJUSTABLE SECURITY DOOR CORNER STAKE

MATERIAL	Engineered plastic
ADJUSTMENT	4mm (X)

ROLLER	WHEEL	WEIGHT RATING	ORDER CODE
Standard	DR6	15kg max load	9002145

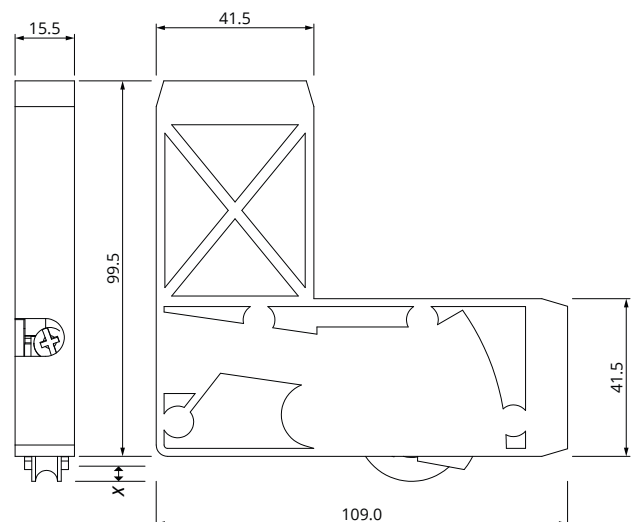
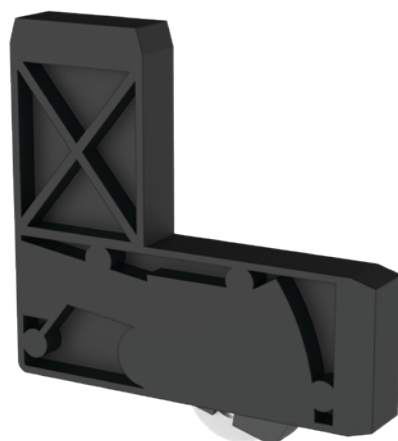

ROLLERS | SCREEN DOOR

DR346 | FLYSCREEN DOOR ROLLER HANGER BRACKET

MATERIAL	Zinc
----------	------

ROLLER	WHEEL	WEIGHT RATING	ORDER CODE
Standard	DR42	10kg max load	9002161

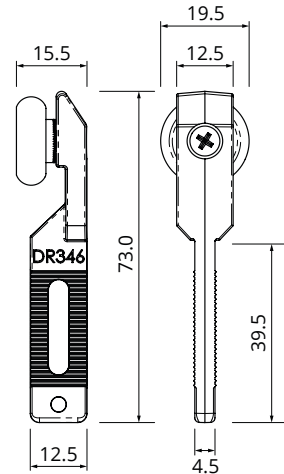

DR350 | FLYSCREEN DOOR ROLLER HANGER BRACKET

MATERIAL	Zinc
----------	------

ROLLER	WHEEL	WEIGHT RATING	ORDER CODE
Standard	DR42	10kg max load	9002192
Hanger Bracket Only - Left Hand			9002189
Hanger Bracket Only - Right Hand			9004657



(LH Shown)

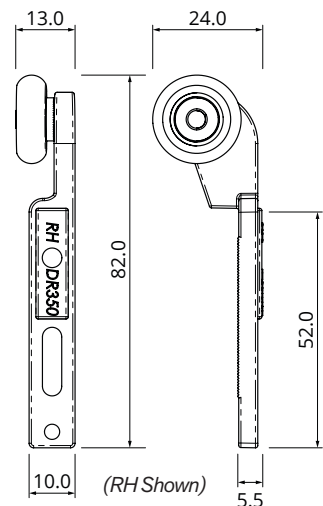

DR362 | FLYSCREEN DOOR ROLLER HANGER BRACKET

MATERIAL	Zinc
----------	------

ROLLER	WHEEL	WEIGHT RATING	ORDER CODE
Standard	DR42	10kg max load	9003378

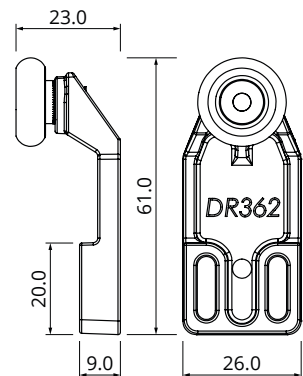

ROLLERS | WARDROBE DOORS

DR140 | ADJUSTABLE MIRROR WARDROBE ROLLER

MATERIAL		Zinc seal	
ADJUSTMENT		23mm ($X = 74\text{mm} - 97\text{mm}$)	
ROLLER	WHEEL	WEIGHT RATING	ORDER CODE
Standard	DR35	25kg max load	9001890

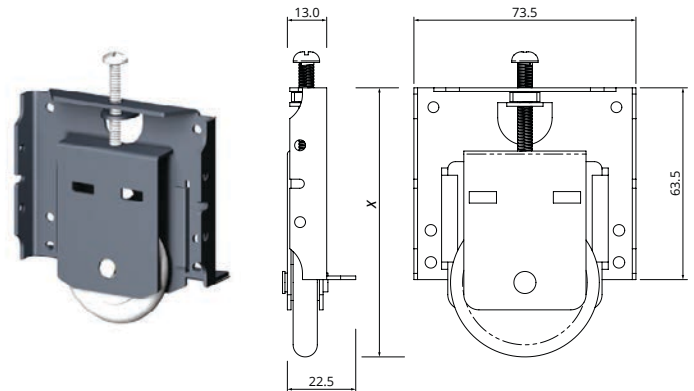

DR229 | ADJUSTABLE MIRROR WARDROBE ROLLER

MATERIAL		Plated steel	
PRODUCT NOTES		Not stocked, Made to order	

ROLLER	WHEEL	WEIGHT RATING	ORDER CODE
Standard	DR36	20kg max load	9002097

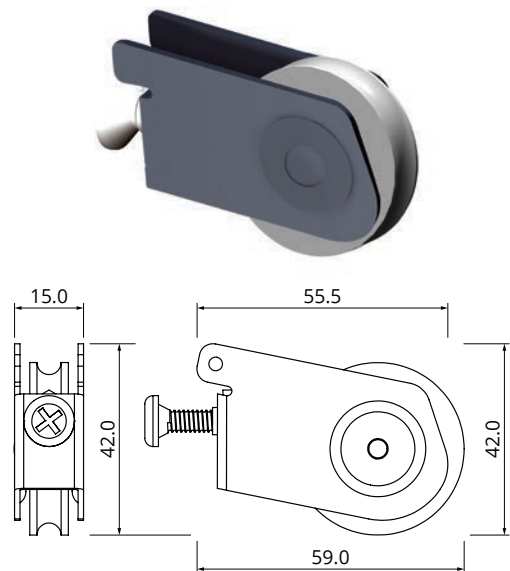

DR250 | ADJUSTABLE SLIDING WARDROBE DOOR ROLLER

MATERIAL		Engineered plastic	
-----------------	--	--------------------	--

ROLLER	WHEEL	WEIGHT RATING	ORDER CODE
Standard	DR62	20kg max load	9009720
Optional MTO	DR2	20kg max load	9041019
Carriage Only			9009718

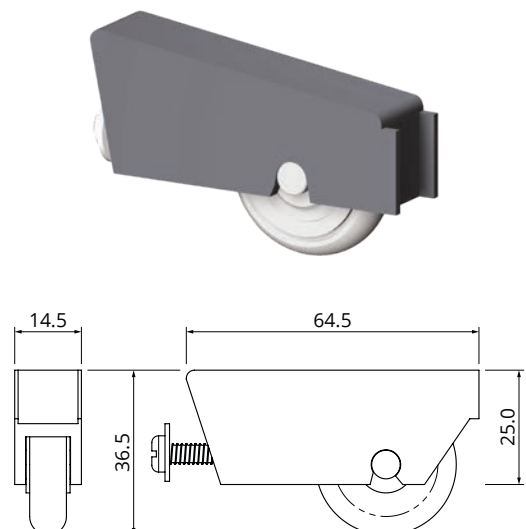

WHEELS & TYRES DOOR & WINDOW HARDWARE



ROLLERS | WHEELS & TYRES

DR40 | DELRIN TYRE WITH BALL BEARING & HUB

TYRE PROFILE	Flat: 6mm Width Hub: 2mm Width
MATERIALS	Tyre: Delrin Race: Passivated Metal Hub: Steel
RACE	Precision Bearing
AXLE	4.0mm - Bore diameter
WEIGHT RATING	10kg max load
ORDER CODE	9000785

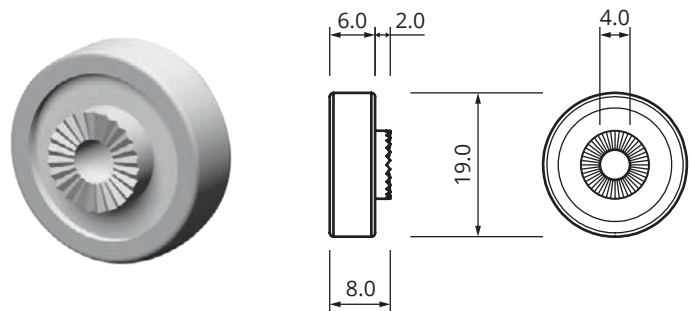

DR42 | DELRIN TYRE WITH BALL BEARING & HUB

TYRE PROFILE	Convex: 6.5mm Width Hub: 2mm Width
MATERIALS	Tyre: Delrin Race: Passivated Metal Hub: Steel
RACE	Precision Bearing
AXLE	4.0mm - Bore diameter
WEIGHT RATING	10kg max load
ORDER CODE	9000787

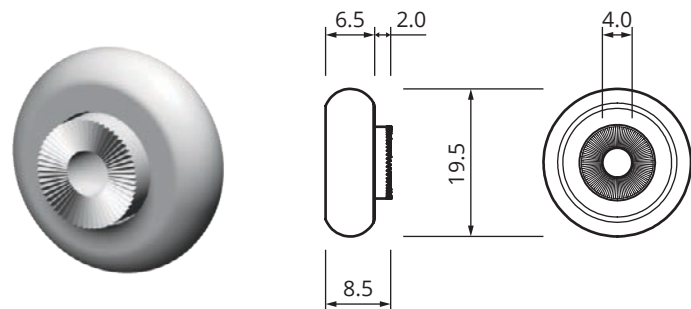

DR43 | DELRIN TYRE WITH BALL BEARING & HUB

TYRE PROFILE	Convex: 6mm Width Hub: 5mm Width
MATERIALS	Tyre: Delrin Race: Passivated Metal Hub: Steel
RACE	Precision Bearing
AXLE	6.5mm - Bore diameter
WEIGHT RATING	10kg max load
ORDER CODE	9000788

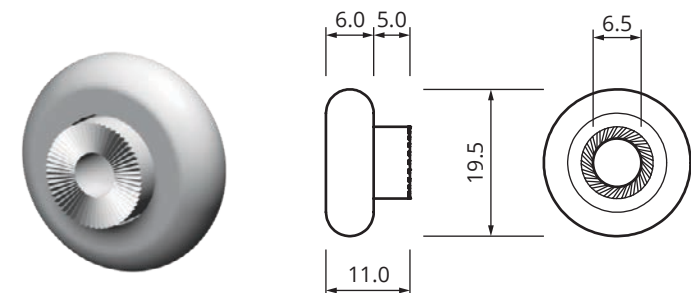

ROLLERS | WHEELS & TYRES

DR44 | DELRIN TYRE WITH BALL BEARING & HUB

TYRE PROFILE	Convex: 6.5mm Width Hub: 6mm Width
MATERIALS	Tyre: Delrin Race: Passivated Metal Hub: Steel
RACE	Precision Bearing
AXLE	3.5mm - Bore diameter
WEIGHT RATING	10kg max load
ORDER CODE	9000789

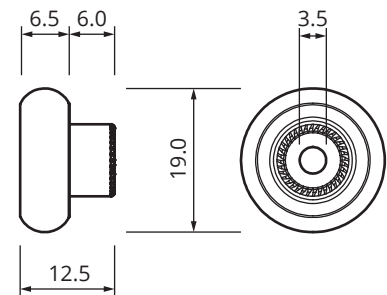

DR135 | HEXAGON SCREWS

SUITS	DR40, DR42, DR43, DR44
MATERIALS	Zinc plated
PACK QTY	1000
ORDER CODE	9000789

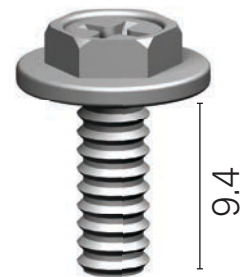

DR1 | DELRIN TYRE WITH BALL BEARING & NO AXLE

TYRE PROFILE	Concave Groove Width: 5mm
MATERIALS	Tyre: Delrin Race: Passivated Metal
RACE	Precision Bearing
AXLE	6.5mm - Bore diameter
WEIGHT RATING	20kg max load
ORDER CODE	9000749

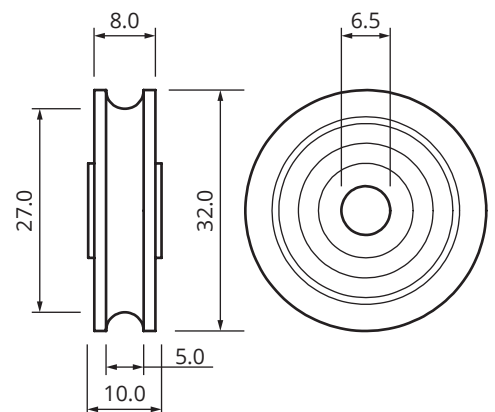

ROLLERS | WHEELS & TYRES

DR2 | DELRIN TYRE WITH BALL BEARING & AXLE

TYRE PROFILE	Concave: Groove Width: 5mm; 5.5mm
MATERIALS	Tyre: Delrin Race: Passivated Metal
RACE	Precision Bearing
AXLE	6mm - Axle diameter Standard: 15mm length Short Axle: 12mm length
WEIGHT RATING	20kg max load
ORDER CODE	D5: 9000750 D6: 9004786 D6 (Short Axle): 9005097

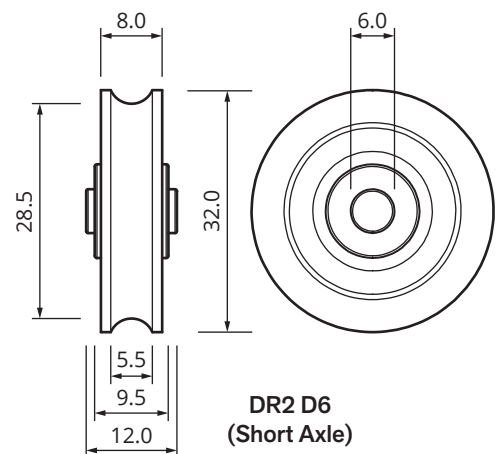
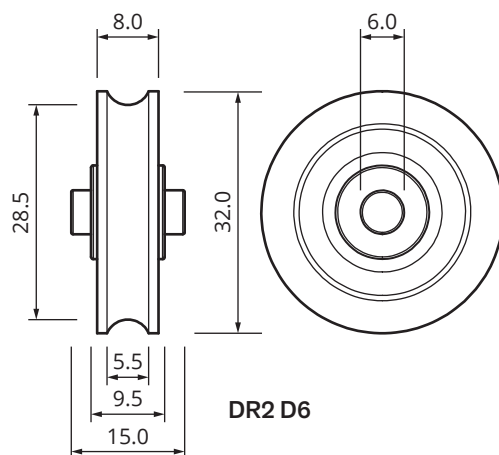
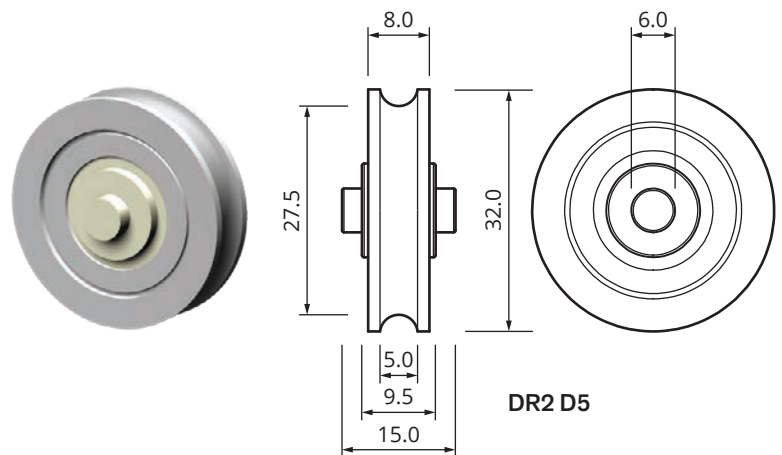

DR3 | DELRIN TYRE WITH BALL BEARING & NO AXLE

TYRE PROFILE	Concave: Groove Width: 5mm
MATERIALS	Tyre: Delrin Race: Passivated Metal
RACE	Precision Bearing
AXLE	6.5mm - Bore diameter
WEIGHT RATING	15kg max load
ORDER CODE	9000751

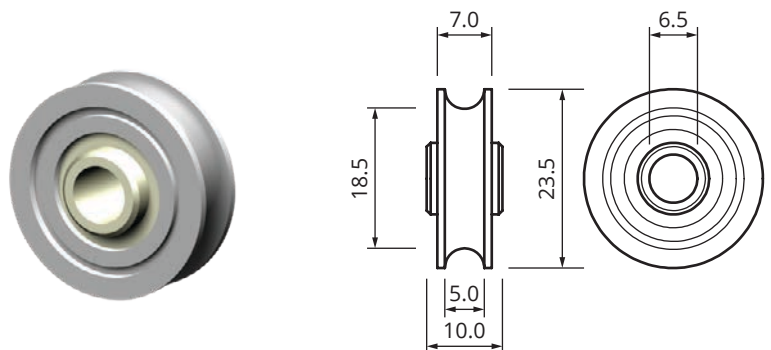

ROLLERS | WHEELS & TYRES

DR4 | STAINLESS STEEL TYRE WITH BALL BEARING & AXLE

TYRE PROFILE	Concave: Groove Width: 6mm
MATERIALS	Tyre: Stainless steel Rim: Stainless steel
RACE	Precision Bearing
AXLE	6.5mm - Axle diameter
WEIGHT RATING	40kg max load
ORDER CODE	9000752

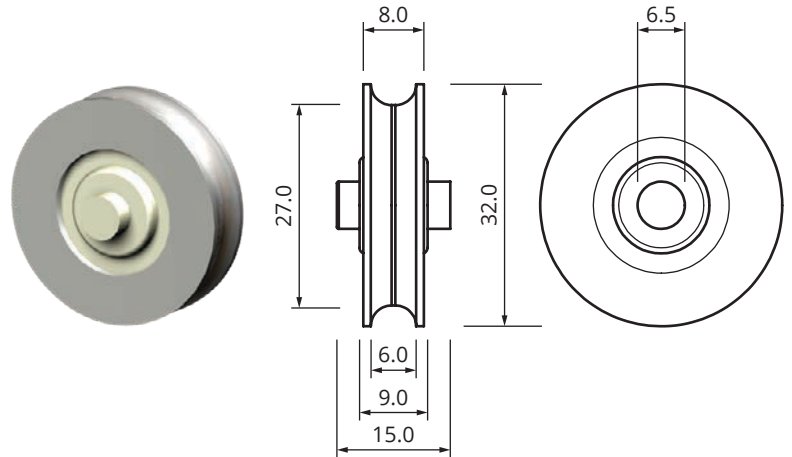

DR5 | STAINLESS STEEL TYRE WITH BALL BEARING & NO AXLE

TYRE PROFILE	Concave Groove Width: 5mm
MATERIALS	Tyre: Stainless steel Rim: Stainless steel
RACE	Precision Bearing
AXLE	6.5mm - Bore diameter
WEIGHT RATING	40kg max load

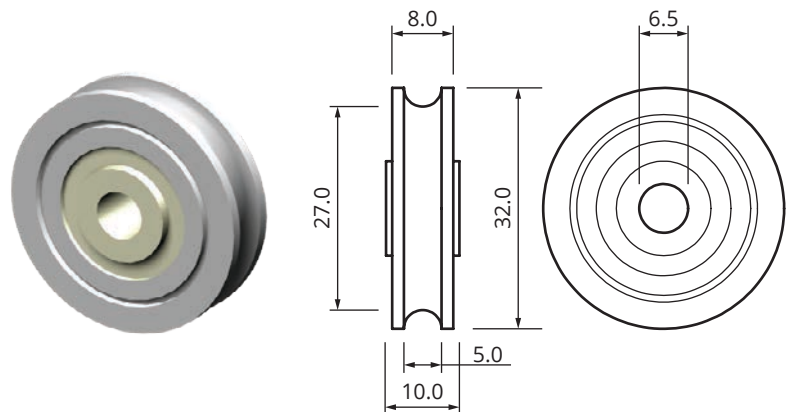

Not available for individual sale.
Only available with DR209/5.

DR6 | DELRIN TYRE WITH BALL BEARING & AXLE

TYRE PROFILE	Concave: Groove Width: 5.5mm
MATERIALS	Tyre: Delrin Race: Passivated Metal
RACE	Precision Bearing
AXLE	4.5mm - Axle diameter
WEIGHT RATING	15kg max load
ORDER CODE	9000754

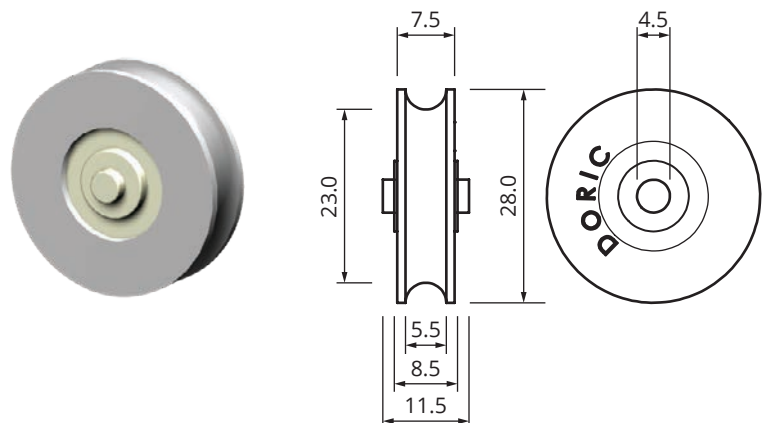

ROLLERS | WHEELS & TYRES

DR7 | BRASS TYRE WITH NO AXLE

TYRE PROFILE	Flat: Tread Width: 14mm
MATERIALS	Tyre: Brass Race: Brass
RACE	Precision Bearing
AXLE	12mm - Bore diameter
WEIGHT RATING	50kg max load

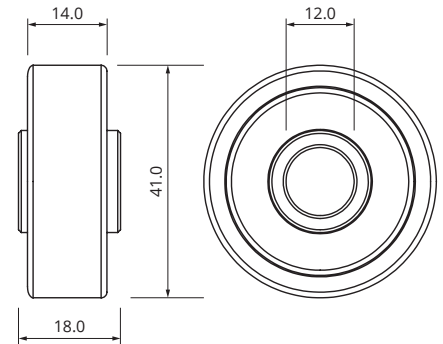
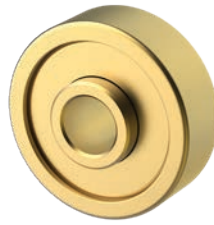

Not available for individual sale.
Only available with DR137.

DR9 | DELRIN TYRE WITH BALL BEARING & AXLE

TYRE PROFILE	Concave: Groove Width: 3mm
MATERIALS	Tyre: Delrin Race: Passivated Metal
RACE	Precision Bearing
AXLE	3mm - Axle diameter
WEIGHT RATING	10kg max load
ORDER CODE	9000757

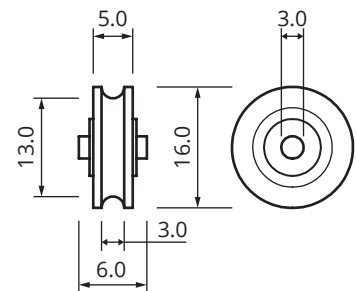

DR11 | DELRIN TYRE WITH NO AXLE

TYRE PROFILE	Concave: Groove Width: 3mm
MATERIALS	Tyre: Delrin
RACE	Axle Hole Only
AXLE	5mm - Bore diameter
WEIGHT RATING	10kg max load
ORDER CODE	9000759

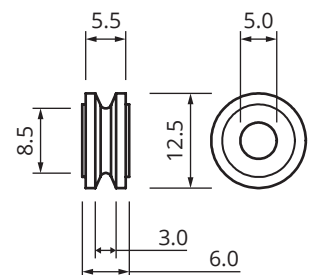

ROLLERS | WHEELS & TYRES

DR12 | DELRIN TYRE WITH NO AXLE

TYRE PROFILE	Flat Tread Width: 4mm
MATERIALS	Tyre: Delrin
RACE	Axle Hole Only
AXLE	4mm - Bore diameter
WEIGHT RATING	10kg max load

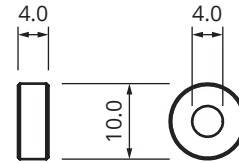

Not available for individual sale.
Reference Only.

DR13 | DELRIN TYRE WITH NO AXLE

TYRE PROFILE	Concave: Groove Width: 3mm
MATERIALS	Tyre: Delrin
RACE	Axle Hole Only
AXLE	5mm - Bore diameter
WEIGHT RATING	10kg max load
ORDER CODE	9000761

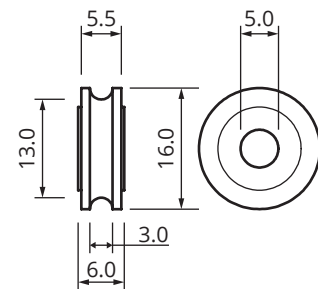

DR18 | DELRIN TYRE WITH NO AXLE

TYRE PROFILE	Concave: Groove Width: 2.5mm
MATERIALS	Tyre: Delrin
RACE	Axle Hole Only
AXLE	3.5mm - Bore diameter
WEIGHT RATING	10kg max load

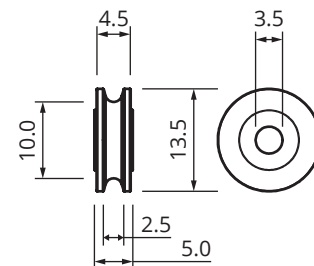

Not available for individual sale.
Sold as part in DR347/18.

ROLLERS | WHEELS & TYRES

DR25 | DELRIN TYRE WITH BALL BEARING & AXLE

TYRE PROFILE	Concave: Groove Width: 3mm
MATERIALS	Tyre: Delrin Race: Passivated Metal
RACE	Precision Bearing
AXLE	5mm - Axle diameter
WEIGHT RATING	15kg max load

Not available for individual sale.
Sold as part in DR208/25.

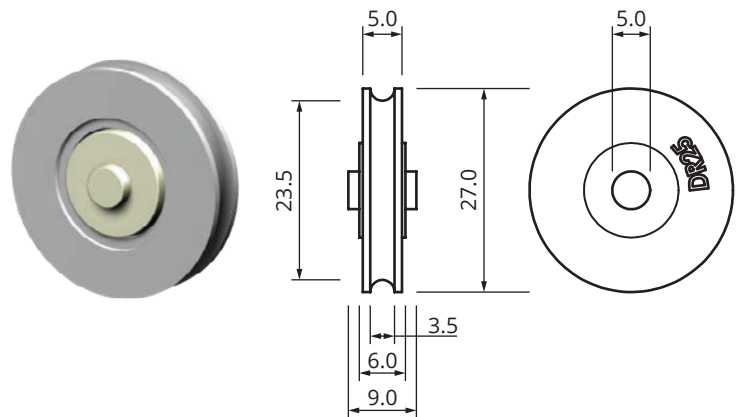

DR26 | DELRIN TYRE WITH BALL BEARING & AXLE

TYRE PROFILE	Concave: Groove Width: 5.5mm
MATERIALS	Tyre: Delrin Race: Passivated Metal
RACE	Precision Bearing
AXLE	6.5mm - Axle diameter
WEIGHT RATING	20kg max load

Not available for individual sale.
Only available with DR141/26 and DR369/26.

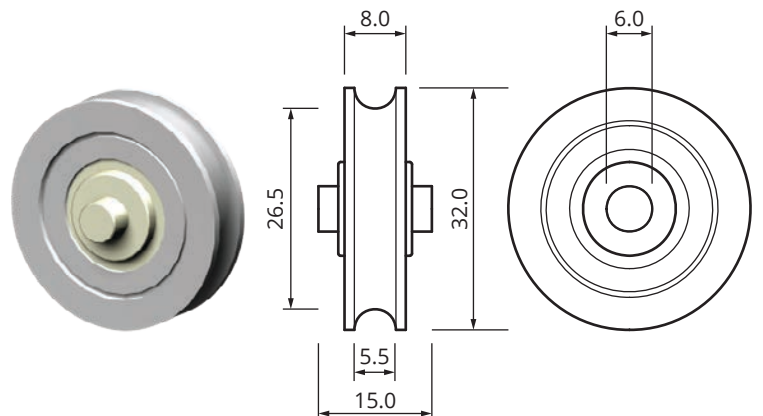

DR27 | DELRIN TYRE WITH NO AXLE

TYRE PROFILE	Concave: Groove Width: 1.5mm
MATERIALS	Tyre: Delrin
RACE	Axle Hole Only
AXLE	3.5mm - Bore diameter
WEIGHT RATING	10kg max load

Not available for individual sale.
Reference Only.

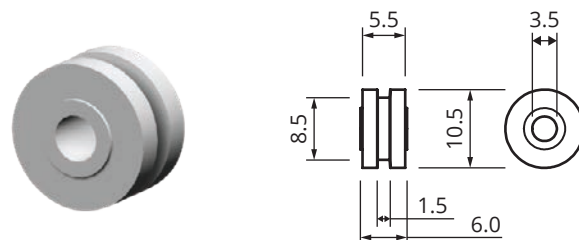

ROLLERS | WHEELS & TYRES

DR31 | DELRIN TYRE WITH NO AXLE

TYRE PROFILE	Concave: Groove Width: 8mm
MATERIALS	Tyre: Delrin
RACE	Axle Hole Only
AXLE	8mm - Bore diameter
WEIGHT RATING	10kg max load

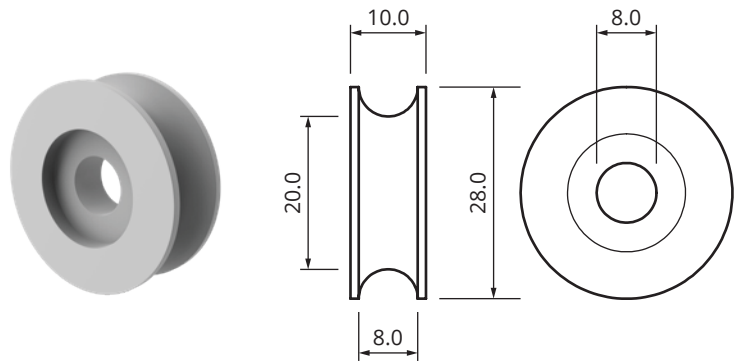

Not available for individual sale.
Only available with DR358 and DR359.

DR34 | DELRIN TYRE WITH BALL BEARING & AXLE

TYRE PROFILE	Concave: Groove: 5mmW
MATERIALS	Tyre: Delrin Race: Passivated Metal
RACE	Precision Bearing
AXLE	4.5mm - Axle diameter Standard: 10mm length Extended: 12.6mm length
WEIGHT RATING	20kg max load
ORDER CODE	Standard Axle: 9000781 Extended Axle: 9010568

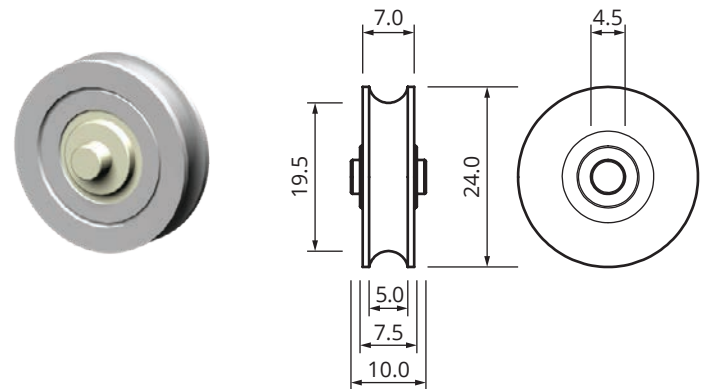

DR35 | DELRIN TYRE WITH BALL BEARING & NO AXLE

TYRE PROFILE	Convex Width: 8mm
MATERIALS	Tyre: Delrin Race: Passivated Metal
RACE	Precision Bearing
AXLE	6mm - Bore diameter
WEIGHT RATING	25kg max load

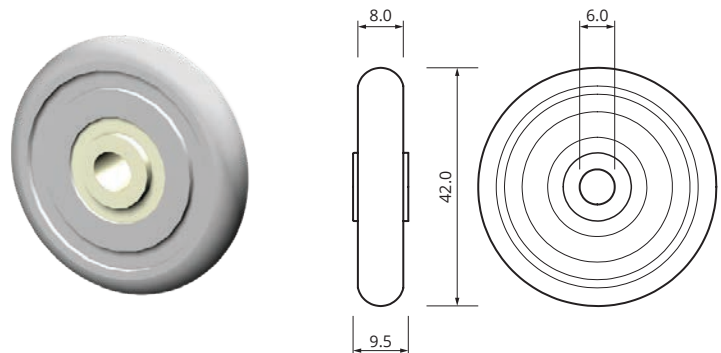

Not available for individual sale.
Only available with DR140/35.

ROLLERS | WHEELS & TYRES

DR36 | DELRIN TYRE WITH BALL BEARING & AXLE

TYRE PROFILE	Concave: Groove Width: 5.5mm
MATERIALS	Tyre: Delrin Race: Passivated Metal
RACE	Precision Bearing
AXLE	6mm - Axle diameter
WEIGHT RATING	20kg max load
ORDER CODE	9000783

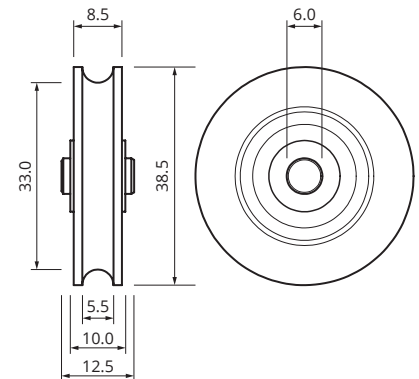

DR52 | STAINLESS STEEL TYRE WITH BALL BEARING & AXLE

TYRE PROFILE	Concave: Groove Width: 3mm
MATERIALS	Tyre: Stainless steel Race: Stainless steel
RACE	Precision Bearing
AXLE	5mm - Axle diameter
WEIGHT RATING	12kg max load
ORDER CODE	9005844

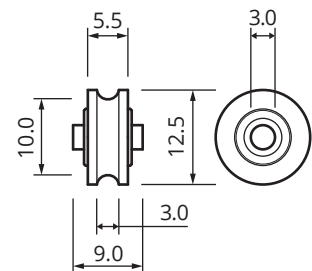

DR56 | DELRIN TYRE WITH NO AXLE

TYRE PROFILE	Concave: Groove Width: 3mm
MATERIALS	Tyre: Delrin
RACE	Axle Hole Only
AXLE	5mm - Bore Diameter
WEIGHT RATING	10kg max load
ORDER CODE	9006963

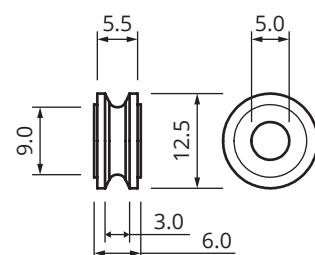

ROLLERS | WHEELS & TYRES

DR58 | DELRIN TYRE WITH NO AXLE

TYRE PROFILE	Concave: Groove Width: 2.5mm
MATERIALS	Tyre: Delrin
RACE	Axle Hole Only
AXLE	5mm - Bore Diameter
WEIGHT RATING	10kg max load
ORDER CODE	9015259

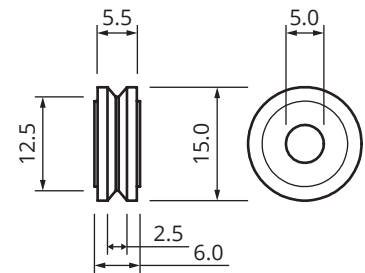

DR62 | DELRIN TYRE WITH BALL BEARING & AXLE

TYRE PROFILE	Convex Width: 8.5mm
MATERIALS	Tyre: Delrin Race: Passivated Metal
RACE	Precision Bearing
AXLE	6mm - Axle diameter
WEIGHT RATING	20kg max load
ORDER CODE	9009719

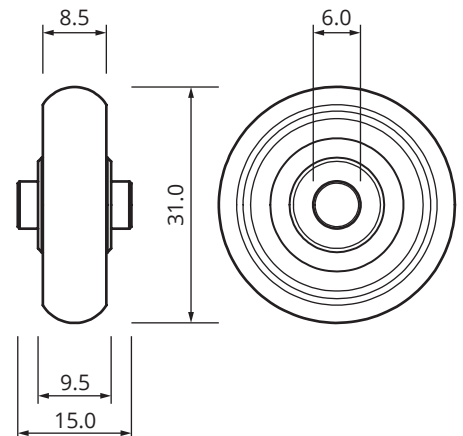

DR63 | DELRIN TYRE WITH NO AXLE

TYRE PROFILE	Concave: Groove Width: 3mm
MATERIALS	Tyre: Delrin
RACE	Axle Hole Only
AXLE	5mm - Bore diameter
WEIGHT RATING	10kg max load

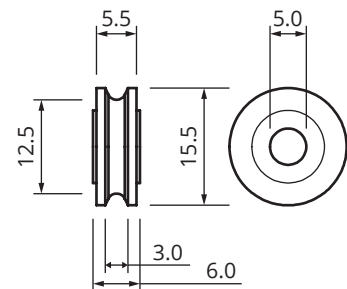

Sold as part in DR405,
Not available for individual sale.

ROLLERS | WHEELS & TYRES

DR64 | DELRIN TYRE WITH BALL BEARING & AXLE

TYRE PROFILE	Concave: Groove Width: 5mm
MATERIALS	Tyre: Delrin
RACE	Precision Bearing
AXLE	6.5mm - Bore diameter
WEIGHT RATING	22.5kg max load

Sold as part in DR234 range,
Not available for individual sale.

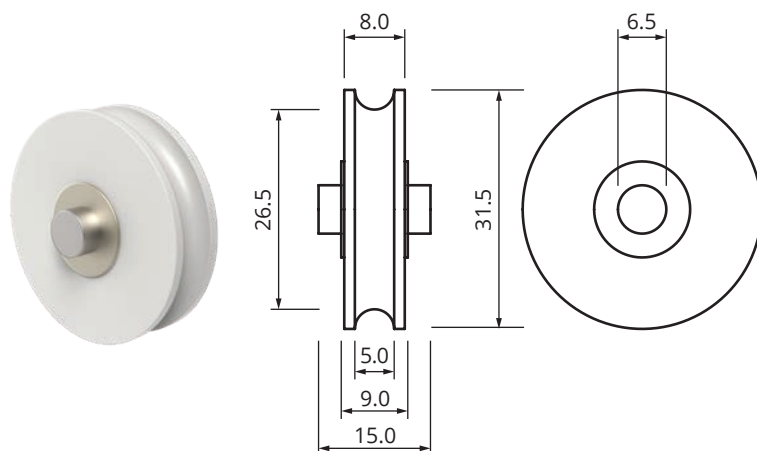

DR71 | DELRIN TYRE WITH BALL BEARING & NO AXLE

TYRE PROFILE	Concave: Groove Width: 6mm
MATERIALS	Tyre: Delrin Race: Passivated Metal
RACE	Precision Bearing
AXLE	8mm - Bore Diameter
WEIGHT RATING	50kg max load

Not available for individual sale.
Only available with DR377, DR1000 Series,
DR2000 Series, and DR4000.

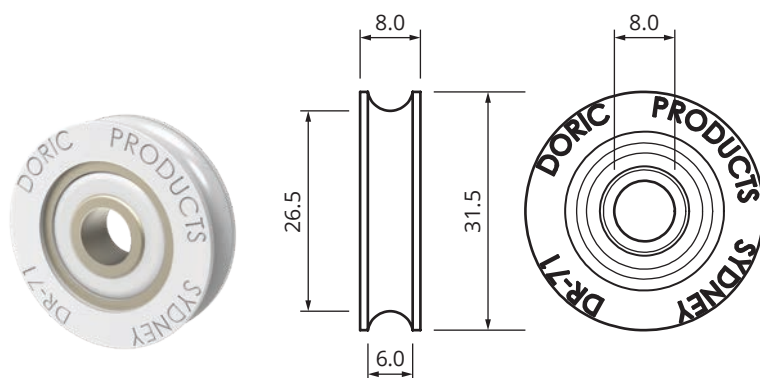

DR78 | DELRIN TYRE WITH BALL BEARING & NO AXLE

TYRE PROFILE	Concave: Groove Width: 6mm
MATERIALS	Tyre: Delrin Race: Passivated Metal
RACE	Precision Bearing
AXLE	8mm - Bore Diameter
WEIGHT RATING	50kg max load

Not available for individual sale.
Only available with DR2200 & DR2100 Series.

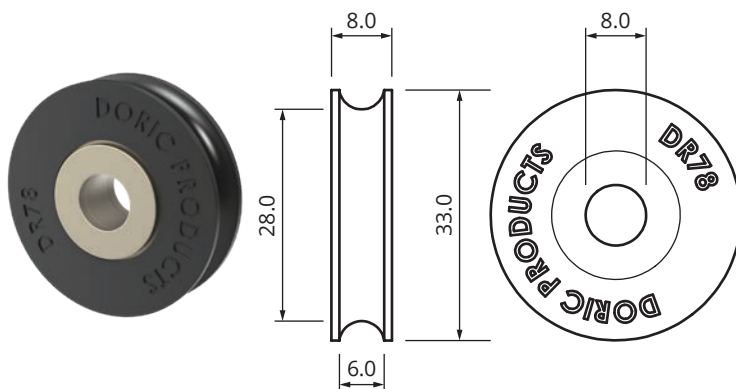

INDEX | ROLLERS & CARRIAGES

CODE	NAME/DESCRIPTION	STD WHEEL	WEIGHT RATING	ORDER CODE	PAGE
DF202	Roller (Made to Order)	DR1	20kg	Contact Us	8
DR1000	Adjustable Door Roller	DR2	20kg	9036686	8
DR1001	Adjustable Door Roller	DR2	20kg	9033971	8
DR1009	Adjustable Timber Door Roller	DR71	50kg	9040456	9
DR137	Heavy Duty Carriage with Guide	DR7	50kg	9001882	9
DR140	Adjustable Mirror Wardrobe Roller	DR35	25kg	9001890	9
DR141	Adjustable Door Carriage	DR26	20kg	9001892	10
DR142	Marine Grade Aluminium Adjustable Window Roller	DR3	15kg	9004570	10
DR2000	Heavy Duty Double Adjustable Door Roller	DR71	100kg	9041707	10
DR2001	Heavy Duty Double Adjustable Door Roller	DR71	100kg	9033996	11
DR2003	Heavy Duty Double Adjustable Door Roller	DR71	100kg	9034035	11
DR2009	Heavy Duty Double Timber Door Roller	DR71	100kg	9040457	11
DR201	Adjustable Door Carriage	DR2	20kg	9001897	12
DR202	Adjustable Door Carriage	DR1	20kg	9000579	12
DR206	Adjustable Door Carriage	DR1/D6	20kg	9001993	12
DR208	Door Carriage	DR25	15kg	9002008	13
DR209	Adjustable Door Carriage	DR2	20kg	9002011	14
DR210	Marine Grade Aluminium Adjustable Door Carriage	DR2	20kg	9002014	14
DR211	Adjustable Door Carriage	DR2	20kg	9002017	14
DR215	Sliding Window Carriage	DR11	10kg	9002031	15
DR216	Sliding Window Guide	DR11	10kg	9002035	15
DR218	Sliding Window Guide	-	-	9002042	15
DR221	Door Carriage	DR1	20kg	9002068	16
DR2210-14	Interlock Heavy Duty Multi-Purpose Roller	DR78	100kg	9108828	16
DR2210-17	Interlock Heavy Duty Multi-Purpose Roller	DR78	100kg	9110028	16
DR222	Adjustable Sliding Window Carriage	DR11	10kg	9002072	17
DR224	Flyscreen Door Carriage	DR25	15kg	9002081	17
DR226	A & B Sliding Window Carriage	DR13	20kg Pair	9003369	17
DR227	Adjustable Security Door Carriage - Non-Spring Loaded	DR2	20kg	9002092	18
DR229	Adjustable Mirror Wardrobe Roller	DR36	20kg	9002097	18
DR230	Heavy Duty Dual Adjustable Door Carriage	DR2	40kg	9002100	18
DR231	Sliding Window Carriage	DR3	15kg	9002101	19

INDEX | ROLLERS & CARRIAGES

CODE	NAME/DESCRIPTION	STD WHEEL	WEIGHT RATING	ORDER CODE	PAGE
DR232	Adjustable Sliding Window Carriage	DR13	10kg	9002103	19
DR234/N	Security Door Roller - Spring Loaded (Hold Open)	DR64	22.5kg	9047909	19
DR234/SL64	Security Door Roller - Spring Loaded	DR64	22.5kg	9012698	20
DR235	Adjustable Flyscreen Door Carriage	DR6	15kg	9002112	20
DR239	Sliding Window Carriage	DR32	12kg	9002120	20
DR240	Adjustable Door Carriage	DR34	20kg	9002121	21
DR244	Adjustable Door Carriage	DR2	20kg	9006488	21
DR245	Adjustable Door Carriage	DR2/D6	20kg	9005093	21
DR247	Adjustable Door Carriage with DR57	DR57	20kg	9008320	24
DR249	Adjustable Sliding Window Carriage	DR13	10kg	9009080	25
DR250	Adjustable Sliding Wardrobe Door Roller	DR62	20kg	9009720	25
DR338	Adjustable Door Carriage	DR4	40kg	9002141	26
DR339	Adjustable Flyscreen Door Corner Stake	DR34	15kg	9002143	27
DR340	Adjustable Security Door Corner Stake	DR6	15kg	9002145	27
DR343	Sliding Window Carriage	DR27	10kg	9002152	27
DR346	Flyscreen Door Roller Hanger Bracket	DR42	10kg	9002161	29
DR347	Sliding Window Carriage	DR18	10kg	9002173	29
DR350	Flyscreen Door Roller Hanger Bracket	DR42	10kg	9002192	30
DR352	Stainless Steel Adjustable Door Carriage	DR2	20kg	9002201	32
DR354	Sliding Window Carriage	DR13	10kg	9002204	32
DR356	Roller Carriage	DR30	25kg	9002209	33
DR357	Bracket	-	-	9002212	33
DR358	Adjustable Door Roller (Right Hand)	DR31	25kg	9041133	33
DR359	Adjustable Door Roller (Left Hand)	DR31	25kg	9041134	34
DR361	Adjustable Door Carriage	DR2	20kg	9002222	34
DR362	Flyscreen Door Roller Hanger Bracket	DR42	10kg	9003378	35
DR369	Aluminium Adjustable Door Carriage	DR2	20kg	9002242	35
DR371	Sliding Window Carriage	DR11	10kg	9002250	35
DR374	Sliding Window Top Guide	-	-	9002524	36
DR377	Adjustable Double Roller Carriage	DR2/D5	40kg	9004477	36
DR4000	Quad Roller	DR71	140kg	9046223	36
DR405	Adjustable Self Aligning Sliding Window Roller	DR63	15kg	9047530	13

INDEX | TYRES & WHEELS

CODE	NAME/DESCRIPTION	TYRE PROFILE	AXLE	WEIGHT RATING	ORDER CODE	PAGE
DR1	Delrin Tyre with Ball Bearing & no Axle	Concave: 5mm	6.5mm - Bore diameter	20kg	9000749	39
DR2 / D5	Delrin Tyre with Ball Bearing & Axle (D5)	Concave: 5mm	6mm - Axle diameter	20kg	9000750	40
DR2 / D6	Delrin Tyre with Ball Bearing & Axle (D6)	Concave: 6mm	6mm - Axle diameter Standard: 15mm length	20kg	9004786	40
DR2 / D6 Short	Delrin Tyre with Ball Bearing & Axle (D6 Short Axle)	Concave: 6mm	6mm - Axle diameter Short: 12mm length	20kg	9005097	40
DR3	Delrin Tyre With Ball Bearing & no Axle	Concave: 5mm	6.5mm - Bore diameter	15kg	9000751	40
DR4	Stainless Steel Tyre with Ball Bearing & Axle	Concave: 6mm	6.5mm - Axle diameter	40kg	9000752	41
DR5	Stainless Steel Tyre with Ball Bearing & Axle	Concave: 5mm	6.5mm - Bore diameter	40kg	Reference only	41
DR6	Delrin Tyre With Ball Bearing & Axle	Concave: 5.5mm	4.5mm - Axle diameter	15kg	9000754	41
DR7	Brass Tyre with no Axle	Flat: 14mm	12mm - Bore diameter	50kg	Reference only	42
DR9	Delrin Tyre with Ball Bearing & Axle	Concave: 3mm	3mm - Axle diameter	10kg	9000757	42
DR11	Delrin Tyre with no Axle	Concave: 3mm	5mm - Bore diameter	10kg	9000759	42
DR12	Delrin Tyre with no Axle	Flat: 4mm	4mm - Bore diameter	10kg	Reference only	43
DR13	Delrin Tyre with no Axle	Concave: 3mm	5mm - Bore diameter	10kg	9000761	43
DR18	Delrin Tyre with no Axle	Concave: 2.5mm	3.5mm - Bore diameter	10kg	Reference only	43
DR25	Delrin Tyre with Ball Bearing & Axle	Concave: 3mm	5mm - Axle diameter	15kg	Reference only	44
DR26	Delrin Tyre with Ball Bearing & Axle	Concave: 5.5mm	6.5mm - Axle diameter	20kg	Reference only	44
DR27	Delrin Tyre with no Axle	Concave: 1.5mm	3.5mm - Bore diameter	10kg	Reference only	44
DR31	Delrin Tyre with no Axle	Concave: 8mm	8mm - Bore diameter	10kg	Reference only	45
DR34	Delrin Tyre with Ball Bearing & Axle	Concave: 5mm	4.5mm - Axle diameter	20kg	9000781	45
DR34	Delrin Tyre with Ball Bearing & Axle	Concave: 5mm	4.5mm - Axle diameter Extended Axle: 12.6mm length	20kg	9010568	45
DR35	Delrin Tyre with Ball Bearing & no Axle	Convex: 8mm	6mm - Bore diameter	25kg	Reference only	45
DR36	Delrin Tyre with Ball Bearing & Axle	Concave: 5.5mm	6mm - Axle diameter	20kg	9000783	46
DR40	Delrin Tyre with Ball Bearing & Hub	Flat: 6mm Hub: 2mm	4.0mm - Bore diameter	10kg	9000785	38
DR42	Delrin Tyre with Ball Bearing & Hub	Convex: 6.5mm Hub: 2mm	4.0mm - Bore diameter	10kg	9000787	38
DR43	Delrin Tyre with Ball Bearing & Hub	Convex: 6mm Hub: 5mm	6.5mm - Bore diameter	10kg	9000788	38
DR44	Delrin Tyre with Ball Bearing & Hub	Convex: 6.5mm Hub: 6mm	3.5mm - Bore diameter	10kg	9000789	39
DR52	Stainless Steel Tyre with Ball Bearing & Axle	Concave: 3mm	5mm - Axle diameter	12kg	9005844	46
DR56	Delrin Tyre with no Axle	Concave: 3mm	5mm - Bore Diameter	10kg	9006963	46
DR58	Delrin Tyre with no Axle	Concave: 2.5mm	5mm - Bore Diameter	10kg	9015259	47
DR62	Delrin Tyre with Ball Bearing & Axle	Convex: 8.5mm	6mm - Axle diameter	20kg	9009719	47
DR63	Delrin Tyre with no Axle	Concave: 3mm	5mm - Bore diameter	10kg	Reference only	47
DR64	Delrin Tyre with Ball Bearing & Axle	Concave: 5mm	6.5mm - Bore diameter	22.5kg	Reference only	48
DR71	Delrin Tyre with Ball Bearing & no Axle	Concave: 6mm	8mm - Bore Diameter	50kg	Reference only	48
DR78	Delrin Tyre with Ball Bearing & no Axle	Concave: 6mm	8mm - Bore Diameter	50kg	Reference only	48
DR135	Hexagon Screws - Pack 1000	-	-	-	9001880	39

INNOVATORS

OF HARDWARE FOR WINDOWS AND DOORS

Rollers Catalogue .v1.3-28.07.2023

SYDNEY

38 Redfern St,
Wetherill Park
Sydney, NSW 2164
Australia
Ph: +61 2 9609 2555
www.doric.com.au

AUCKLAND

26/C Triton Drive,
Albany, North Shore,
Auckland 0632
New Zealand
Ph: +64 9 415 5535
www.doric.co.nz

KUALA LUMPUR

Unit 6, Level 4, SetiaWalk Mall (*Block K*),
SetiaWalk, Persiaran Wawasan,
Pusat Bandar Puchong,
47160 Puchong, Selangor, Malaysia
Ph: +603 8602 2100
www.doric.com.my



ROLLERS | DOOR & WINDOW HARDWARE