



---

# STAYS & RESTRICTORS | AWNING & CASEMENT WINDOW HARDWARE



# STAYS & RESTRICTORS WINDOW HARDWARE



## **ADJUSTABLE** | FRICTION STAYS

PD-8   8" Adjustable Friction Stay	<b>4</b>
PD-10   10" Adjustable Friction Stay	<b>4</b>
PD-12   12" Adjustable Friction Stay	<b>4</b>
PD-16   16" Adjustable Friction Stay	<b>4</b>
PD-20   20" Adjustable Friction Stay	<b>4</b>

## **HEAVY DUTY ADJUSTABLE** | FRICTION STAYS

DN168   10" Heavy Duty Adjustable Friction Stay	<b>5</b>
DN169   16" Heavy Duty Adjustable Friction Stay	<b>5</b>
DN171   20" Heavy Duty Adjustable Friction Stay	<b>5</b>
DN172   24" Heavy Duty Adjustable Friction Stay	<b>5</b>

## **NON-FRICTION** | STAYS

DN236   230mm Non-Friction Stays	<b>6</b>
----------------------------------	----------

## **SAFETY** | STAYS

SS0001   Limiting Stay	<b>7</b>
SS0002   Limiting Stay	<b>7</b>

# ADJUSTABLE | FRICTION STAYS

Manufactured in 304 Austenitic stainless steel to ensure corrosion free performance, with solid core spin riveted components for geometrical accuracy.

## FEATURES

- Non-handed design to enable ease and flexibility of fitting sizes below 20 inches
- Suitable for awning and casement windows
- Polished Surface for smoother operation and ease of clean

## PRODUCT DETAILS

APPLICATION	Awning and casement windows
MATERIAL	304 Stainless steel
PARTS	Channel & Arms
BAR WIDTH	(A) Channel - 18mm (B) Arms - 16mm

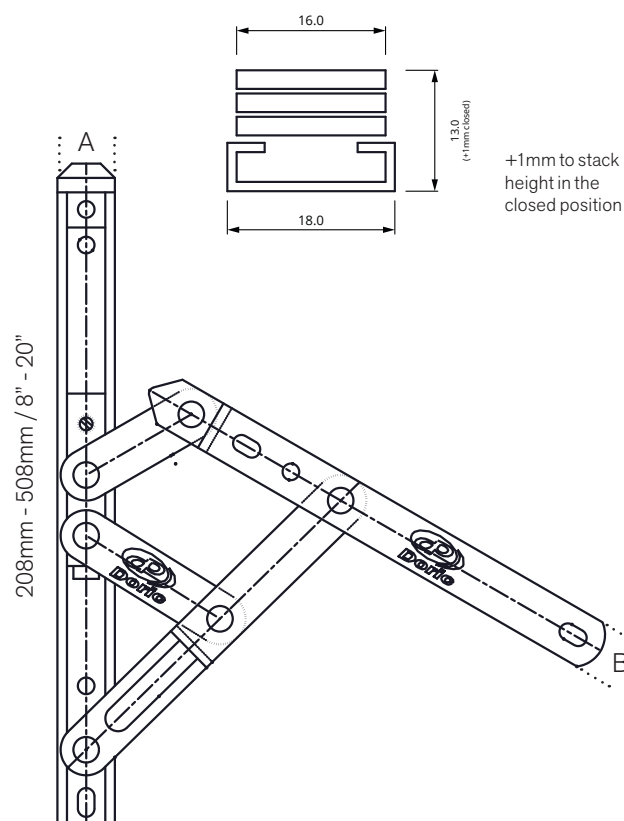

## HOW TO ORDER

### AWNING (TOP HUNG)

ORDER CODE	PRODUCT CODE	SIZE	STACK HEIGHT (+1mm @ close)	MAX VENT HEIGHT	MAX VENT WIDTH	MAX WEIGHT	OPENING
9035341	PD-8	8"	13mm	300mm	1200mm	11kg	60 deg
9035342	PD-10	10"	13mm	400mm	1200mm	16kg	85 deg
9035343	PD-12	12"	13mm	500mm	1200mm	21kg	85 deg
9035344	PD-16	16"	13mm	700mm	1200mm	21kg	87 deg
9042516	PD-20	20"	13mm	900mm	1200mm	28kg	40 deg

### CASEMENT (SIDE HUNG)

ORDER CODE	PRODUCT CODE	SIZE	STACK HEIGHT (+1mm @ close)	MAX VENT HEIGHT	MAX VENT WIDTH	MAX WEIGHT	OPENING
9035341	PD-8	8"	13mm	1400mm	300mm	10kg	60 deg
9035342	PD-10	10"	13mm	1400mm	400mm	12kg	85 deg
9035343	PD-12	12"	13mm	1400mm	500mm	16kg	85 deg
9035344	PD-16	16"	13mm	1400mm	700mm	20kg	87 deg



# HEAVY DUTY ADJUSTABLE | FRICTION STAYS

Doric's heavy duty adjustable friction stays has been designed to suit most commercial & residential awning applications on aluminium, timber and uPVC windows.

## FEATURES

- Suitable for aluminium, timber & uPVC
- DHS available in 16mm stack height
- Large flat bottom slider block screws
- All rivets are spin riveted
- Ensures corrosion free performance
- Ease & flexibility of assembly
- Positive adjustment, with less wear
- Accurate pressure at each joint smoother operation

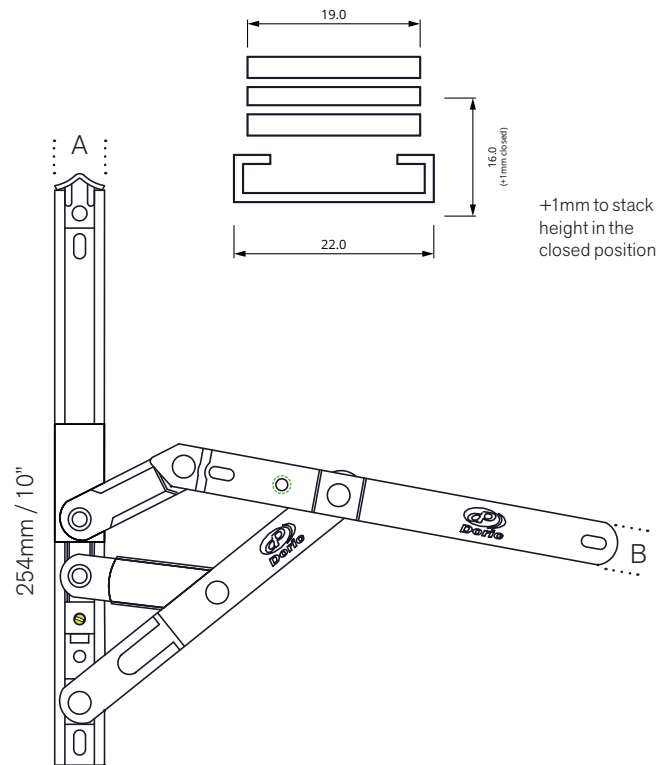

## PRODUCT DETAILS

APPLICATION	Aluminium, timber & uPVC awning and casement windows
MATERIAL	304 Stainless steel
PARTS	Channel & Arms
BAR WIDTH	(A) Channel - 22mm (B) Arms - 19mm

For top hung windows where fall prevention requirements apply, the opening maybe required to be restricted. An additional restrictor can be applied to the window opening.

## HOW TO ORDER

### AWNING (TOP HUNG)

ORDER CODE	PRODUCT CODE	SIZE	WINDOW TYPE	STACK HEIGHT (+1mm @ close)	MAX VENT HEIGHT	MAX VENT WIDTH	MAX WEIGHT
9030632	DN168	10"	Awning	16mm	500mm	1600mm	26kg
9030633	DN169	16"	Awning	16mm	750mm	1800mm	40kg
9044288	DN171	20"	Awning	16mm	1600mm	1600mm	108kg
9044289	DN172	24"	Awning	16mm	1800mm	1800mm	120kg

### CASEMENT (SIDE HUNG)

ORDER CODE	PRODUCT CODE	SIZE	WINDOW TYPE	STACK HEIGHT (+1mm @ close)	MAX VENT HEIGHT	MAX VENT WIDTH	MAX WEIGHT
9030632	DN168	10"	Casement	16mm	1600mm	500mm	28kg
9030633	DN169	16"	Casement	16mm	1800mm	750mm	38kg

## DN236 | 230mm NON-FRICTION STAYS

The DN236 offer a cost-effective option for small awning windows designed primarily for use with security screens. These windows are suitable for areas where limited operational features and minimal concern for wind and water performance are acceptable. Common applications include stairwells, bathrooms, amenities, and covered corridors.

### FEATURES

- Non-handed design
- Suitable for small awning windows
- Economical non-friction stay option



## PRODUCT DETAILS

APPLICATION	Timber & aluminium windows
MATERIAL	Aluminium
FINISH	Mill
STACK HEIGHT	13mm (+1mm @ close)
ORDER CODE	9000622

## HOW TO ORDER

ORDER CODE	PRODUCT CODE
9000622	DN236

## DIMENSIONS

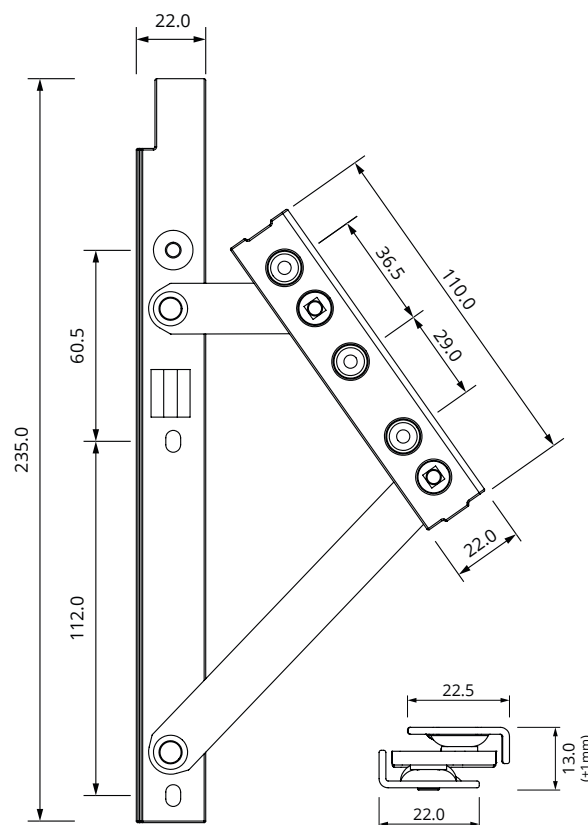

## LIMITING | STAYS

Doric Limiting Stays are specifically manufactured to meet the needs of both residential and commercial awning applications, and are constructed from durable 304 stainless steel to ensure an exceptional operational lifespan.

Limiting Stays are not to be used in 'Kids Don't Fly' applications without window system testing.

### FEATURES

- Non-handed design
- Smooth operation

### ADVANTAGES

- Easy to install,
- Easy to clean



## SS0001 | LIMITING STAY

APPLICATION	Aluminium, timber and uVPC awning windows
MATERIAL	304 Stainless steel
STACK HEIGHT	13mm (+1mm @ close)
MAX EXTENSION	162mm
ORDER CODE	9042517

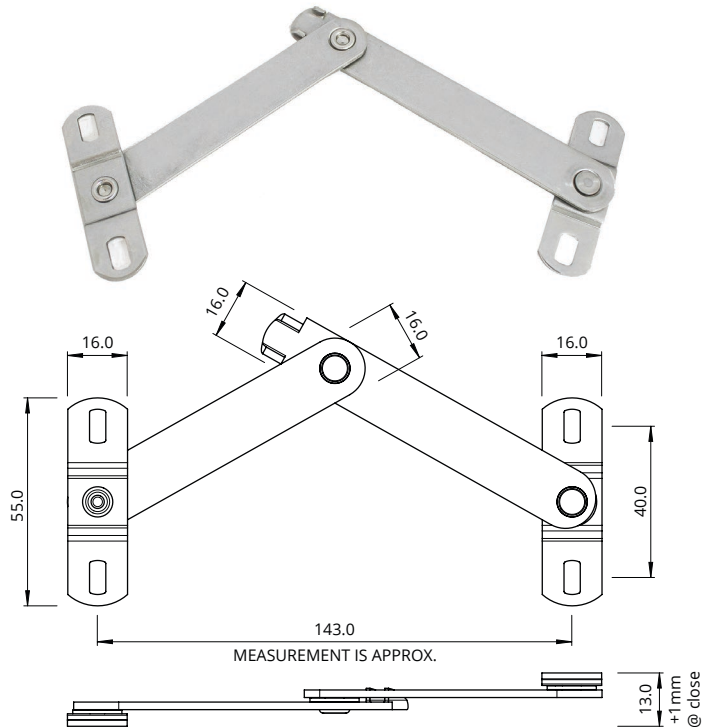

## SS0002 | LIMITING STAY

APPLICATION	Aluminium, timber and uVPC awning windows
MATERIAL	304 Stainless steel
STACK HEIGHT	11.0mm (+1mm @ close)
MAX EXTENSION	128mm
ORDER CODE	9046615

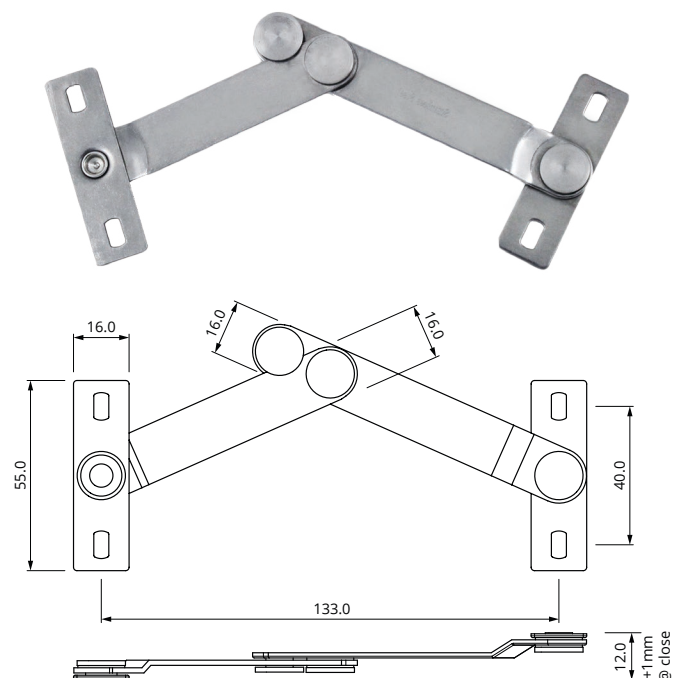

# INNOVATORS

OF HARDWARE FOR WINDOWS AND DOORS

---

Stays & Restrictors Catalogue v1.6-15.02.2024

## SYDNEY

38 Redfern St,  
Wetherill Park  
Sydney, NSW 2164  
Australia  
Ph: +61 2 9609 2555  
[www.doric.com.au](http://www.doric.com.au)

## AUCKLAND

26/C Triton Drive,  
Albany, North Shore,  
Auckland 0632  
New Zealand  
Ph: +64 9 415 5535  
[www.doric.co.nz](http://www.doric.co.nz)

## KUALA LUMPUR

Unit 6, Level 4, SetiaWalk Mall (*Block K*),  
SetiaWalk, Persiaran Wawasan,  
Pusat Bandar Puchong,  
47160 Puchong, Selangor, Malaysia  
Ph: +603 8602 2100  
[www.doric.com.my](http://www.doric.com.my)



---

# STAYS & RESTRICTORS

AWNING & CASEMENT  
WINDOW HARDWARE