



**WINDOW**

**LOCKS, LATCHES  
& ACCESSORIES**





# WINDOW LOCKS, LATCHES & ACCESSORIES



## **AWNING & CASEMENT** | WINDOW OPERATORS, LOCKS & HARDWARE

DS1   Chainwinder	<b>4</b>
DS1 Sal   Special Access Lever Chainwinder	<b>6</b>
DN400   Twin Chainwinder	<b>8</b>
DN450   MKII Twin Chainwinder	<b>10</b>
OMEGA   DS5500 Awning Operator	<b>12</b>
Chainwinder Brackets	<b>14</b>
DT3   Sterling Keyed Casement Fastener Lh & Rh	<b>15</b>
DS776/DS777   Awning Window Locks	<b>16</b>

## **SLIDING WINDOWS** | LOCKS, LATCHES & HARDWARE

DN560   Mortice Sliding Window Lock	<b>18</b>
LOCKS & LATCHES   Sliding Window Hardware	<b>20</b>
RESTRICTORS   Sliding Window Hardware	<b>31</b>

## **DOUBLE HUNG** | WINDOW LOCKS & HARDWARE **32**

## **FLYSCREEN** | HARDWARE & ACCESSORIES **38**

## **ACCESSORIES** | WINDOW HARDWARE **40**

## **PUBLIC WORKS** | WINDOW HARDWARE **41**

# DS1 | CHAINWINDER

The DS1 is the most durable single window winder in the market, complete with innovation. Designed for use in residential and commercial applications, this product changed the way in which awning windows are specified.

The DS1 Chainwinder allows for easy operation and installation, and available in either a secure key lockable configuration, or non-keyed version. Combined with a stylish and easy to use slim fold down lever, this product delivers ultimate window control.

The DS1 Chainwinder can be pre-restricted where compliance is required with the NCC and 'Kids Don't Fly'.



## FEATURES

- Inbuilt Restriction Switch to easily restrict chain length where window restriction is required
- Allows you to clearly see if the winder is in the locked or unlocked position
- Easylink - a simple one way fitment to simplify installation reducing installation time

## ADVANTAGES

- Designed to compliment the shape of the winder. Simply pull to fold down
- Can be keyed alike to other Doric window or door products
- Handle can be orientated to match other winders in the house. Simply loosen handle grub screw and re-secure handle in the desired position

## PRODUCT DETAILS

<b>MATERIALS</b>	Polesium™ base & housing, Stainless steel chain standard
<b>FINISH</b>	Powder coat
<b>CYLINDER</b>	DS125 - 5 Disc Wafer DS126 - 6 Disc Wafer DS127 - Multi Key Cylinder
<b>KEYING</b>	Keyed alike or keyed to differ #27001 - #27020

## COLOURS



## TESTING

- Cycle tested on a 30kg window to over 30,000 cycles
- Tested and surpassed ultimate chain pull test achieving 3403N
- Tested and surpassed Neutral Salt and Spray test under AS-2331

## ASSOCIATED HARDWARE

### DS174N | CHAINWINDER 8MM BRACKET

<b>MATERIALS</b>	Polesium™	
<b>CODE</b>	MDS174N	

### DS1176 | CHAINWINDER 20MM BRACKET

<b>MATERIALS</b>	Polesium™	
<b>CODE</b>	MDS1176	



## DIMENSIONS

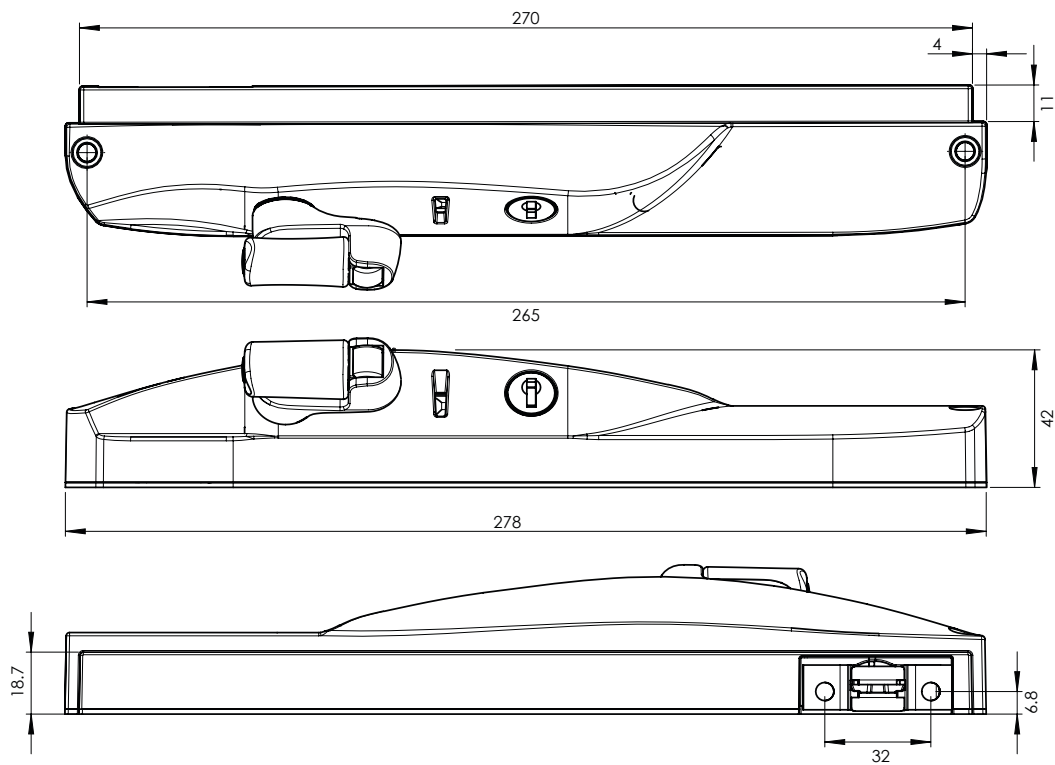

## HOW TO ORDER

CODE	PRODUCT	FINISH	CYLINDER
MDS1	DS1 (Keyed)	Powder coat	DS125 or DS126
MDS2	DS2 (Non-Keyed)	Powder coat	-

# DS1 SAL | SPECIAL ACCESS LEVER CHAINWINDER

The DS1 with a Special Access Lever handle makes the most durable single window winder in the market, accessible to more people.

It's the ideal hardware component that allows users with limited dexterity and strength to more easily open windows.

The DS1 Special Access Lever (SAL) features the inclusion of a spherical grip handle onto the market leading DS1 Chainwinder. The versatile SAL can also be fitted to the DS2 & DN400 Twin Chainwinder.



## FEATURES

- Larger designed spherical grip handle for those with limited dexterity and strength
- Inbuilt Restriction Switch to easily restrict chain length where window restriction is required
- Allows you to clearly see if the winder is in the locked or unlocked position
- Easylink - a simple one way fitment to simplify installation reducing installation time

## ADVANTAGES

- Designed to compliment the shape of the winder. Simply pull to fold down
- Can be keyed alike to other Doric window or door products
- Handle can be orientated to match other winders in the house. Simply loosen handle grub screw and re-secure handle in the desired position

## PRODUCT DETAILS

<b>MATERIALS</b>	Polesium™ base & housing, Stainless steel chain standard
<b>FINISH</b>	Powder coat
<b>CYLINDER</b>	DS125 - 5 Disc Wafer DS126 - 6 Disc Wafer DS127 - Multi Key Cylinder
<b>KEYING</b>	Keyed alike or keyed to differ #27001 - #27020

## COLOURS



## TESTING

- Cycle tested on a 30kg window to over 30,000 cycles
- Tested and surpassed ultimate chain pull test achieving 3403N

## ASSOCIATED HARDWARE

### DS174N | CHAINWINDER 8MM BRACKET

<b>MATERIALS</b>	Polesium™	
<b>CODE</b>	MDS174N	

### DS1176 | CHAINWINDER 20MM BRACKET

<b>MATERIALS</b>	Polesium™	
<b>CODE</b>	MDS1176	



## DIMENSIONS

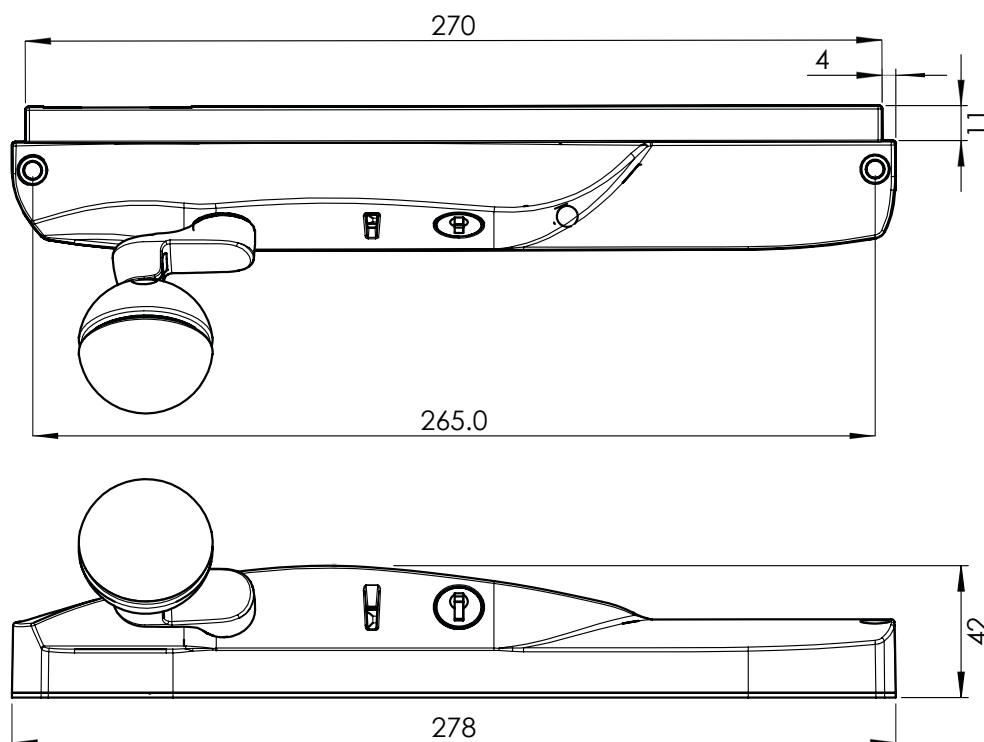

## HOW TO ORDER

CODE	PRODUCT	FINISH	CYLINDER
MDS1	Keyed Special Access Lever Chainwinder	Powder coat	DS126
MDS2	Non-Keyed Special Access Lever Chainwinder	Powder coat	-

# DN400 | TWIN CHAINWINDER

The DN400 Twin Chainwinder is the ultimate window control for large awning windows designed for use in both residential and commercial applications.

The DN400 Twin Chainwinder allows for easy operation and installation it features slim fold down lever, compatible with the SAL lever design and available in either a secure key lockable configuration and a non-keyed version.

The DN400 Twin Chainwinder can be pre-restricted in order to comply with the NCC and to meet the requirements of 'Kids Don't Fly'.



## FEATURES

- Stainless steel chain for corrosion resistance
- Removable chain from sash plate to aid installation and to assist in cleaning – “Chain Secure”
- Simple fold down lever which can be oriented to match all other winders

## ADVANTAGES

- Chain pitching offers greater control for larger windows
- Smooth, effortless operation and control for large awning openings
- Window restriction compliant in association with Kids Don't Fly

## PRODUCT DETAILS

<b>MATERIALS</b>	Zinc die-cast housing, Stainless steel chain standard
<b>FINISHES AVAILABLE</b>	Black, White, Silver & custom colours on request
<b>CYLINDER</b>	DS94 - 6 Disc Wafer DS187 - 4 Pin Cylinder DS187/1 - Multi Key Cylinder

## COLOURS



## TESTING

- Tested & surpassed over 5000 pascals of negative pressure
- Tested and surpassed Neutral Salt and Spray test under AS-2331.31
- The DN400 does not have a weight or load rating. Will easily operate within a sash up to and beyond 100kg when used in conjunction with the Doric Heavy Duty Stainless steel stays or any continuous hinge framing system.

## HOW TO ORDER

CODE	PRODUCT	FINISH	CYLINDER
MDN400	DN400 (Keyed)	Powder coat	DS125 or DS126
MDN402	DN402 (Non-Keyed)	Powder coat	N/A



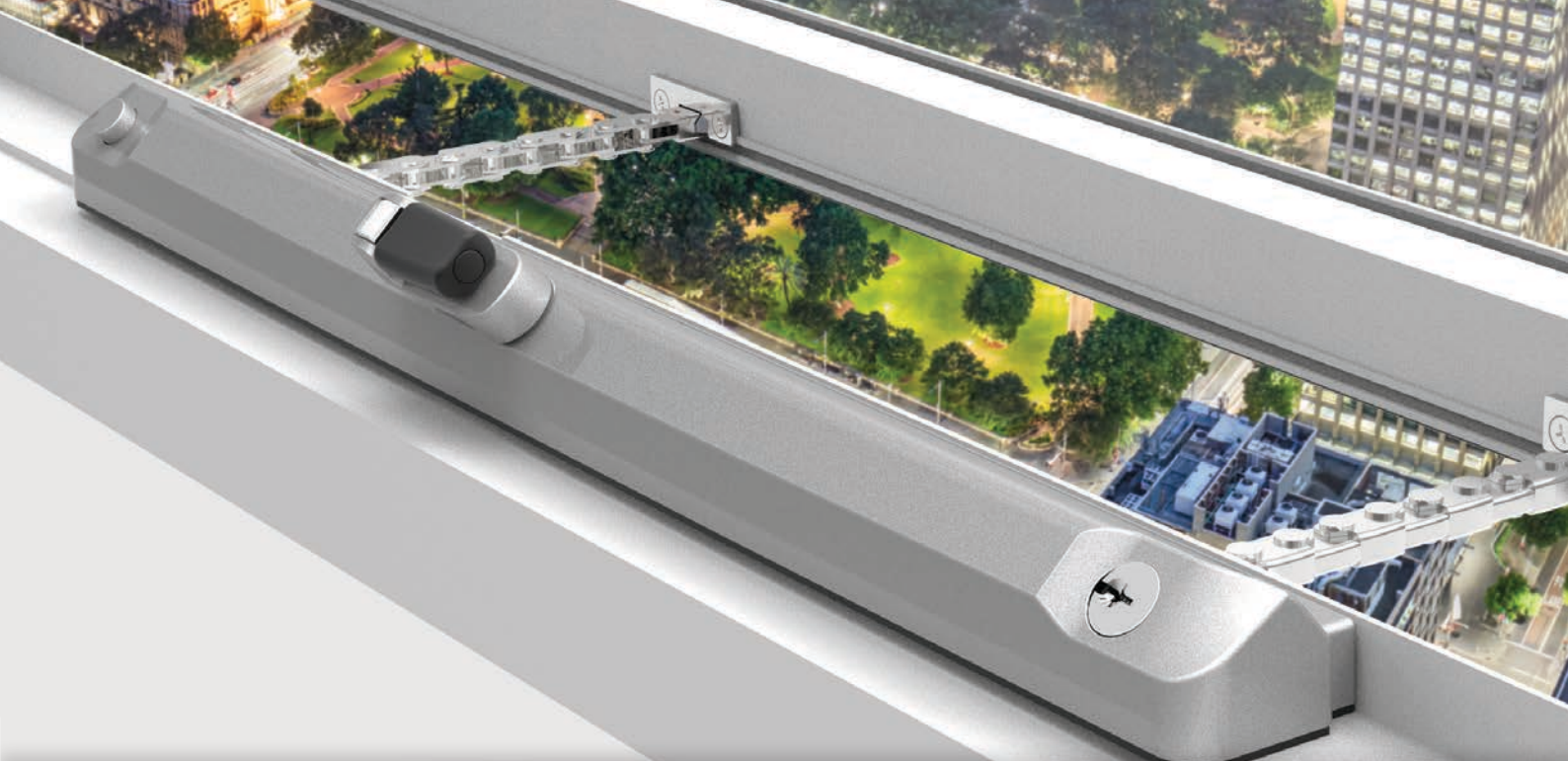

## DIMENSIONS

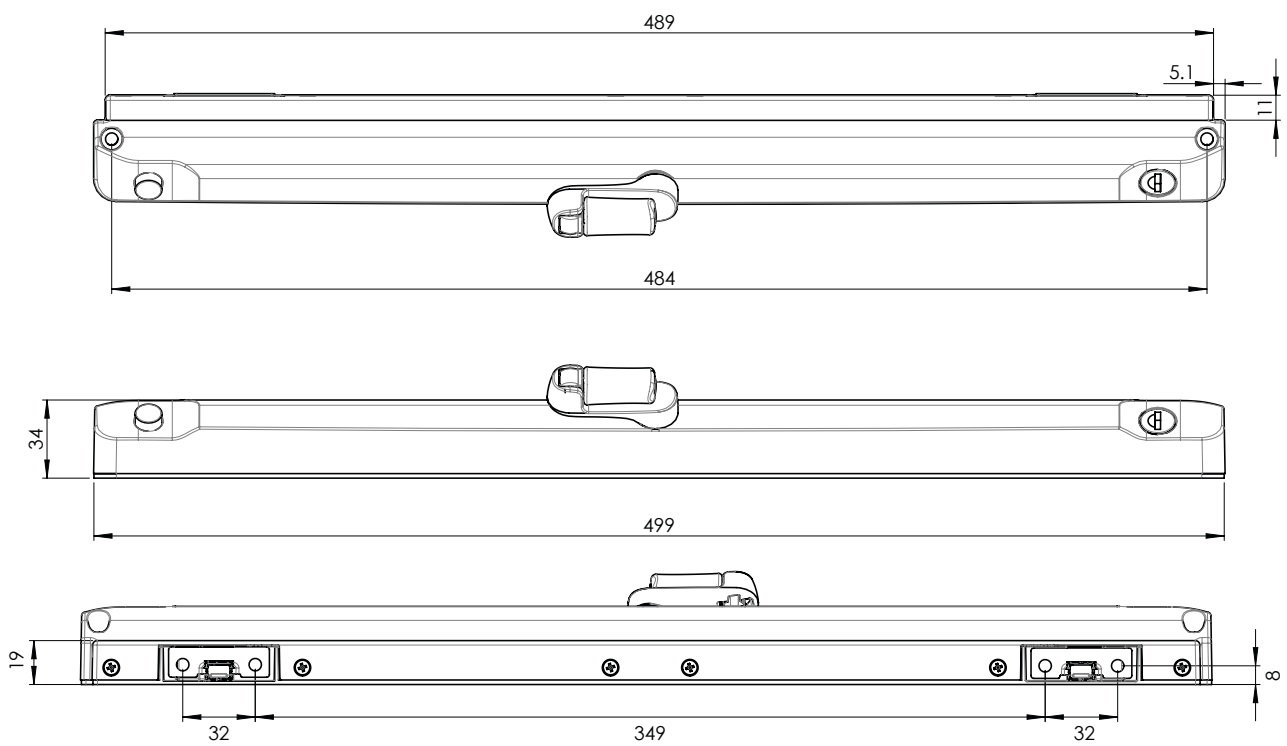

# DN450 | MKII TWIN CHAINWINDER

The DN450 MkII Twin Chainwinder improves upon Doric's DN400 Twin Chainwinder, boasting new features for superior awning window control.

Made with an extruded aluminum body, it seamlessly blends into any environment and surpasses corrosion resistance standards. Its adjustable chain restriction makes it adaptable for residential and commercial use, meeting NCC standards and ICP 005 compliance.



## FEATURES

- Stainless steel chain for corrosion resistance
- Easylink - a simple one way fitment to simplify installation reducing installation time
- Simple fold down lever which can be oriented to match all other winders

## ADVANTAGES

- Larger chain pitching (600mm) allows the chain to be mounted closer to the corners of a window
- Adjustable Chain Restriction - Limit Openings From 110mm To 265mm
- Window restriction compliant

## PRODUCT DETAILS

<b>MATERIALS</b>	Extruded aluminium body, Zinc & Polesium™ Fold Down Lever Stainless steel Chain & Sash Plate
<b>FINISHES AVAILABLE</b>	Standard & Non-Standard Powder coat colours
<b>CYLINDER</b>	DS126 - 6 Disc Wafer Cylinder DS125 - 5 Disc Wafer Cylinder DS127 - Multi-Key Cylinder

## COLOURS



## TESTING

- Cycle Test - ICP 002 - Functionality test according to ICP 002: Completed & surpassed
- Ultimate Pull Test - Completed and surpassed 5800N
- Maximum Handle Torque Tests:  
Open - Tested on handle in unlocked and open position: Completed & surpassed 7.42N  
Deadlocked - Tested on handle & lockbar in deadlocked configuration: Completed & surpassed 21.26N

## HOW TO ORDER

CODE	PRODUCT	FINISH	CYLINDER
MDN450	MDN450 Keyed	Powder coat: Black, White, Silver, Non-Standard	DS125 DS126 DS127
MDN450	MDN451 Non-Keyed	Powder coat: Black, White, Silver, Non-Standard	-



# DIMENSIONS

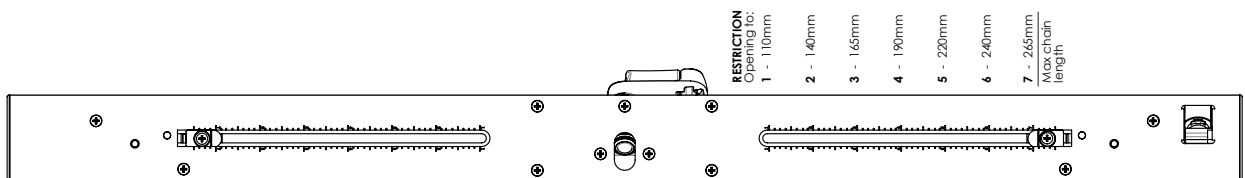
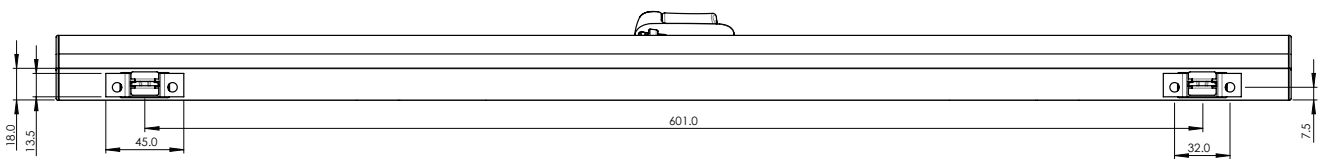
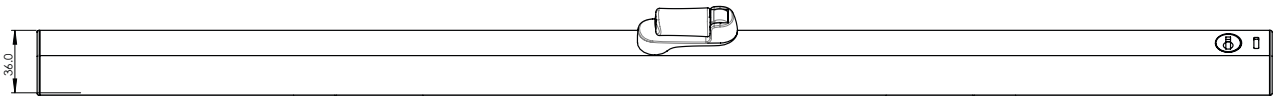
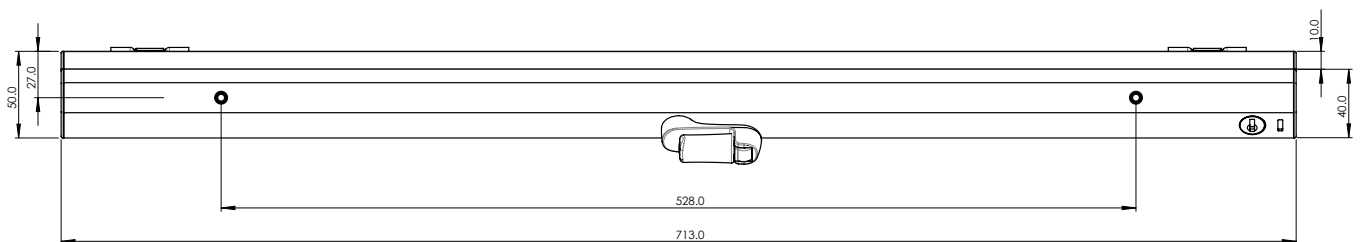

**RESTRICTION**  
 Opening to:  
 1 - 110mm  
 2 - 140mm  
 3 - 165mm  
 4 - 190mm  
 5 - 220mm  
 6 - 240mm  
 7 - 265mm  
 Max chain length

# OMEGA | DS5500 AWNING OPERATOR

The Omega Awning Operator by Doric is an advanced solution tailored to meet the increasing popularity of awning windows, while also enhancing operational efficiency. With its Push & Pull operation, it reduces the time needed to open or close awning windows by half.

Available in 90mm or 150mm arm lengths, the Omega is designed for residential applications, with the 90mm arm specifically catering to compliance with NCC and "Kids Don't Fly" window restriction requirements.



## FEATURES

- Cylinder drives hidden lock bar, which in turn locks off the push button mechanism to prevent tampering
- Available in either keyed or non-keyed options. Suitable with Doric's DS125, DS126 & Multi-Key wafer cylinders.
- Available in both restricted & non-restricted variants

## ADVANTAGES

- Push button mechanism improves functionality by halving the time to open or close an awning window.
- Smooth, effortless operation and control for large awning openings
- Window restriction compliant

## PRODUCT DETAILS

<b>MATERIALS</b>	Polesium™ Cover & Base, Polycarbonate Arm with SS 304 sash plate.
<b>FINISHES AVAILABLE</b>	Standard Moulded Colours STD & Non STD Powder coat
<b>LENGTHS AVAILABLE</b>	90mm arm (Restricted opening) 150mm arm (Full opening)

## COLOURS

- MOULDED BLACK
- MOULDED SILVER
- CUSTOM ON REQUEST

## TESTING

- Cycle Test - Functionality test according to ICP 002, completed & surpassed 10,000 operations
- Ultimate Tensile Pull Test - Completed and surpassed 1452N
- Shear Load Test - Tested on handle in open position, completed and surpassed 10kg of force

## HOW TO ORDER

CODE	PRODUCT	FINISH	ARM LENGTH	CYLINDER & PLUG
MDS5500	OMEGA DS5500	Moulded Black Moulded White Custom (Powder coat)	90mm 150mm	DS125 DS126 DS127 DS515 Plug





# DIMENSIONS

OMEGA 90mm

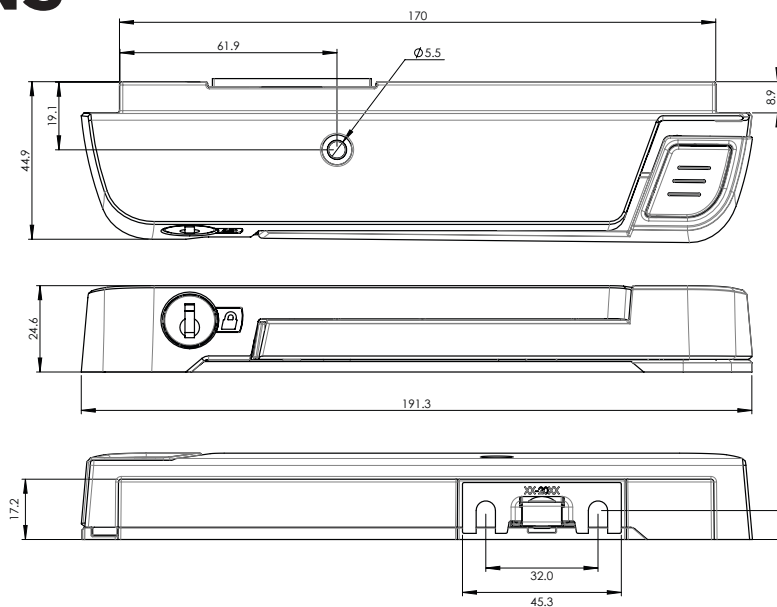

OMEGA 150mm

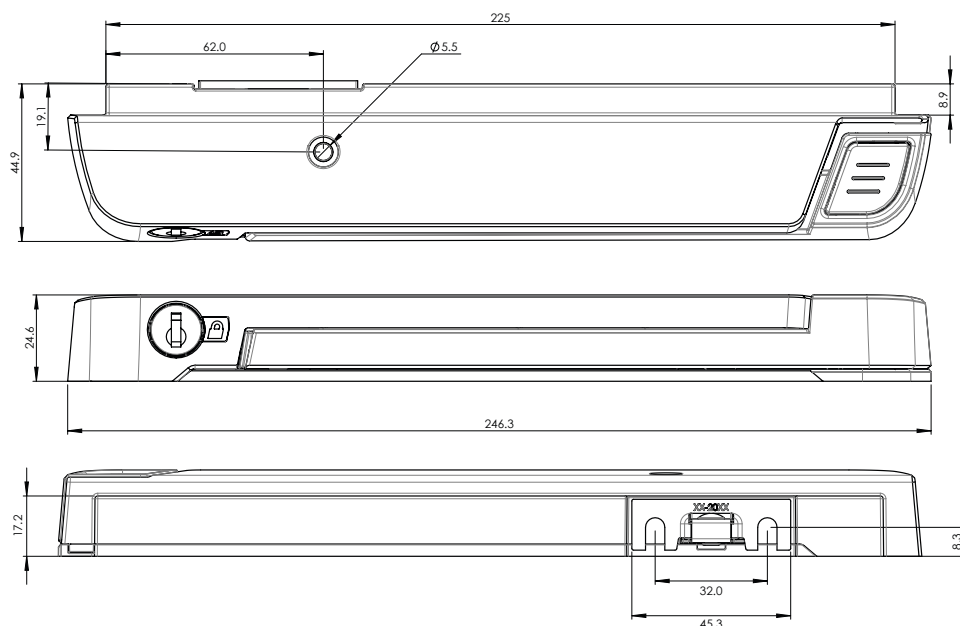

## DS174N | CHAINWINDER 8mm BRACKET

SUITS	DS1, DS1SAL
MATERIAL	Polesium™
FINISH	Mill Finish
ORDER CODE	MDS174N



## DS1176 | CHAINWINDER 20mm BRACKET

SUITS	DS1, DS1SAL
MATERIAL	Polesium™
FINISH	Mill Finish
ORDER CODE	MDS1176



## 9049270 | CHAINWINDER 3mm BRACKET

SUITS	DS1, DS1SAL, DS2 & DS1W
MATERIAL	Polesium™
FINISH	Mill Finish
ORDER CODE	9049270

# DT3 | STERLING KEYED CASEMENT FASTENER LH & RH

The Sterling Series casement fasteners are designed with both function and aesthetics in mind.

Their sleek contemporary design does not overlap the glass when in the closed position, further enhancing the view.

All fixing screw locations have been positioned to compliment modern weather seal locations.

## ADVANTAGES

- Suitable for use on casement and awning windows
- Stylish contemporary design
- Easy to operate lever handle mechanism
- Available in both Right and Left Hand versions



## PRODUCT DETAILS

<b>APPLICATION</b>	Suits both Timber and Aluminium windows
<b>MATERIALS</b>	Zinc
<b>FINISHES</b>	Satin nickel, PVD or Powder coat
<b>HANDING</b>	LH left hand, or RH right hand
<b>FIXINGS</b>	8G screws (not included)
<b>CYLINDER</b>	DS125
<b>STRIKE</b>	Diecast universal strike, hole setback 15mm to clear weather seal.

## COLOURS



## HANDING



Left Handed (LH)

Right Handed (RH)

## HOW TO ORDER

CODE	FINISH	HANDING	CYLINDER
MDT3	Powder coat, or Plated	LH, or RH	DS125

## DIMENSIONS

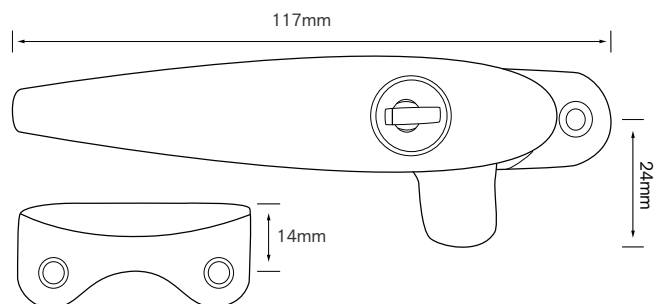

# DS776/DS777 | AWNING WINDOW LOCKS

This modern handle design is not only visually appealing, it has been manufactured from a die-cast zinc body which delivers strength and durability, two characteristics that will ensure your piece of mind once the window has been secured.

Actuated by a Stainless steel spring mechanism, these cam free awning & casement window handles will compliment all residential and commercial window applications.



## ADVANTAGES

- Suitable for use on casement and awning windows
- Stylish contemporary design
- Easy to operate lever handle mechanism
- Available in both Right and Left Hand versions

## FEATURES

- Manufactured from die-cast Zinc
- Wedge actuation controlled by Stainless steel spring mechanism
- Key locking compatible with other Doric window and door products

## PRODUCT DETAILS

<b>MATERIALS</b>	Zinc
<b>FINISHES</b>	Powder coat with T3 coating
<b>HANDING</b>	LH left hand, or RH right hand
<b>FIXINGS</b>	8G screws (not included)
<b>CYLINDER</b>	DS123 or DS124
<b>ACCESSORIES</b>	2mm Packer

## COLOURS



BLACK



WHITE



SILVER

## HANDING



Left Handed (LH)



Right Handed (RH)

## TESTING

- Strength tested in accordance with Australian Standards
- Testing to 1000 hours (Neutral salt spray)

## DS776 | Non Keyed



## DS777 | Keyed







## DIMENSIONS

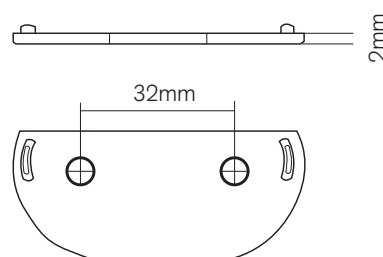
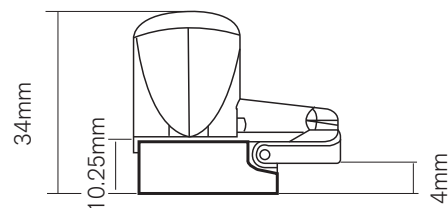
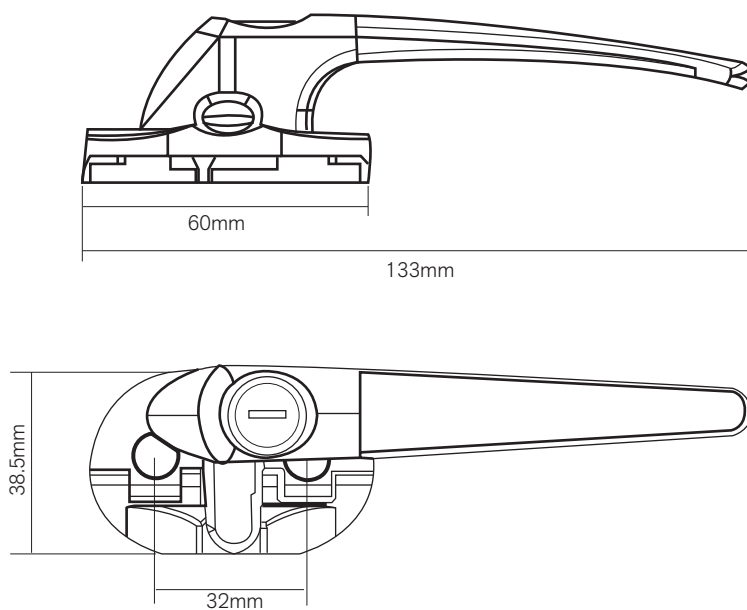

## HOW TO ORDER

CODE	PRODUCT	FINISH	HANDING	CYLINDER
DS776	DS776 - Non Keyed	Black, White, Silver	LH, or RH	-
DS777	DS777 - Keyed	Black, White, Silver	LH, or RH	DS123, or DS124

# DN560 | MORTICE SLIDING WINDOW LOCK

The Doric DN560 slimline mortice window lock is designed for sliding aluminium windows to create a smooth, clean and sleek quality finish in a residential and commercial setting.

The DN560 is a slim low profile lock for sliding windows that incorporates a push and slide type feature to open and close the window.

With luxurious and modern styling the DN560 is the perfect compliment for windows that demand style.

## ADVANTAGES

- Concealed fixing
- Self latching with adjustable latch tongue
- Compact window lock with recessed finger grab
- Neat low profile appearance
- Performance tested to 50,000 cycles



DN560  
Keyed

DN561  
Non-Keyed

## PRODUCT DETAILS

<b>FURNITURE MATERIAL</b>	Aluminium
<b>FINISH AVAILABLE</b>	Powder coat
<b>CYLINDER</b>	DS125 or DS126

### COLOURS

- BLACK
- WHITE
- SILVER
- CUSTOM ON REQUEST

### TESTING

- Performance tested to 50,000 cycles

## HOW TO ORDER

CODE	PRODUCT	FINISH	CYLINDER
MDN560	DN560 - Keyed	Black, White, Silver, Custom	DS125, or DS126
MDN561	DN561 - Non Keyed	Black, White, Silver, Custom	DS515 Cyl. plug



# DIMENSIONS

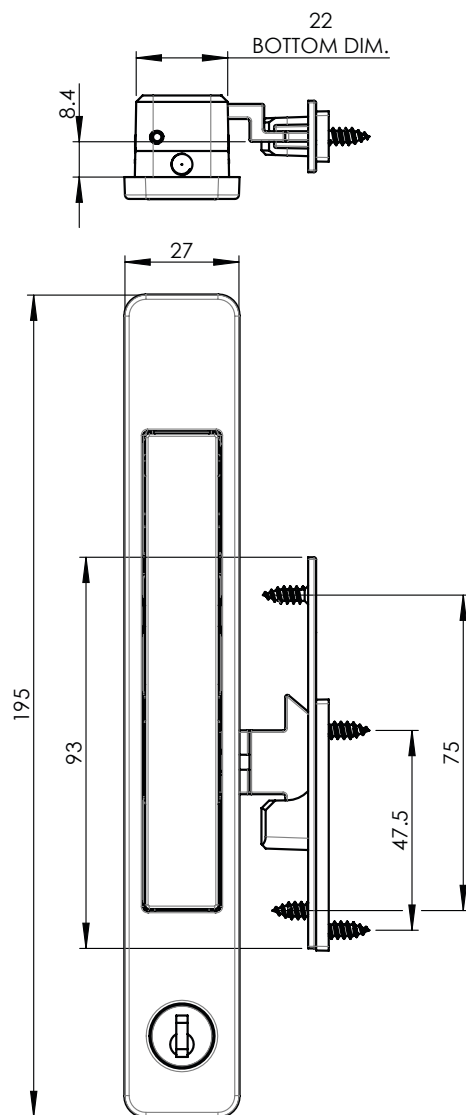
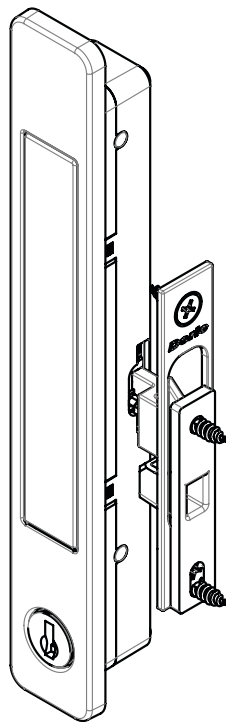
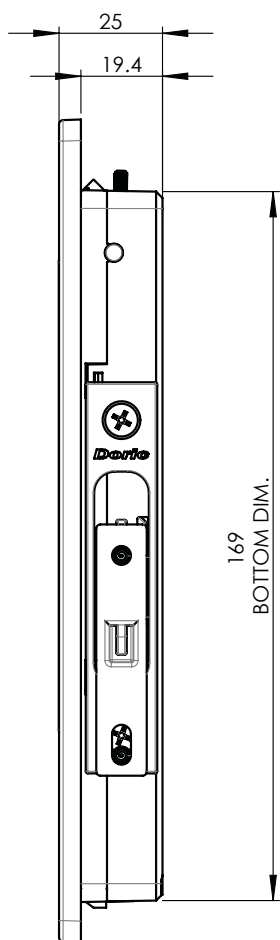

# SLIDING WINDOW | LOCKS & LATCHES

## DS332 | SLIDING WINDOW LATCH

<b>MATERIAL</b>	Polesium™
<b>FINISHES</b>	Moulded Black
<b>ORDER CODE</b>	MDS332

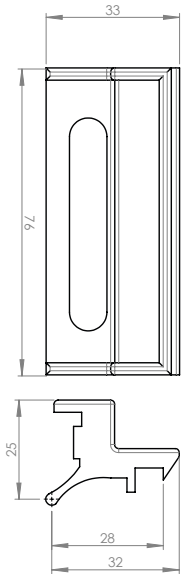
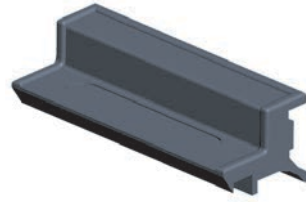

## DS371U | UNIVERSAL SLIDING WINDOW KEYED LATCH

The DS371U is a sliding window keyed latch. It suits some residential aluminium window frames.

Manufactured from Doric's Polesium™ ensures a high level of corrosion resistance in a variety of harsh environments and can be ordered in a mill finish or powder coated that provides an optimum long lasting finish. The DS371U features an adjustable cam that allows for different tolerances to suit a variety of window suites.

### ADVANTAGES

- Adjustable cam to allow for different tolerances to suit a variety of window suites.
- Available with high quality powder coat standard colours and non-standard on request, or Mill finish.
- Corrosion Resistant – Manufactured from engineered plastics to ensure performance in a variety of harsh environments.

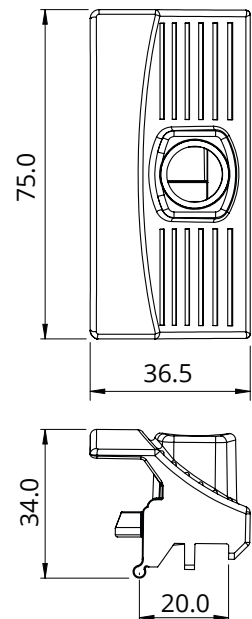

## PRODUCT DETAILS

<b>MATERIAL</b>	Polesium™
<b>FINISHES</b>	Moulded Black
<b>CYLINDER</b>	DS125 or DS126
<b>ORDER CODE</b>	MDS371/U

### COLOURS



BLACK



SILVER



WHITE



CUSTOM  
ON REQUEST



## DS385 | SLIDING WINDOW LATCH

<b>MATERIAL</b>	Polesium™
<b>FINISHES</b>	Moulded Black
<b>FIXINGS</b>	10G screws (not included)
<b>BASE HEIGHT OPTIONS</b>	Thin - 5mm Thick - 7mm
<b>ORDER CODE</b>	MDS385

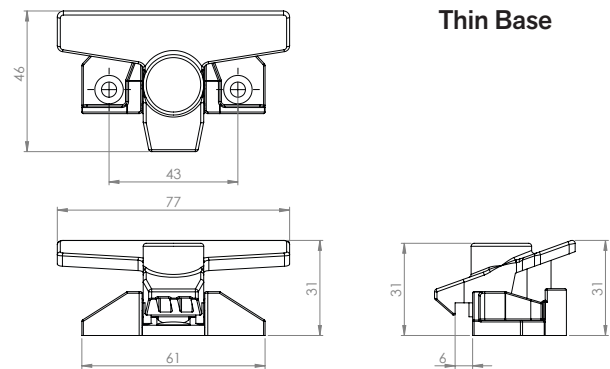
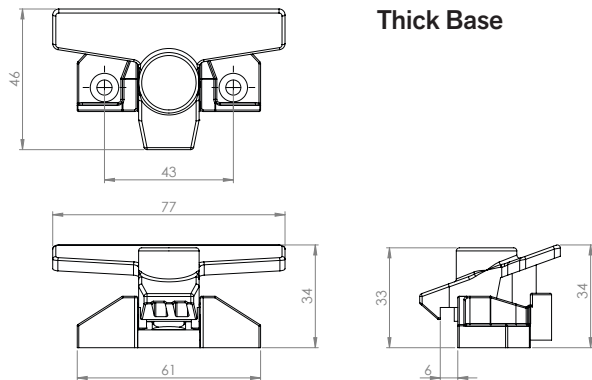
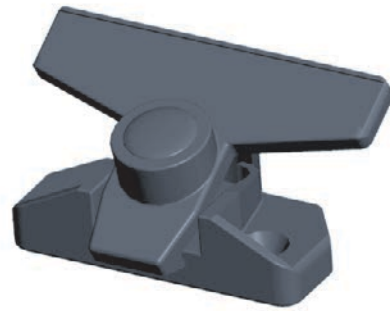

## DS400 | SLIDING WINDOW KEYED LATCH

<b>MATERIAL</b>	Polesium™
<b>FINISHES</b>	Moulded Black
<b>FIXINGS</b>	10G screws (not included)
<b>BASE HEIGHT OPTIONS</b>	Thin - 5mm Thick - 7mm
<b>CYLINDER</b>	DS125 or DS126
<b>ORDER CODE</b>	MDS400

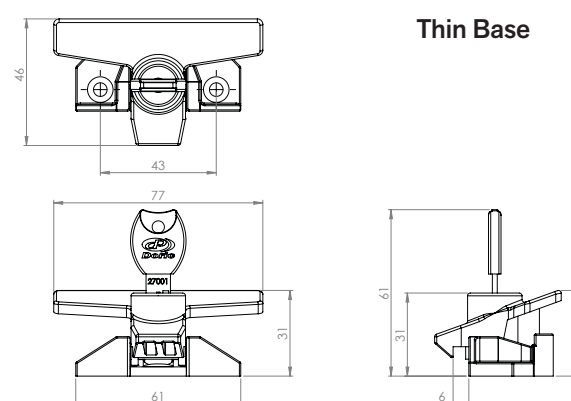
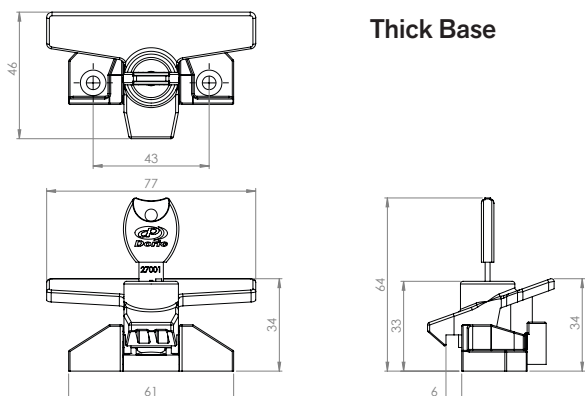

## DS401 | SLIDING WINDOW KEYED LATCH

<b>MATERIAL</b>	Polesium™
<b>FINISHES</b>	Moulded Black
<b>CYLINDER</b>	DS125 or DS126
<b>ORDER CODE</b>	MDS401

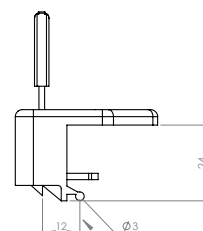
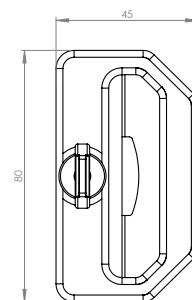

## DS403 | SLIDING WINDOW KEYED LATCH

<b>MATERIAL</b>	Polesium™
<b>FINISHES</b>	Moulded Black
<b>CYLINDER</b>	DS125 or DS126
<b>ORDER CODE</b>	MDS403

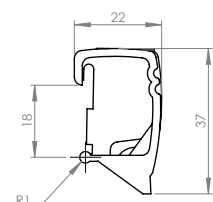
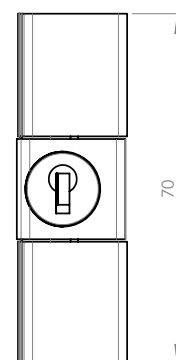

## DS404N | SLIDING WINDOW KEYED LATCH

<b>MATERIAL</b>	Polesium™
<b>FINISHES</b>	Moulded Black
<b>CYLINDER</b>	DS125 or DS126
<b>ORDER CODE</b>	MDS404N

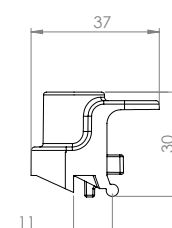
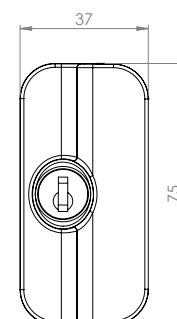

## DS406 | SLIDING WINDOW KEYED LATCH

<b>MATERIAL</b>	Polesium™
<b>FINISHES</b>	Moulded Black
<b>CYLINDER</b>	DS125 or DS126
<b>ORDER CODE</b>	MDS406

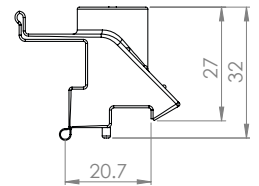
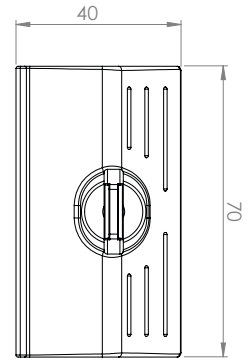
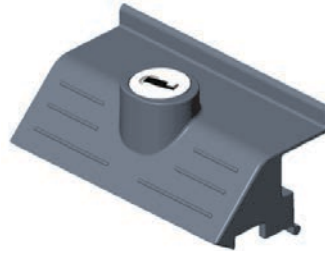

## DS407 | SLIDING WINDOW KEYED LATCH

<b>MATERIAL</b>	Polesium™
<b>FINISHES</b>	Moulded Black
<b>CYLINDER</b>	DS125 or DS126 or DS515 Cyl. Plug (non-Keyed)
<b>ORDER CODE</b>	MDS407

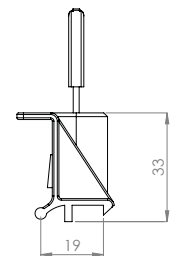
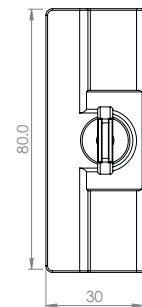
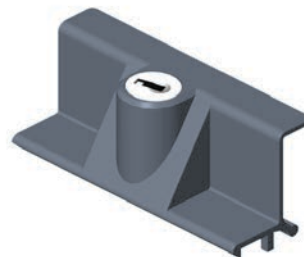

## DS408 | SLIDING WINDOW KEYED LATCH

The DS408 is a sliding window keyed latch that features an adjustable cam that allows for different tolerances to suit some residential aluminium window frames.

<b>MATERIAL</b>	Polesium™
<b>FINISHES</b>	Moulded Black
<b>CYLINDER</b>	DS125 or DS126
<b>ORDER CODE</b>	MDS408

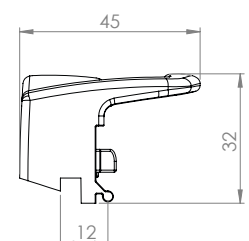
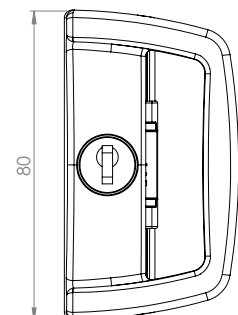

## DS409 | SLIDING WINDOW KEYED LATCH

<b>MATERIAL</b>	Polesium™
<b>FINISHES</b>	Moulded Black
<b>CYLINDER</b>	DS125 or DS126 or DS515 Cyl. Plug (non-Keyed)
<b>ORDER CODE</b>	MDS409

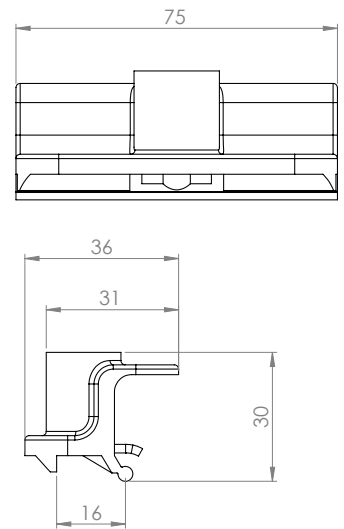

## DS412 | SLIDING WINDOW KEYED LATCH

<b>MATERIAL</b>	Polesium™
<b>FINISHES</b>	Moulded Black
<b>CYLINDER</b>	DS125 or DS126
<b>ORDER CODE</b>	DS125 - 9048694 DS153 - 9048339 MDS412

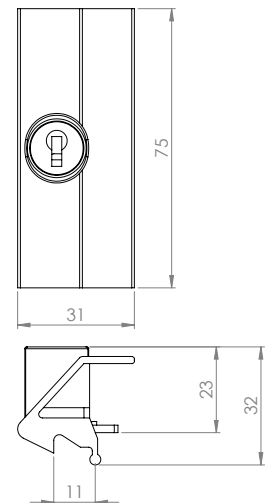
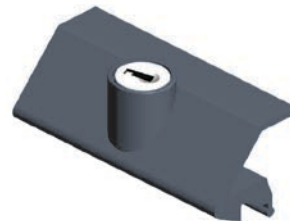

## DS413 | SLIDING WINDOW KEYED LATCH

<b>MATERIAL</b>	Polesium™
<b>FINISHES</b>	Moulded Black
<b>CYLINDER</b>	DS123 or DS124 or DS515 Cyl. Plug (non-Keyed)
<b>ORDER CODE</b>	MDS413

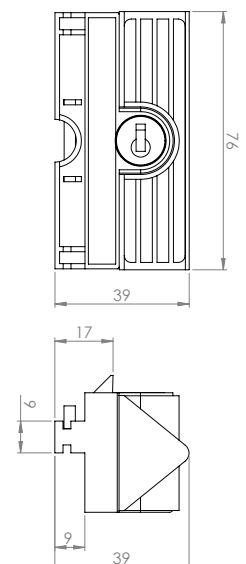
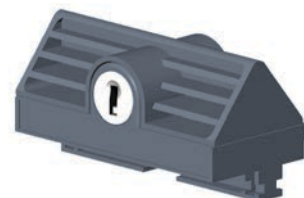

Universal OEM Chassis



## DS431 | SLIDING WINDOW KEYED LATCH

<b>MATERIAL</b>	Polesium™
<b>FINISHES</b>	Moulded Black
<b>ORDER CODE</b>	MDS431

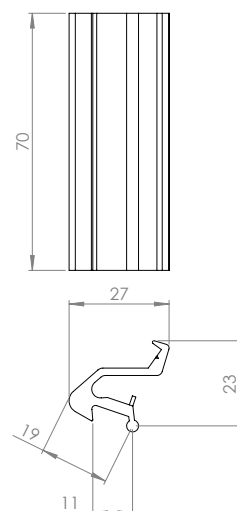

## DS440 | SLIDING WINDOW LATCH

<b>MATERIAL</b>	Polesium™
<b>FINISHES</b>	Moulded Black
<b>CYLINDER</b>	DS515 Cylinder Plug
<b>ORDER CODE</b>	MDS440

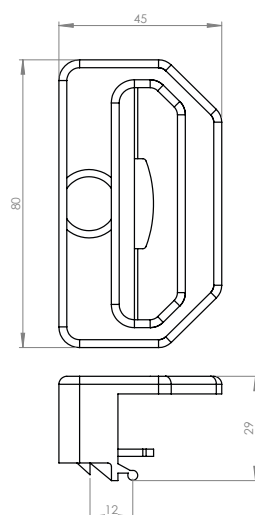

## DS455 | SLIDING WINDOW LATCH

<b>MATERIAL</b>	Polesium™
<b>FINISHES</b>	Moulded Black
<b>ORDER CODE</b>	9000401

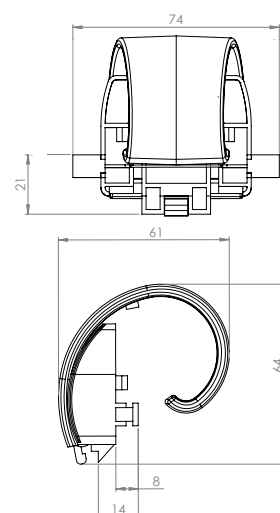
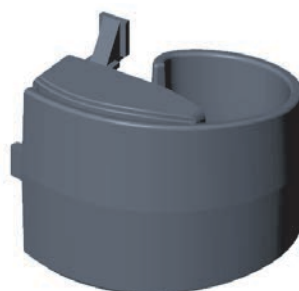

## DS457 | SLIDING WINDOW LATCH

<b>MATERIAL</b>	Polesium™
<b>FINISHES</b>	Moulded Black
<b>ORDER CODE</b>	MDS457

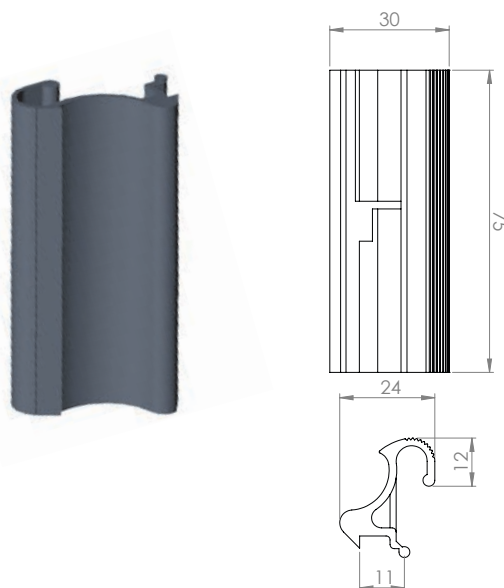

## DS460 | VENTLOCK

<b>MATERIAL</b>	Polesium™
<b>FINISHES</b>	Moulded Black
<b>FIXINGS</b>	Included: 2 x (5/32" x 38mm), 2 x (5/32" x 21mm)
<b>CYLINDER</b>	DS125 or DS126
<b>ORDER CODE</b>	MDS460

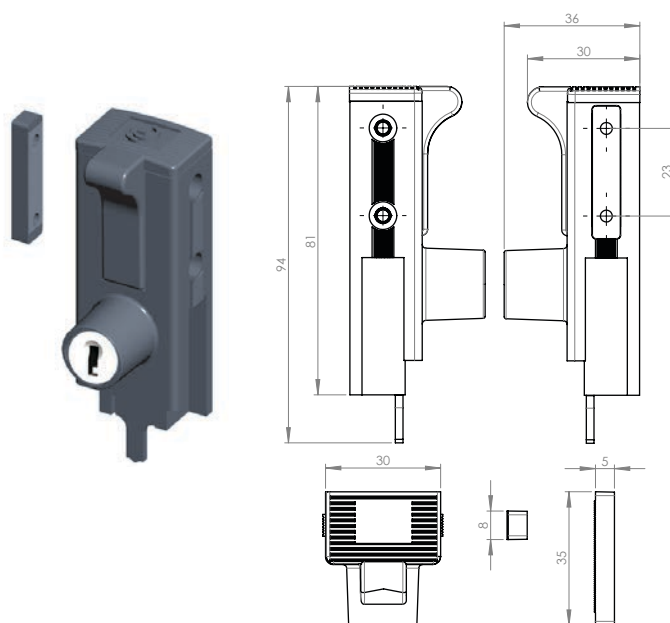

## DS513N | SLIDING WINDOW KEYED LATCH

<b>MATERIAL</b>	Polesium™
<b>FINISHES</b>	Moulded Black or Powder coat
<b>CYLINDER</b>	DS125 or DS126
<b>ORDER CODE</b>	MDS513

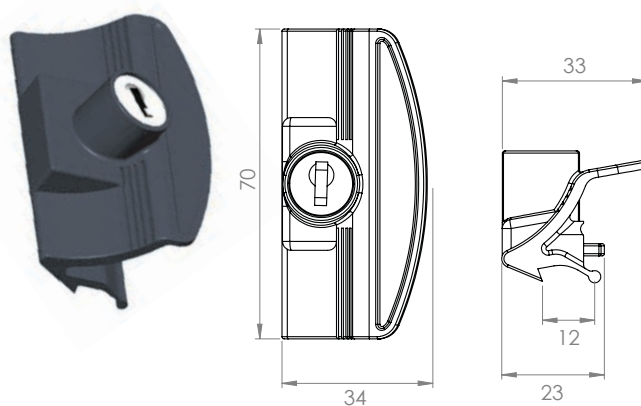

## DS520 | SLIDING WINDOW KEYED LATCH

<b>MATERIAL</b>	Polesium™
<b>FINISH</b>	Moulded Black
<b>CYLINDER</b>	DS125 or DS126 or DS515 Cyl. Plug (non-Keyed)
<b>ORDER CODE</b>	MDS520

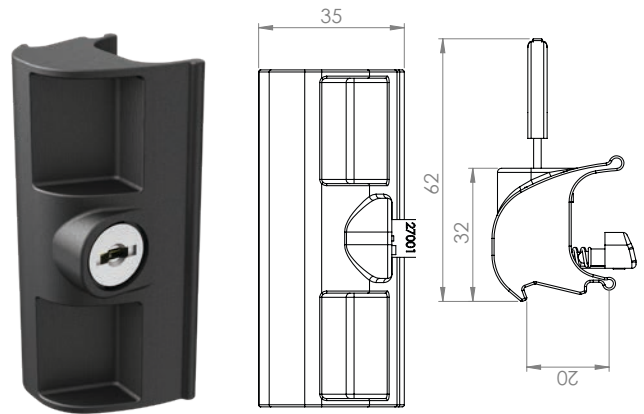

## DS521 | SLIDING WINDOW KEYED LATCH

<b>MATERIAL</b>	Polesium™
<b>FINISH</b>	Moulded Black or Powder coat
<b>CYLINDER</b>	DS125 or DS126 or DS515 Cylinder Plug
<b>ORDER CODE</b>	MDS521

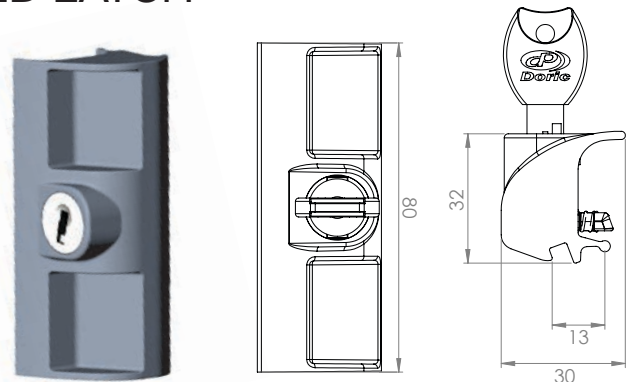

## DS190 | SLIDING WINDOW PRESSLOCK

<b>MATERIAL</b>	Metacom™
<b>FINISH</b>	Powder coat: Satin Black only
<b>FIXINGS</b>	Included
<b>CYLINDER</b>	DS125 or DS126
<b>ORDER CODE</b>	MDS190

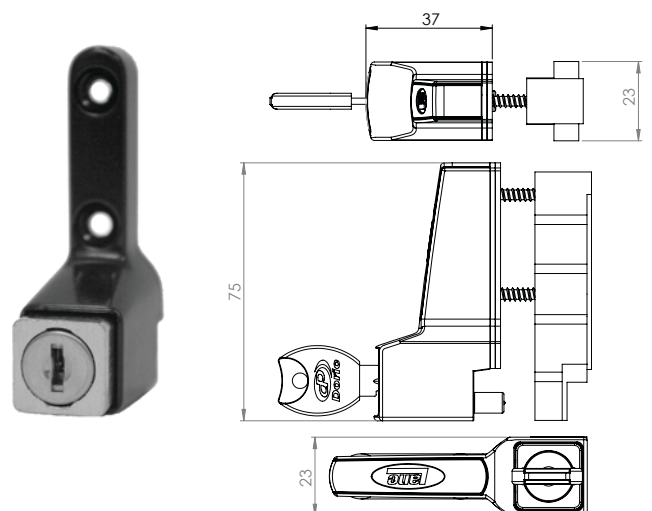

## DS237 | WINDOW PRESSLOCK & VENT KIT

<b>MATERIAL</b>	Zinc
<b>FINISH</b>	Powder coat: Satin Black only
<b>FIXINGS</b>	Included
<b>CYLINDER</b>	DS125 or DS126
<b>ORDER CODE</b>	MDS237

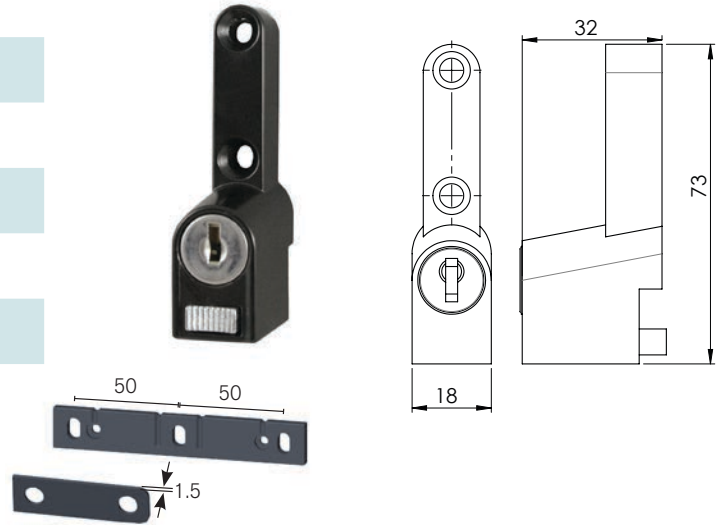

## DS709 | WINDOW LATCH

<b>MATERIAL</b>	ABS
<b>FINISH</b>	Moulded Black
<b>ORDER CODE</b>	9000426

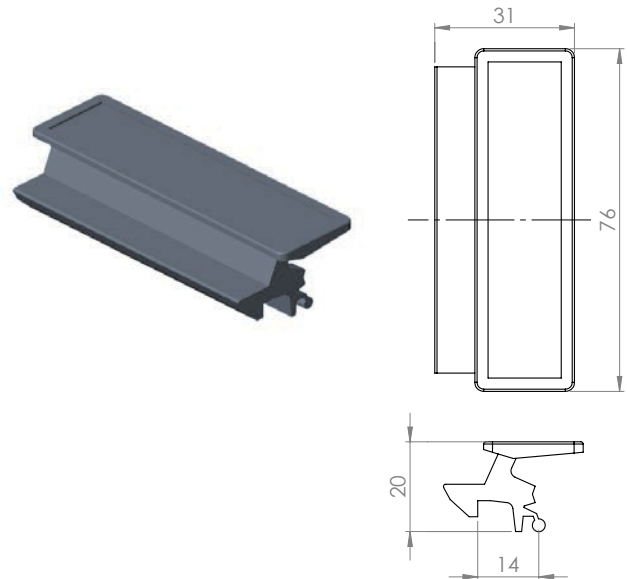

## DS1019 | ARCHER SLIMLINE SLIDING WINDOW SURFACE LOCK

<b>MATERIAL</b>	Polesium™
<b>FINISH</b>	Moulded Black or Powder coat
<b>CYLINDER</b>	DS123 or DS124 or DS515 Cylinder Plug
<b>ORDER CODE</b>	MDS1019
<b>PACKERS</b>	9052694 - 2mm Handle Packer

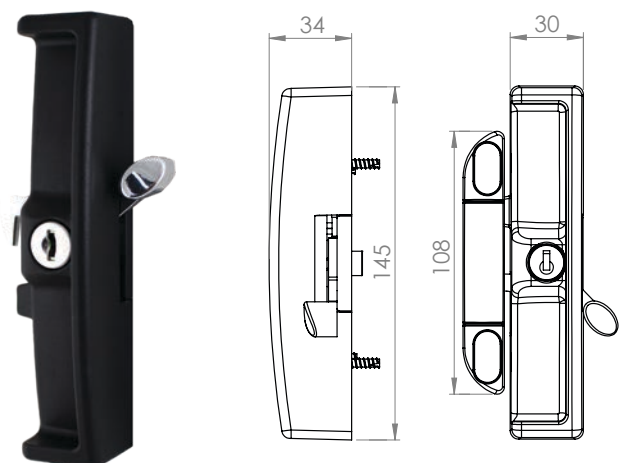

Chassis hole centres = 82mm  
Keeper hole centres = 78mm



## DS6001 | BARON SLIDING WINDOW SURFACE LOCK NON-KEYED

<b>MATERIAL</b>	Polesium™
<b>FINISH</b>	Moulded Black or Powder coat
<b>ORDER CODE</b>	MDS6001
<b>PACKERS</b>	9037904 - 4mm Handle Packer 9046714 - 2mm Handle Packer

Chassis hole centres = 82mm  
Keeper hole centres = 78mm

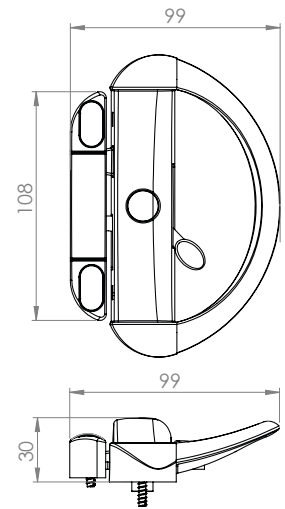

## DS6005 | SLIDING WINDOW SURFACE LOCK

<b>MATERIAL</b>	Aluminium body, plated steel pin
<b>FINISH</b>	Powder coat
<b>CYLINDER</b>	DS123 or DS124
<b>FIXINGS</b>	x2 6G screws (Included)
<b>ORDER CODE</b>	MDS6005

Chassis hole centres = 82mm  
Keeper hole centres = 74mm

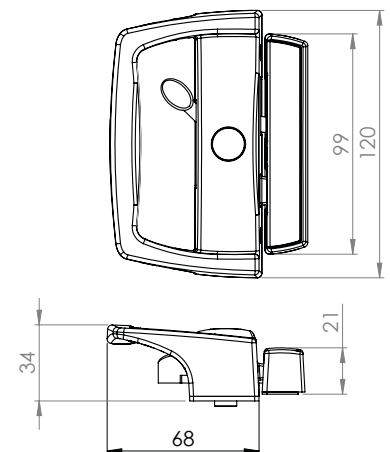

## DS6007 | SLIDING WINDOW SURFACE LATCH

<b>MATERIAL</b>	Aluminium body, plated steel pin
<b>FINISH</b>	Powder coat
<b>FIXINGS</b>	6G screws (Not included)
<b>ORDER CODE</b>	MDS6007

Chassis hole centres = 82mm  
Keeper hole centres = 74mm

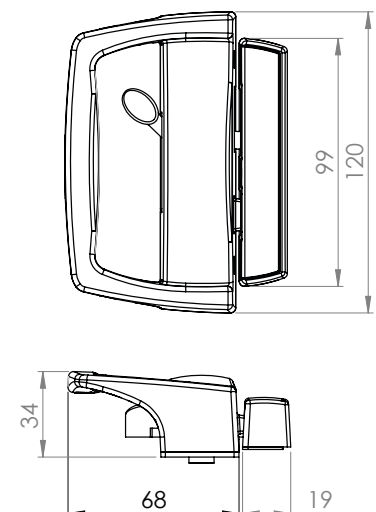

## DT4 | STERLING SLIDING WINDOW LOCK

<b>MATERIAL</b>	Zinc
<b>FINISH</b>	Satin Nickel or PVD or Powder coat
<b>KEEPER</b>	2 jamb fix & strike. (To suit bi-parting windows)
<b>ORDER CODE</b>	MDT4

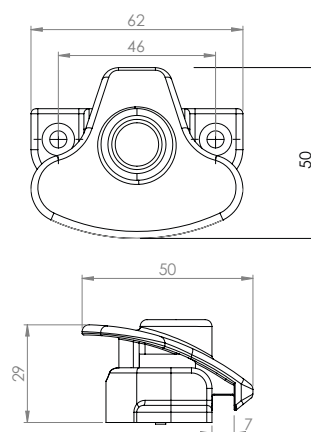

## DS323 | SLIDING WINDOW PRESSLOCK

<b>MATERIAL</b>	Zinc
<b>FINISH</b>	Satin Black
<b>CYLINDER</b>	DS125 or DS126
<b>FIXINGS</b>	6 x 10G x 51mm, 2 x 10/32 x 32mm (Included)
<b>ORDER CODE</b>	MDS323

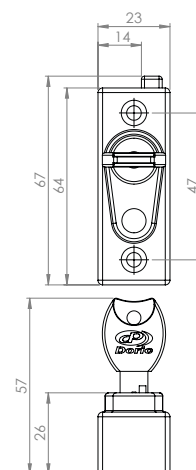

## DS329 | PINS

<b>MATERIAL</b>	Mild Steel
<b>FINISH</b>	Zinc Plated
<b>ORDER CODE</b>	DS329/67 - 9004126 DS329/75 - 9004127 DS329/101 - 9004128

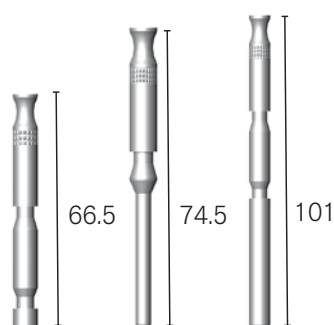

# SLIDING WINDOW | RESTRICTORS

## DS255 | SLIDING WINDOW RESTRICTOR

### ADVANTAGES

- Enables sliding windows to be restricted at a distance pre-determined by the installer
- Key lockable – for safe removal of the device
- Ability to be keyed alike to suit other Doric locking devices
- Easy to install

<b>MATERIAL</b>	Polesium™ with TPE pads
<b>FINISH</b>	Mill finish black
<b>CYLINDER</b>	DS125 or DS126
<b>FIXINGS</b>	2 x 6G x 12mm (Included)
<b>ORDER CODE</b>	MDS255

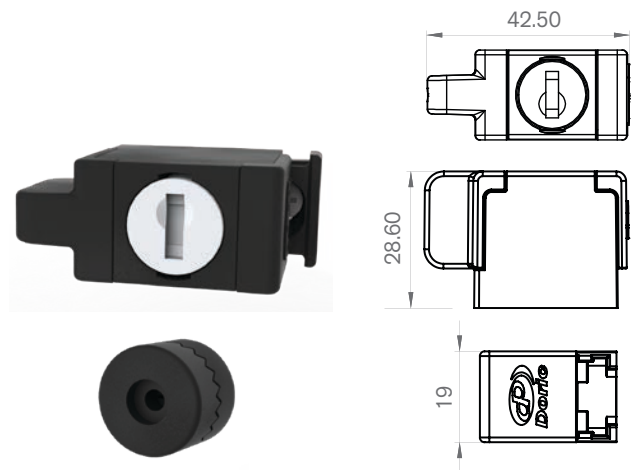

## DS255U | UNIVERSAL SLIDING WINDOW RESTRICTOR

### ADVANTAGES

- In built anti lift block
- Enables sliding windows to be restricted at a distance pre-determined by the installer
- Key lockable – For safe removal of the device
- Easy to install
- Suits Channel Width of 16.5mm or greater

<b>MATERIAL</b>	Polesium™
<b>FINISH</b>	Mill finish black
<b>CYLINDER</b>	DS125 or DS126
<b>FIXINGS</b>	2 x 6G x 12mm (Included)
<b>ORDER CODE</b>	MDS255U



# DOUBLE HUNG | WINDOW LOCKS & HARDWARE

## DS303 | DOUBLE HUNG CAM CATCH WITH SNIB

<b>MATERIAL</b>	Zinc
<b>FINISH</b>	Powder coat
<b>FIXINGS</b>	8G screws (Not included)
<b>ORDER CODE</b>	MDS303
<b>KEEPER</b>	DS416, DS417, DS418, DS419, DS420, DS421, DS422, DS423, DS424 or DS425

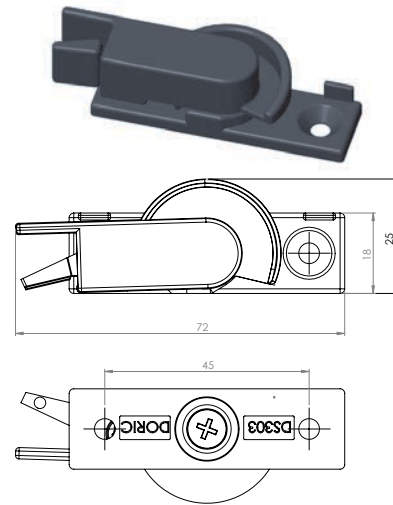

## DS315 | DOUBLE HUNG CAM PRESS SASH LOCK

<b>MATERIAL</b>	Zinc
<b>FINISH</b>	Powder coat
<b>FIXINGS</b>	2 x 8G x 12mm screws (Included)
<b>CYLINDER</b>	DS125 or DS126
<b>ORDER CODE</b>	MDS315
<b>KEEPER</b>	DS416, DS417, DS418, DS419, DS420, DS421, DS422, DS423, DS424 or DS425

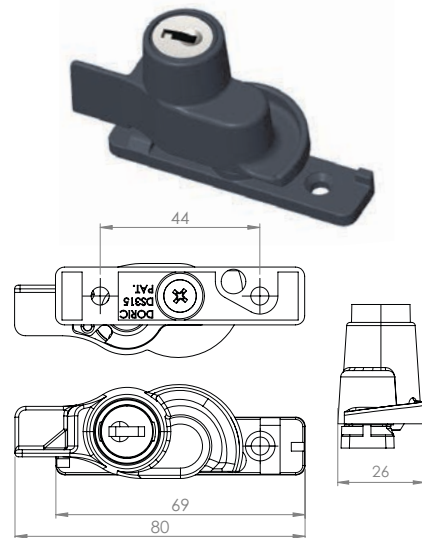

## DS324 | DOUBLE HUNG CAM SASH LOCK

<b>MATERIAL</b>	Zinc
<b>FINISH</b>	Powder coat
<b>FIXINGS</b>	2 x 8G x 12mm screws (Included)
<b>CYLINDER</b>	DS123 or DS124
<b>ORDER CODE</b>	MDS324
<b>KEEPER</b>	DS416, DS417, DS418, DS419, DS420, DS421, DS422, DS423, DS424 or DS425

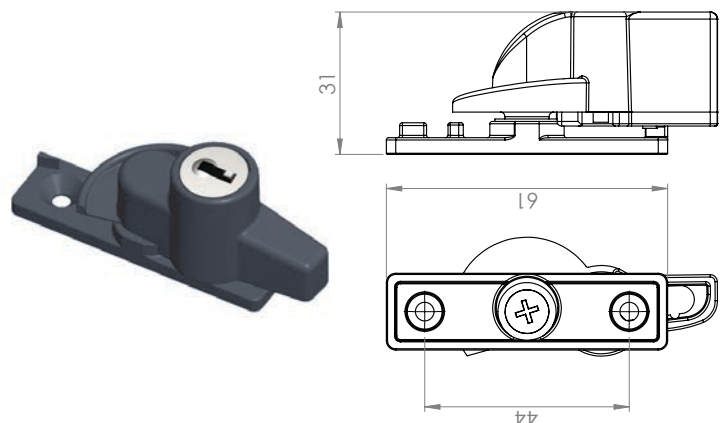

## DS444 | DOUBLE HUNG CAM SASH LOCK

<b>MATERIAL</b>	Zinc
<b>FINISH</b>	Powder coat
<b>FIXINGS</b>	2 x 8G x 12mm screws (Included)
<b>CYLINDER</b>	DS123 or DS124
<b>ORDER CODE</b>	MDS444
<b>KEEPER</b>	DS411, DS414, DS416, DS420, DS421 or DS425

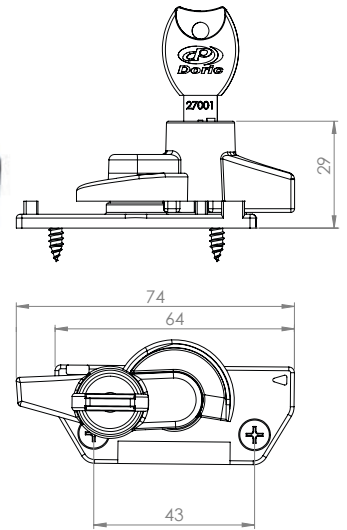
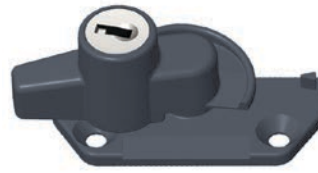

## DS452 | DOUBLE HUNG CAM SASH LOCK

<b>MATERIAL</b>	Aluminium
<b>FINISH</b>	Powder coat
<b>FIXINGS</b>	Not included
<b>CYLINDER</b>	DS125 or DS126
<b>ORDER CODE</b>	MDS452

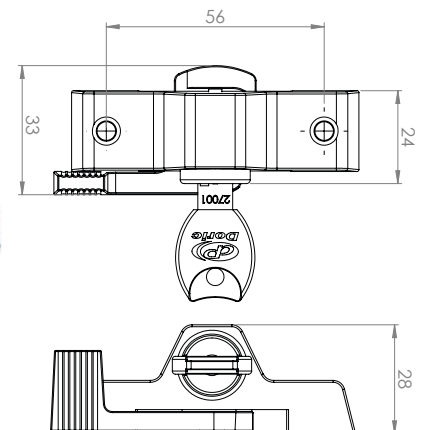

## DT1 | STERLING DOUBLE HUNG SASH LOCK

<b>MATERIAL</b>	Zinc
<b>FINISH</b>	Satin nickel, PVD, or Powder coat
<b>FIXINGS</b>	8G (Not included)
<b>CYLINDER</b>	DS125
<b>ORDER CODE</b>	MDT1
<b>KEEPER</b>	DS416 or DS421

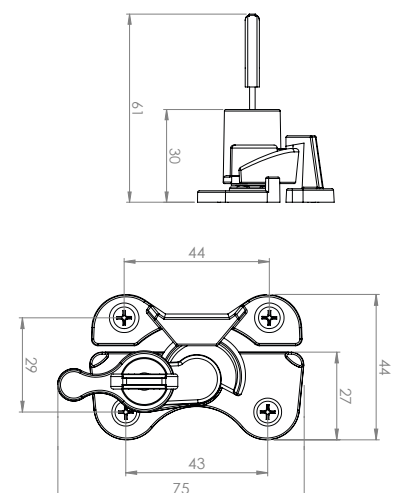



## DS576 | CONCEALED WEDGE DOUBLE HUNG LOCK

Bespoke attractive design combines with functional purpose. The DS576 Concealed Wedge Lock for sash windows provides function, style.

<b>MATERIAL</b>	Aluminium
<b>FINISH</b>	Powder coat
<b>CYLINDER</b>	DS125 or DS126
<b>FIXINGS</b>	8G Screws (included)
<b>ORDER CODE</b>	MDS576PC
<b>KEEPER</b>	Included

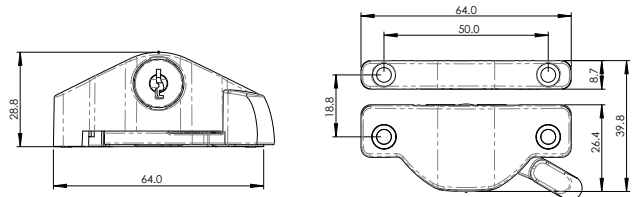

## DS577 | CONCEALED WEDGE DOUBLE HUNG LATCH

The low profile non-keyed version of the DS576, the DS577 Concealed Wedge Latch for sash windows provides function, style.

<b>MATERIAL</b>	Aluminium
<b>FINISH</b>	Powder coat
<b>FIXINGS</b>	8G Screws (included)
<b>ORDER CODE</b>	MDS577PC
<b>KEEPER</b>	Included

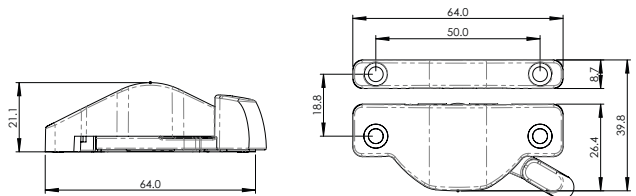

## DS416 | DOUBLE HUNG KEEPER

<b>MATERIAL</b>	Zinc
<b>FINISH</b>	Powder coat
<b>FIXINGS</b>	8G screws (Not included)
<b>ORDER CODE</b>	MDS416
<b>SUITS</b>	DS303, DS315, DS324, DS444, DT1

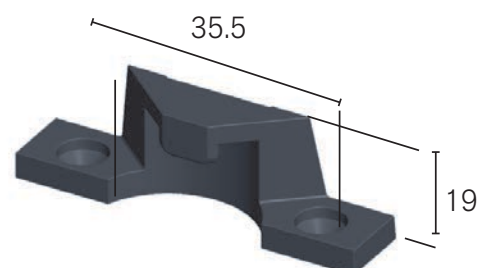

## DS417 | DOUBLE HUNG KEEPER

<b>MATERIAL</b>	1.2mm Stainless steel
<b>FINISH</b>	Mill Finish
<b>FIXINGS</b>	8G screws (Not included)
<b>ORDER CODE</b>	9000364
<b>SUITS</b>	DS303, DS315, DS324

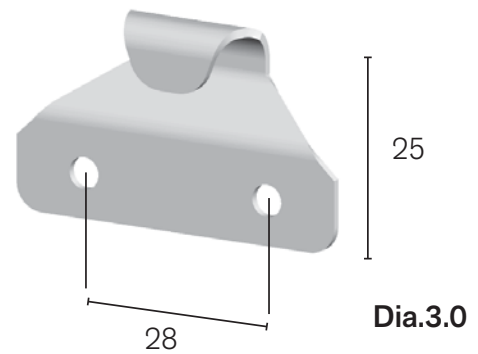

## DS418 | DOUBLE HUNG KEEPER

<b>MATERIAL</b>	1.2mm Stainless steel
<b>FINISH</b>	Mill Finish
<b>FIXINGS</b>	8G screws (Not included)
<b>ORDER CODE</b>	9000365
<b>SUITS</b>	DS303, DS315, DS324

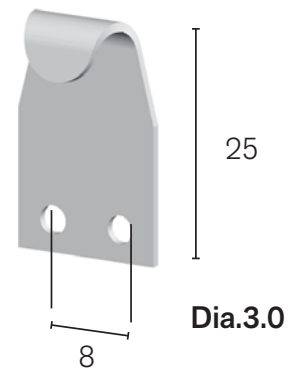

## DS420 | DOUBLE HUNG KEEPER

<b>MATERIAL</b>	1.2mm Stainless steel
<b>FINISH</b>	Mill Finish
<b>FIXINGS</b>	8G screws (Not included)
<b>ORDER CODE</b>	9000367
<b>SUITS</b>	DS303, DS315, DS324, DS444

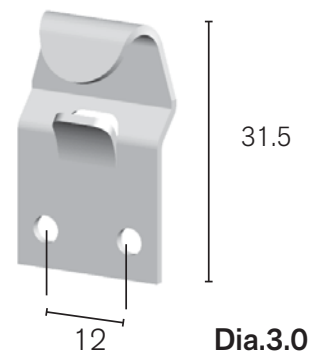

## DS421 | DOUBLE HUNG KEEPER

<b>MATERIAL</b>	Zinc
<b>FINISH</b>	Powder coat (Standard colours only)
<b>FIXINGS</b>	8G screws (Not included)
<b>ORDER CODE</b>	MDS421
<b>SUITS</b>	DS303, DS315, DS324, DS444, DT1

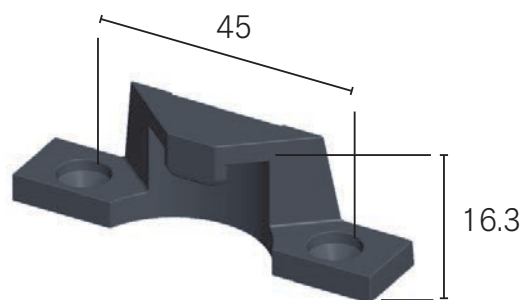

## DS422 | DOUBLE HUNG KEEPER

<b>MATERIAL</b>	1.2mm Stainless steel
<b>FINISH</b>	Mill Finish
<b>FIXINGS</b>	8G screws (Not included)
<b>ORDER CODE</b>	9000369
<b>SUITS</b>	DS303, DS315, DS324

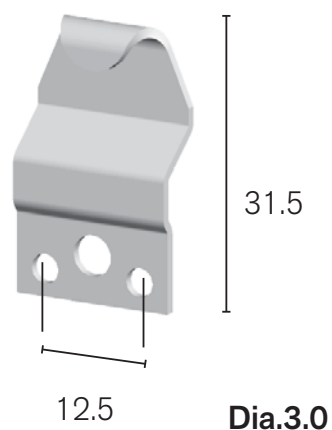

## DS425 | DOUBLE HUNG KEEPER

<b>MATERIAL</b>	1.2mm Stainless steel
<b>FINISH</b>	Mill Finish
<b>FIXINGS</b>	8G screws (Not included)
<b>ORDER CODE</b>	9000372
<b>SUITS</b>	DS303, DS315, DS324, DS444

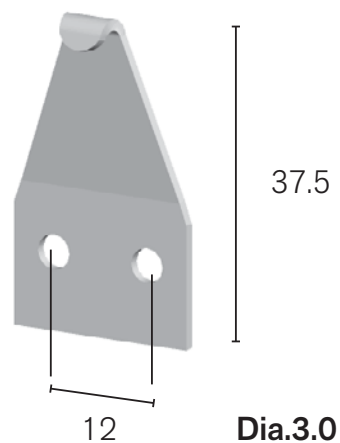

## DS325 | SASH LIFT

<b>MATERIAL</b>	Zinc
<b>FINISH</b>	Powder coat
<b>FIXINGS</b>	8G screws (Not included)
<b>ORDER CODE</b>	MDS325

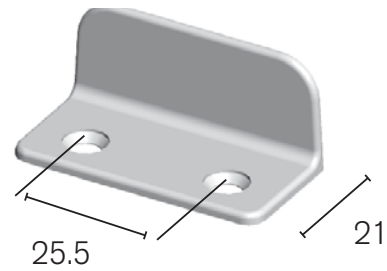

## DT2 | STERLING SASH LIFT (SET OF 2)

<b>APPLICATION</b>	Suits timber double hung windows
<b>MATERIAL</b>	Stainless steel
<b>FINISH</b>	Mill Finish
<b>FIXINGS</b>	8G screws (Not included)
<b>ORDER CODE</b>	MDT2



## DS347 | JOCKEY CAP

<b>MATERIAL</b>	Polyamide
<b>FINISH</b>	Mill Finish
<b>FIXINGS</b>	5/32" screw (Not included)
<b>ORDER CODE</b>	9000283

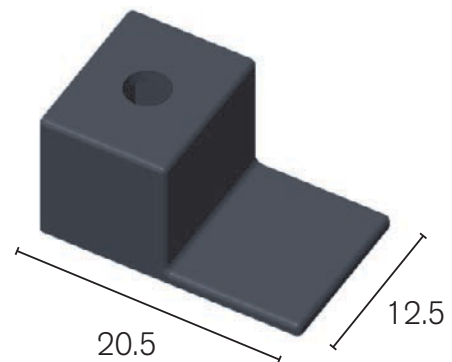

## DS259 | DOUBLE HUNG RESTRICTOR

<b>MATERIAL</b>	Polesium™
<b>FINISH</b>	Moulded Black
<b>CYLINDER</b>	DS125 or DS126
<b>FIXINGS</b>	6 x 6G x 12mm (Included)
<b>ORDER CODE</b>	MDS259

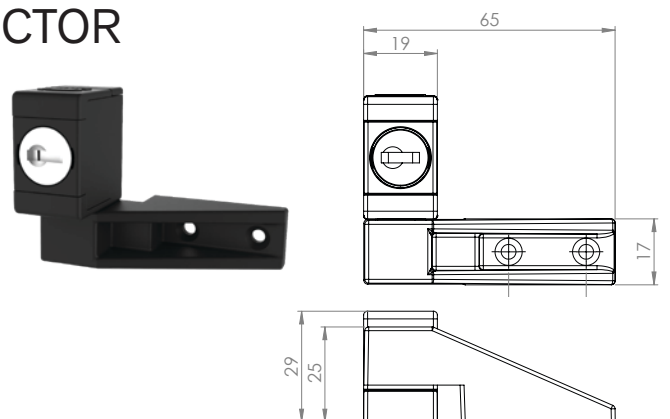

# FLYSCREEN | HARDWARE & ACCESSORIES

## DS120 | FLYSCREEN LIFT TAB

<b>APPLICATION</b>	Suits 25mm x 11mm flyscreen frame for windows
<b>MATERIAL</b>	Polypropylene
<b>FINISH</b>	Moulded black
<b>ORDER CODE</b>	9000084

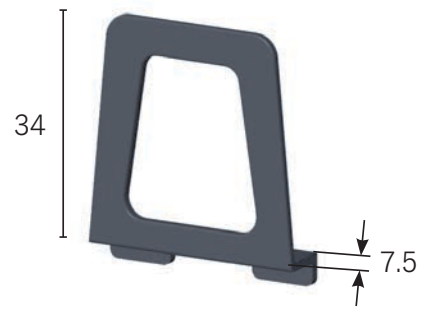

## DS121 | FLYSCREEN LIFT TAB

<b>APPLICATION</b>	Suits 22mm x 9mm flyscreen frame for windows
<b>MATERIAL</b>	Polypropylene
<b>FINISH</b>	Moulded black
<b>ORDER CODE</b>	9000085

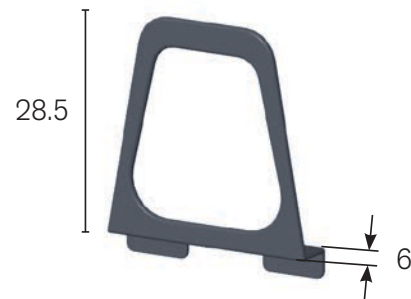

## DS132 | FLYSCREEN SPRING CLIP

<b>APPLICATION</b>	Suits 22mm x 9mm flyscreen frame for windows
<b>MATERIAL</b>	Acetal
<b>FINISH</b>	Moulded black
<b>ORDER CODE</b>	9000097

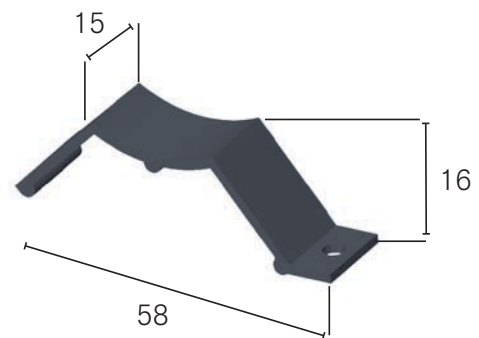

## DS144 | FLYSCREEN SPRING

<b>APPLICATION</b>	Acetal natural (w/ - black master batch)
<b>MATERIAL</b>	Acetal
<b>FINISH</b>	Moulded black
<b>ORDER CODE</b>	9000109

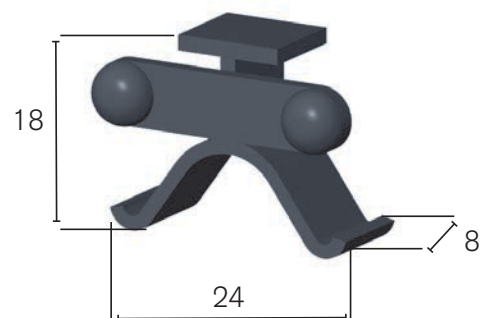



## DS158 | FLYSCREEN CLIP - \*4mm

<b>MATERIAL</b>	Polyamide or Acrylic
<b>FINISH</b>	Clear or Black
<b>ORDER CODE</b>	Clear - 9025470 Black - 9000123

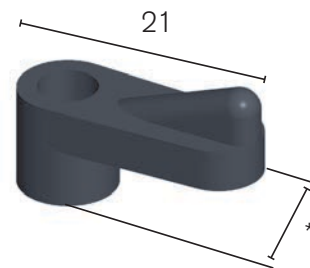

## DS162 | FLYSCREEN SPRING LOADED CLIP

<b>MATERIAL</b>	Polyamide with Steel Spring
<b>FINISH</b>	Moulded black
<b>ORDER CODE</b>	9000127

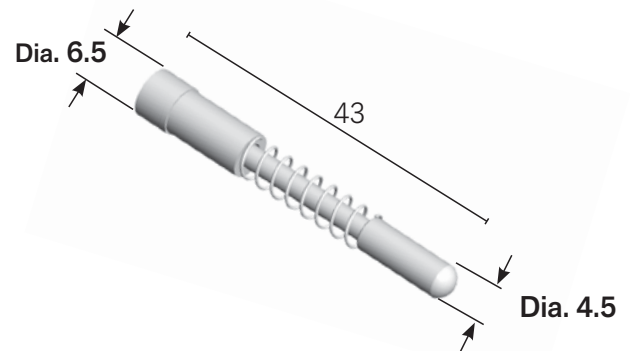

## DS337 | FLYSCREEN CLIP

<b>MATERIAL</b>	Polyamide
<b>FINISH</b>	Moulded black
<b>ORDER CODE</b>	9000273

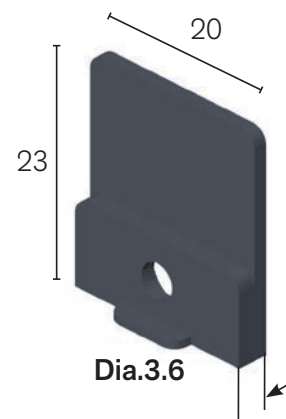

## DS372 | FLYSCREEN CORNER STAKE

<b>APPLICATION</b>	Suits 25mm x 11mm flyscreen frame for windows
<b>MATERIAL</b>	High Impact Polystyrene
<b>FINISH</b>	Moulded black
<b>ORDER CODE</b>	9000308

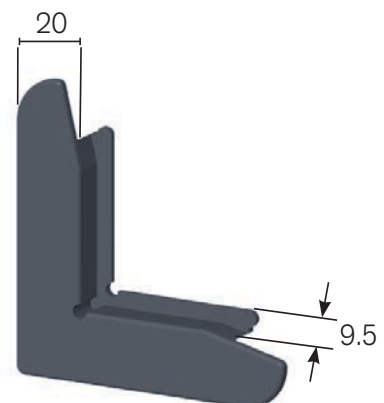

## ACCESSORIES | WINDOW HARDWARE

### DS348 | FLAT SPACER BUTTON

<b>MATERIAL</b>	High impact Polystyrene
<b>FINISH</b>	Moulded black
<b>ORDER CODE</b>	9000284



### DS350 | BLANKING GROMMET

<b>MATERIAL</b>	Polyamide
<b>FINISH</b>	Moulded black
<b>ORDER CODE</b>	9000286



### DS377 | SPACER BUTTON

<b>MATERIAL</b>	Polyamide
<b>FINISH</b>	Moulded black
<b>ORDER CODE</b>	9000313



### DS470 | ANTI-LIFT BLOCK & FERRULE

<b>APPLICATION</b>	Suits all ventlocks
<b>MATERIAL</b>	Polesium™
<b>FINISH</b>	Mill Finish Black
<b>FIXINGS</b>	Included
<b>ORDER CODE</b>	9003086



### DN24 | RIDE UP BLOCK

<b>APPLICATION</b>	Pivot, awning & casement windows
<b>MATERIAL</b>	Polyamide
<b>FINISH</b>	Moulded Black
<b>FIXINGS</b>	8G screws (Not included)
<b>ORDER CODE</b>	9001423

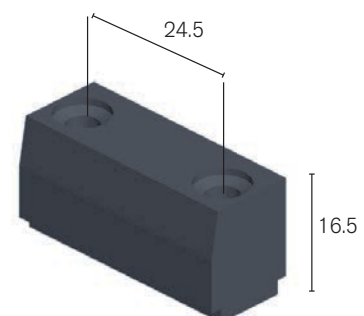

## PUBLIC WORKS | WINDOW HARDWARE

### DN5 | PLUNGER LOCK (PARALLEL)

<b>MATERIAL</b>	Polesium™ housing, Zinc rod pin
<b>FINISH</b>	Mill Finish
<b>FIXINGS</b>	6G screws (Not included)
<b>ORDER CODE</b>	9001404

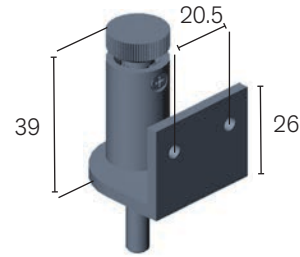

### DN6 | PLUNGER LOCK (PERPENDICULAR)

<b>MATERIAL</b>	Polesium™ housing, Zinc rod pin
<b>FINISH</b>	Mill Finish
<b>FIXINGS</b>	6G screws (Not included)
<b>ORDER CODE</b>	9001405

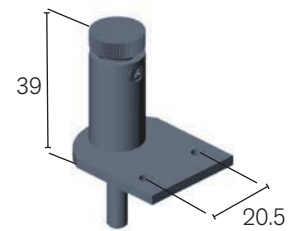

### DN12 | BUDGET LOCK

<b>MATERIAL</b>	Zinc
<b>FINISH</b>	Bright zinc plated
<b>FIXINGS</b>	8G screws (Not included)
<b>KEY</b>	DN13
<b>ORDER CODE</b>	9001411

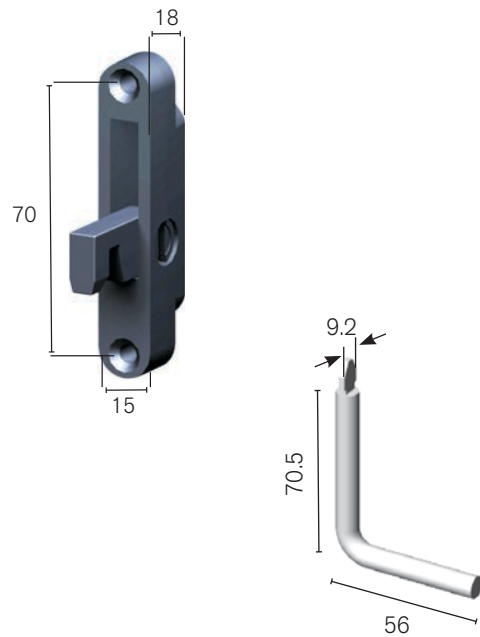

### DN13 | BUDGET LOCK KEY

<b>APPLICATION</b>	Suits DN12
<b>MATERIAL</b>	Steel
<b>ORDER CODE</b>	9001412

### DF9 | AWNING HANDLE RH

<b>MATERIAL</b>	Metacom™
<b>FINISH</b>	Powder coat
<b>FIXINGS</b>	8G screws (not included)
<b>KEEPER</b>	DF11
<b>ORDER CODE</b>	Black - 9042031 Silver - 9030359

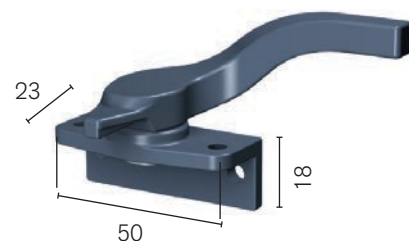

# INDEX

9049270   Chainwinder 3mm Bracket	14	DS323   Sliding Window Presslock	30
DF9   Awning Handle (RH)	41	DS324   Double Hung Cam Sash Lock	32
DN12   Budget Lock	41	DS325   Sash Lift	37
DN13   Budget Lock Key	41	DS329   Pins	30
DN24   Ride Up Block	40	DS332   Sliding Window Latch	20
DN400   Twin Chainwinder	8	DS337   Flyscreen Clip	39
DN450   MKII Twin Chainwinder	10	DS347   Jockey Cap	37
DN5   Plunger Lock (Parallel)	41	DS348   Flat Spacer Button	40
DN560   Mortice Sliding Window Lock	18	DS350   Blanking Grommet	40
DN6   Plunger Lock (Perpendicular)	41	DS371U   Universal Sliding Window Keyed Latch	20
DS1   Chainwinder	4	DS372   Flyscreen Corner Stake	39
DS1 SAL   Special Access Lever Chainwinder	6	DS377   Spacer Button	40
DS1019   Archer Slimline Sliding Window Surface Lock	28	DS385   Sliding Window Latch	21
DS1176   Chainwinder 20mm Bracket	14	DS400   Sliding Window Keyed Latch	21
DS120   Flyscreen Lift Tab	38	DS401   Sliding Window Keyed Latch	22
DS121   Flyscreen Lift Tab	38	DS403   Sliding Window Keyed Latch	22
DS132   Flyscreen Spring Clip	38	DS404N   Sliding Window Keyed Latch	22
DS144   Flyscreen Spring	38	DS406   Sliding Window Keyed Latch	23
DS158   Flyscreen Clip - *4mm	39	DS407   Sliding Window Keyed Latch	23
DS162   Flyscreen Spring Loaded Clip	39	DS408   Sliding Window Keyed Latch	23
DS174N   Chainwinder 8mm Bracket	14	DS409   Sliding Window Keyed Latch	24
DS190   Sliding Window Presslock	27	DS412   Sliding Window Keyed Latch	24
DS237   Window Presslock & Vent Kit	28	DS413   Sliding Window Keyed Latch	24
DS255   Sliding Window Restrictor	31	DS416   Double Hung Keeper	34
DS255U   Universal Sliding Window Restrictor	31	DS417   Double Hung Keeper	35
DS259   Double Hung Restrictor	37	DS418   Double Hung Keeper	35
DS303   Double Hung Cam Catch With Snib	32	DS420   Double Hung Keeper	35
DS315   Double Hung Cam Press Sash Lock	32	DS421   Double Hung Keeper	36





# INNOVATORS

OF HARDWARE FOR WINDOWS AND DOORS

---

Window Lock Catalogue .v1.3-01.04.2024

## SYDNEY

38 Redfern St,  
Wetherill Park  
Sydney, NSW 2164  
Australia  
Ph: +61 2 9609 2555  
[www.doric.com.au](http://www.doric.com.au)

## AUCKLAND

26/C Triton Drive,  
Albany, North Shore,  
Auckland 0632  
New Zealand  
Ph: +64 9 415 5535  
[www.doric.co.nz](http://www.doric.co.nz)

## KUALA LUMPUR

Unit 6, Level 4, SetiaWalk Mall (*Block K*),  
SetiaWalk, Persiaran Wawasan,  
Pusat Bandar Puchong,  
47160 Puchong, Selangor, Malaysia  
Ph: +603 8602 2100  
[www.doric.com.my](http://www.doric.com.my)



---

# WINDOW

LOCKS, LATCHES  
& ACCESSORIES